

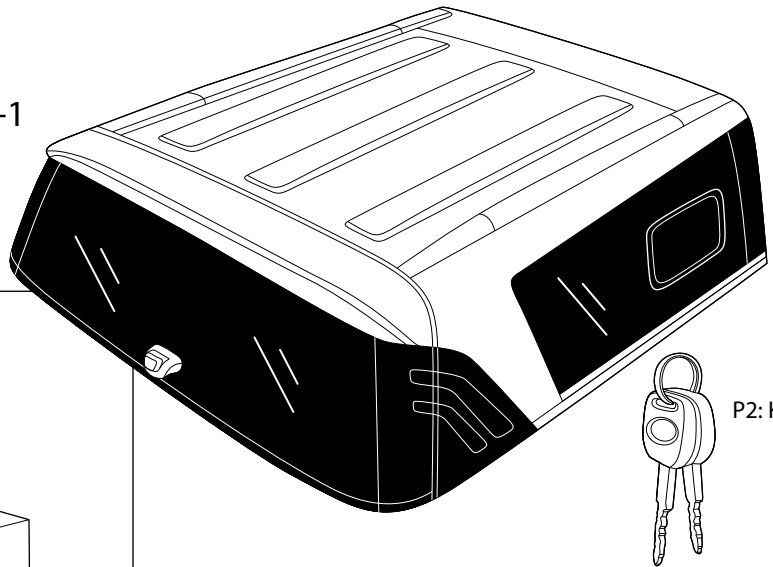

Mechanical Installation Manual Steel Canopy : TL-1 All Models Version 1.0

Part In Main Carton

P1: Steel Canopy TL-1



P2: Key

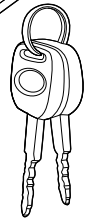

Kit Box

Part List Paper

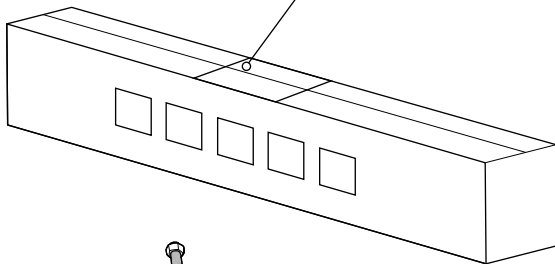

K1 : C-Clamp

x4 (D-Cab)
x6 (C-Cab)

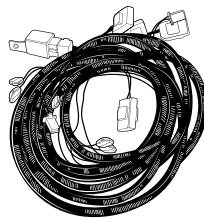

K3 : Wiring No.38



K8 : T Paint

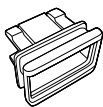

K2 : Switch Case

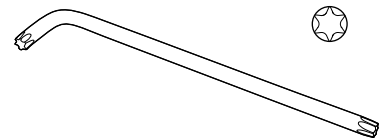

T6 : Hexalobular Wrench # T40

Require Tools



T1 : 13 mm. Wrench

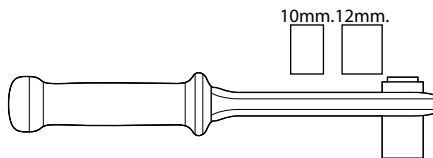

T3 : 10,12mm. Torque Wrench

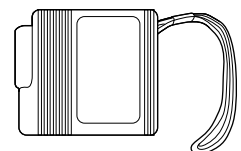

T7 : Measuring Tape/Ruler



T2 : 10 mm. Wrench

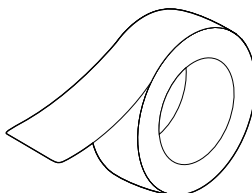

T4 : Tape

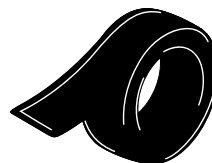

T5 : Electric Tape

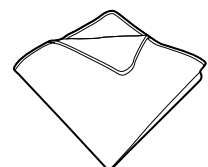

T8 : Fabric



1

The Procedure of checking the Sammitr canopy box before installation.

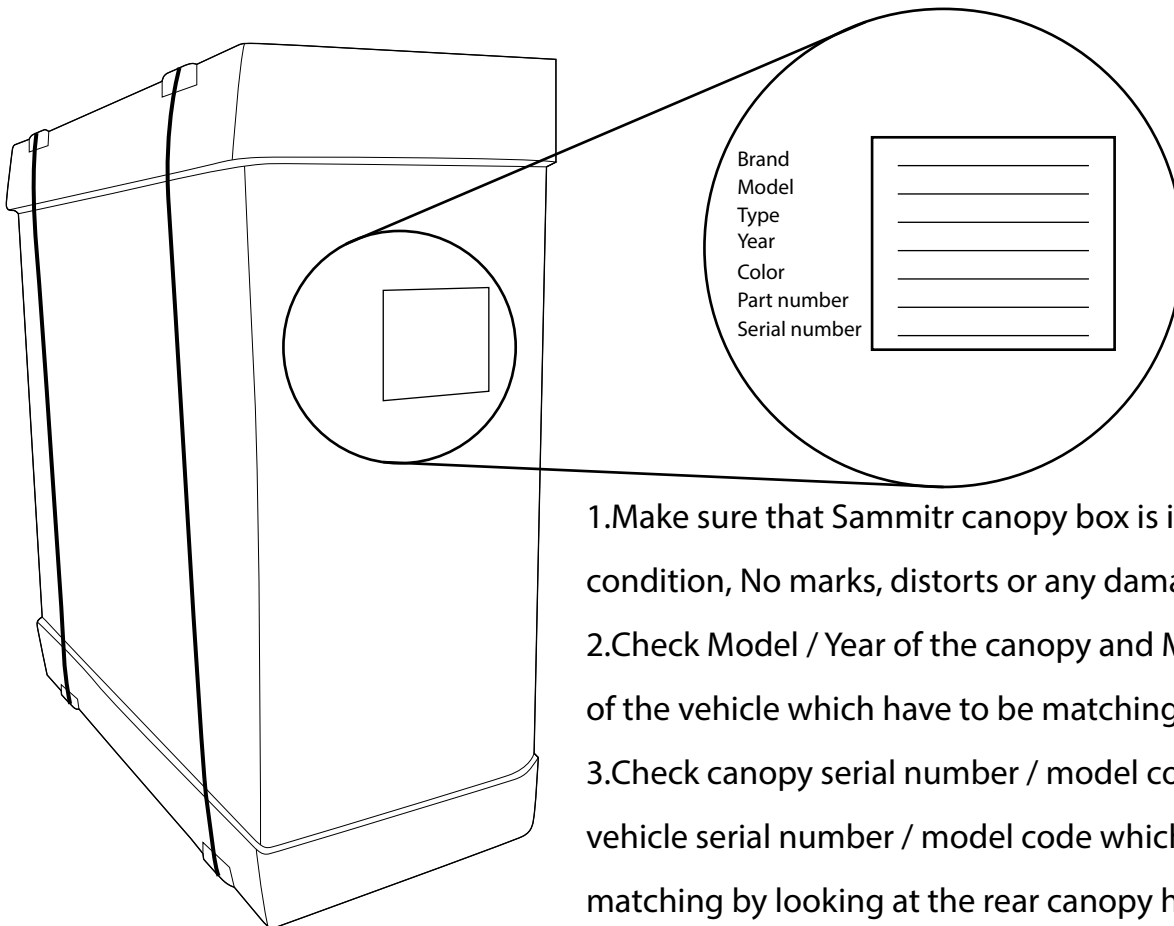

4. Check all the accessories received inside the box with the Packing List.

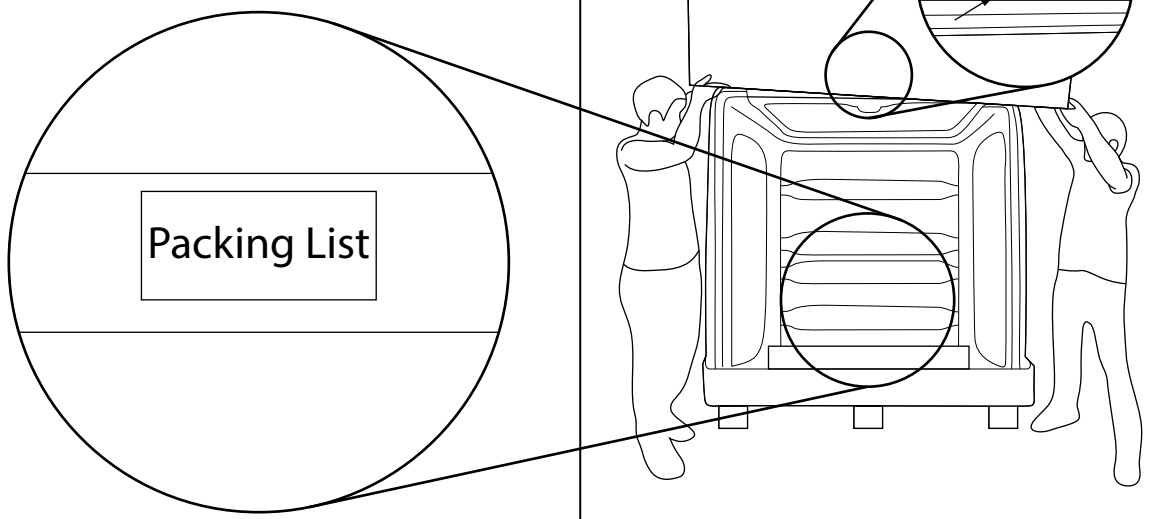



2 The preparation process of Sammitr Canopy TL-1 model before installation with the vehicle.

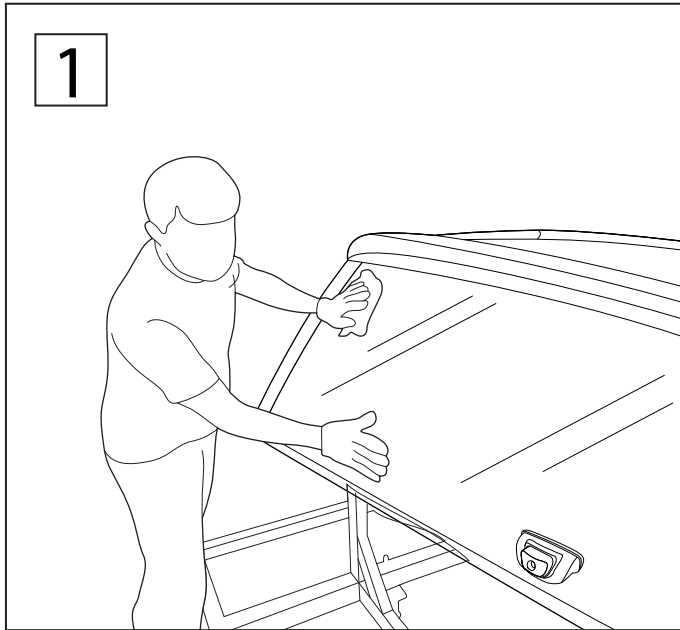

1. Canopy have to be in good condition, no damage, dent, cracks, smooth surface including no window damages or cracks.
2. Locking system is working for both keys.
3. Canopy sides are not damage, dent or cracks.
4. Canopy front window panel is working (open/close), no cracks or damages occurrences.
5. Check the Rear Door by open and close.

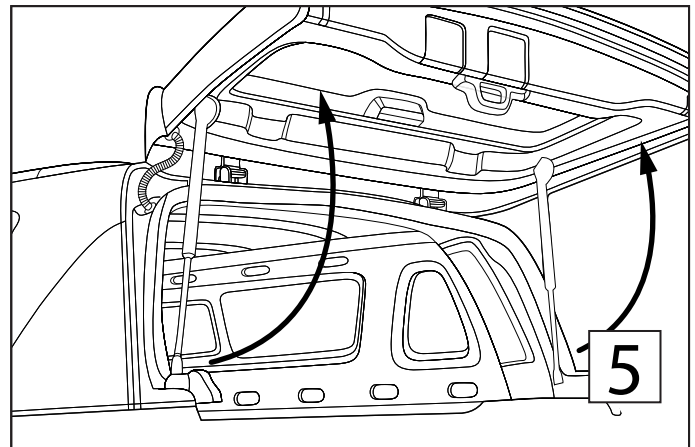
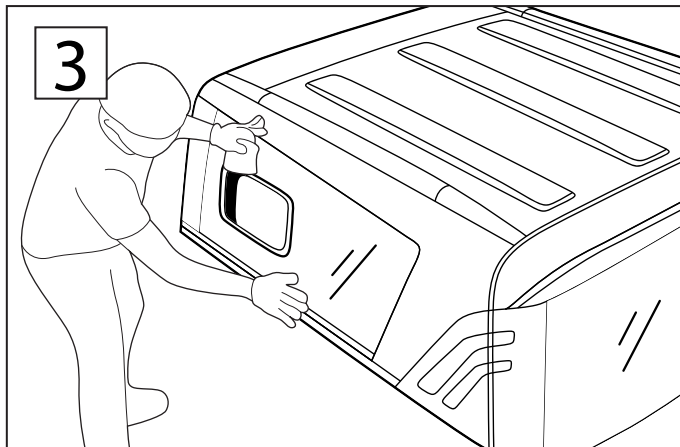
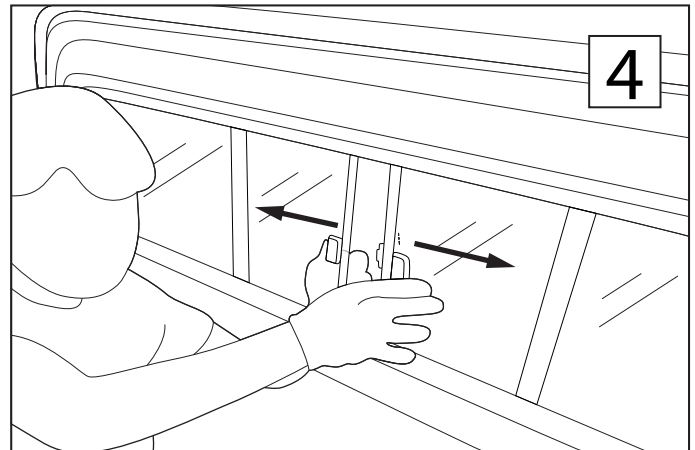
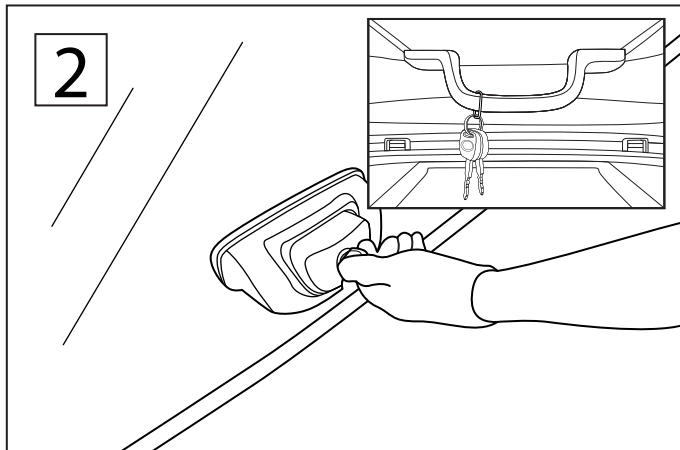

3

Checking/Preparation Procedures of Isuzu D-Max 2020 before installation

1. Clean the entire car body, including the top of the car, the sides of the rear bed, and the rear bed cover.
2. Cover with a cloth to prevent impact and scratches.

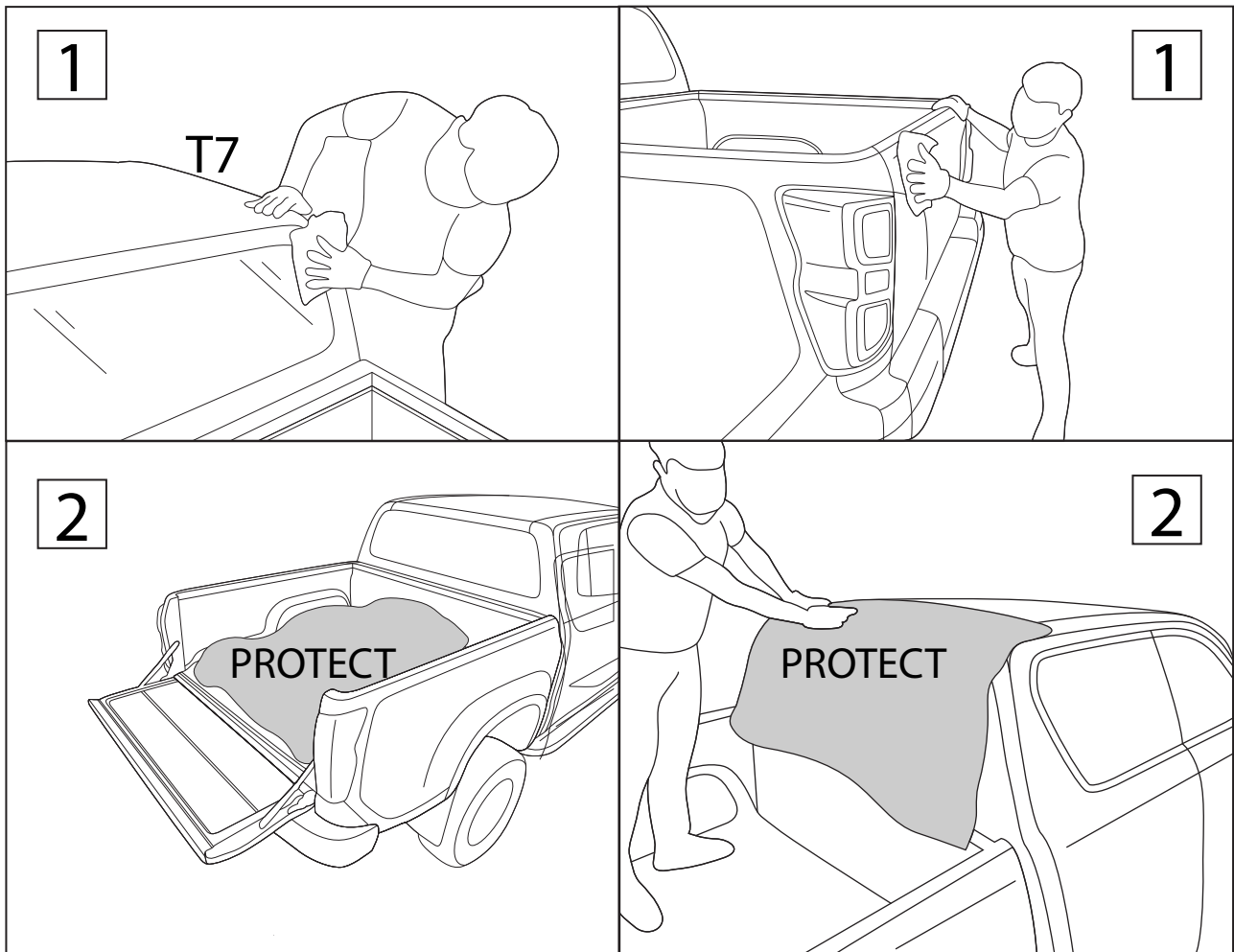



SAMMITR

6

The process of preparing Sammitr Canopy TL-1 model before install on the vehicle.

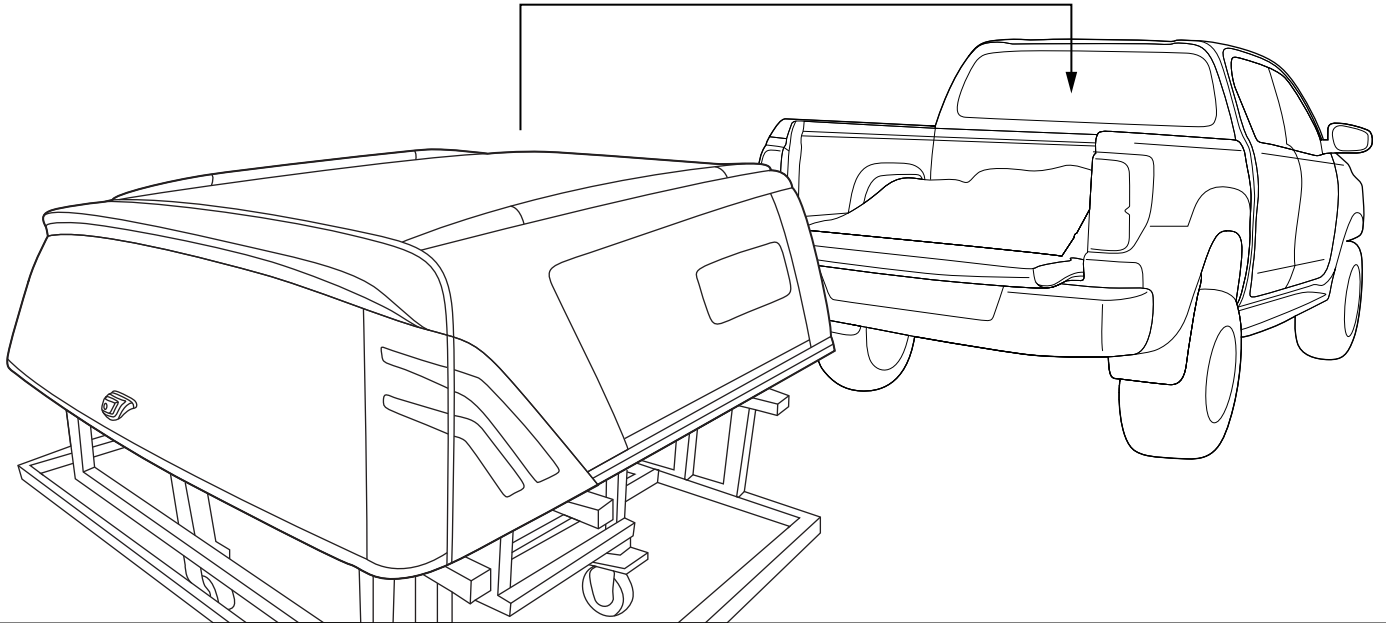

7

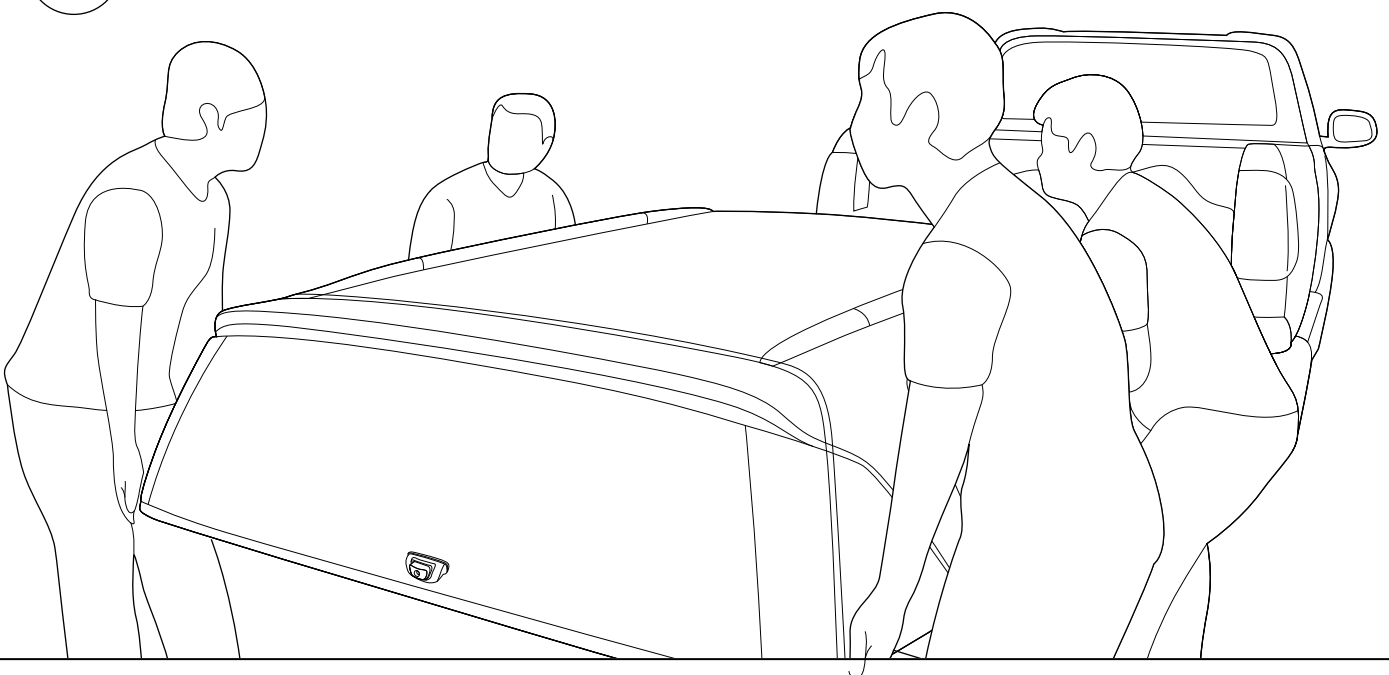

The process of lifting the canopy onto the vehicle tub by using 4 people for lifting.



8

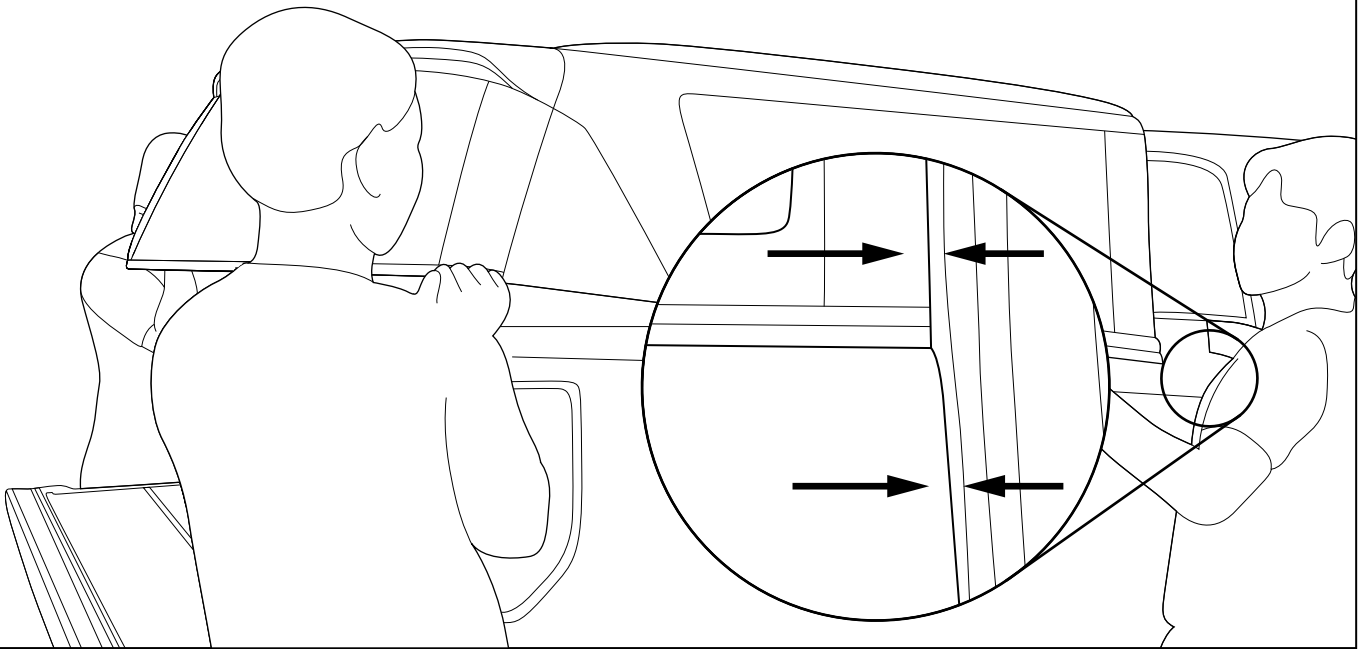

Lift canopy over the pick up truck by rising the rear part higher and the front part to be in the parallel with the edge of the vehicle tub.

9

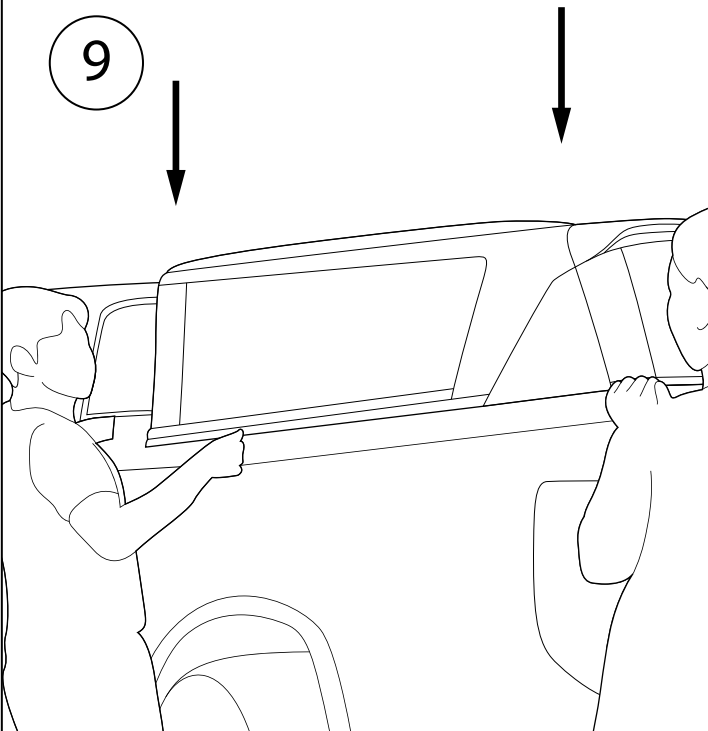

After get the distance in front part and then put the rear part to cover the vehicle tub.

10

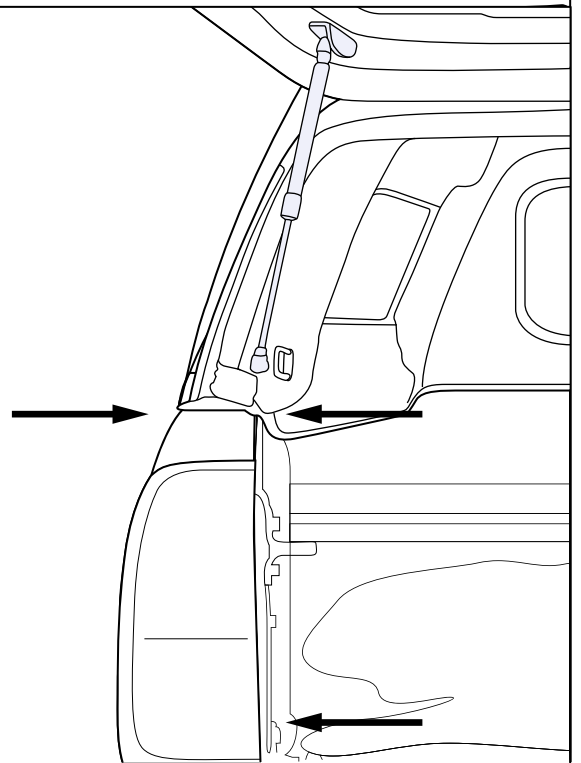

Make sure the distance between canopy edge and vehicle rear tub are equivalent both left and right sides.



Unit of mm.

11

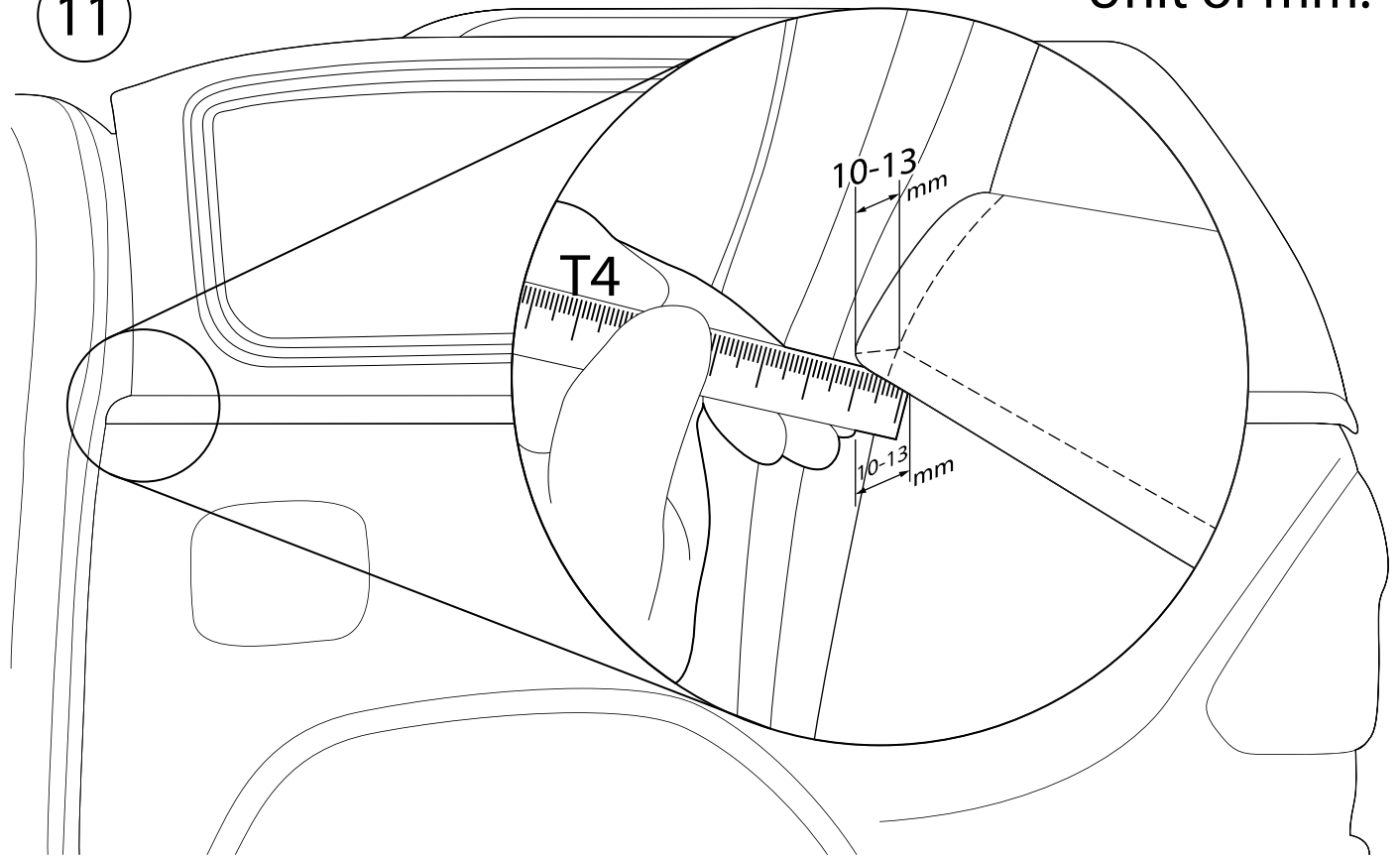

Side edge of canopy to be in the parallel with the Side edge of the vehicle tub.

12

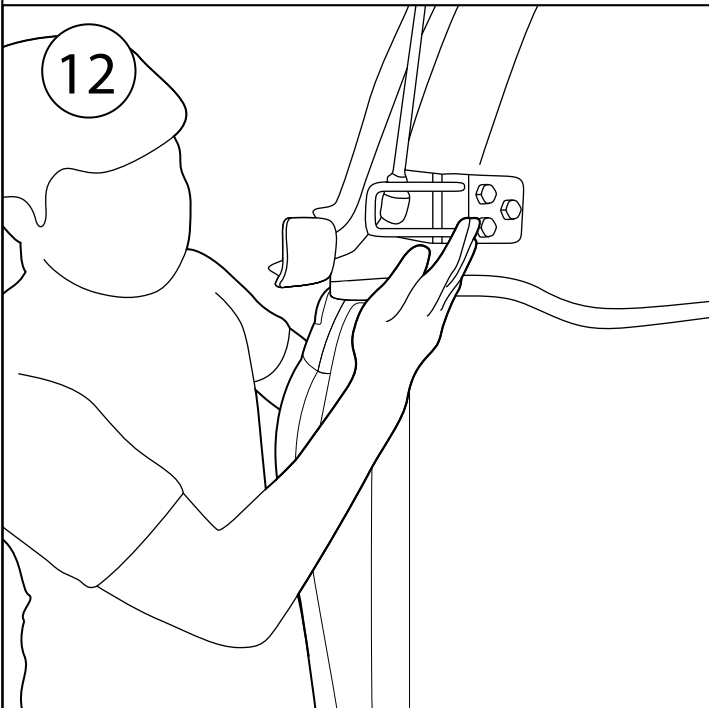

13

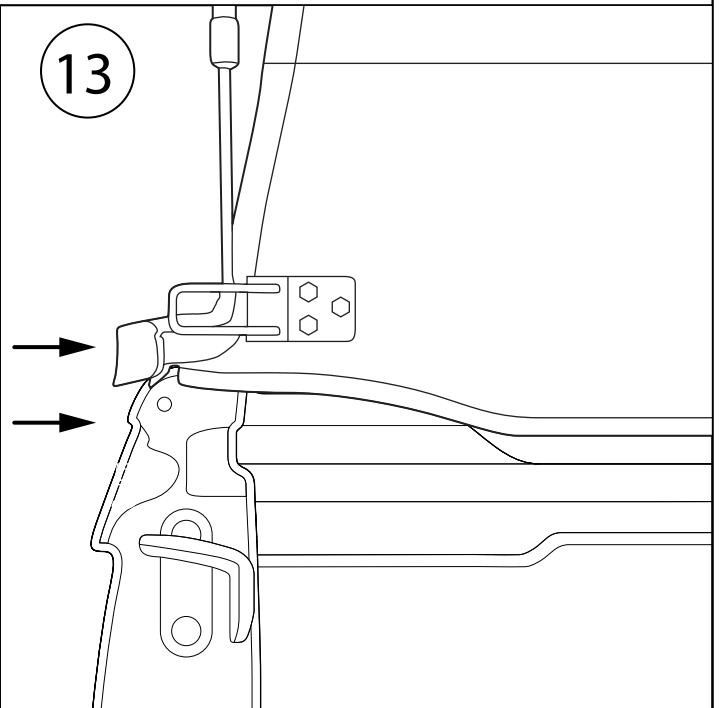

After finished measure the side part, check the distance at rear part of canopy which must have to be in the parallel with the Rear edge of the vehicle tub.



14

The process of C-Clamp installation
TL-1 canopy model with the vehicle.

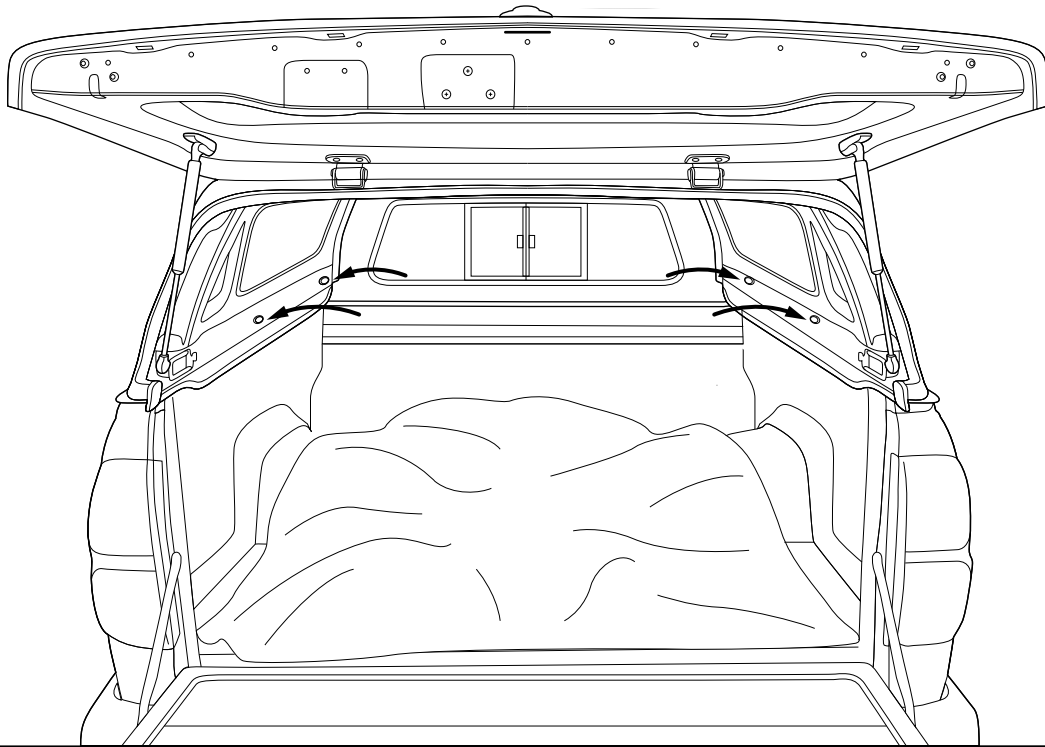

15

Open / take off
the rubber plug.

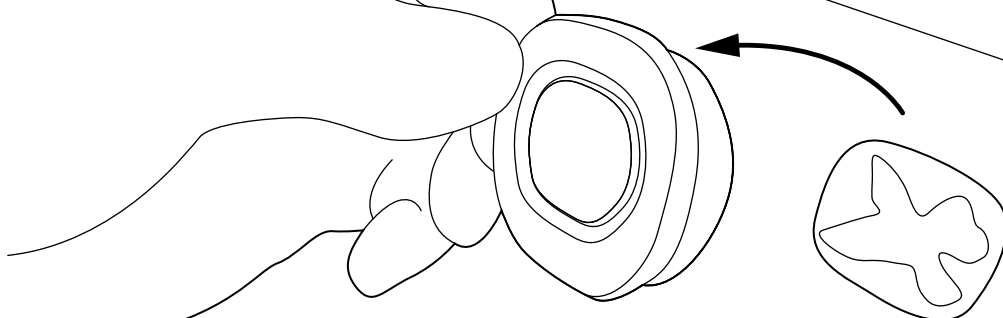
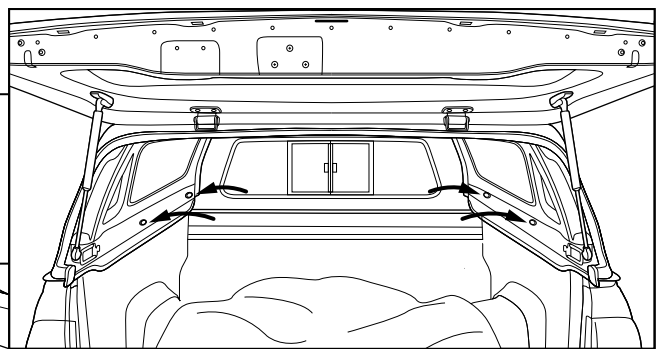



16

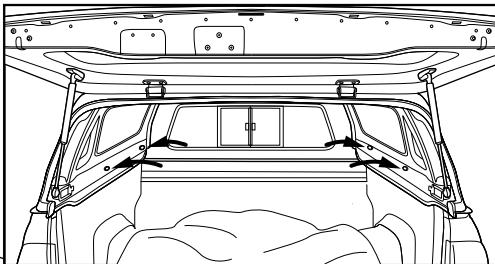
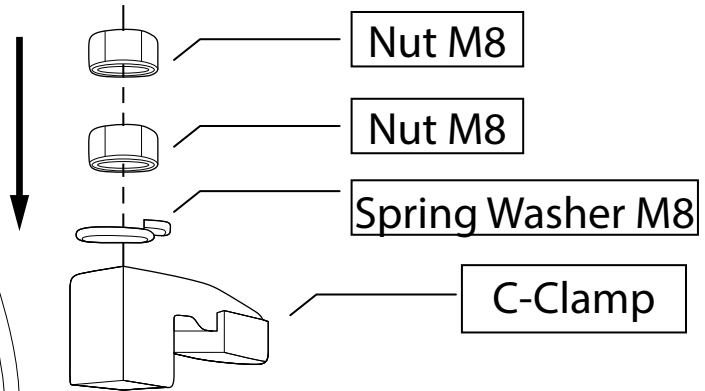

The process of C-Clamp installation onto the vehicle tub, all 4 positions (D-Cab).

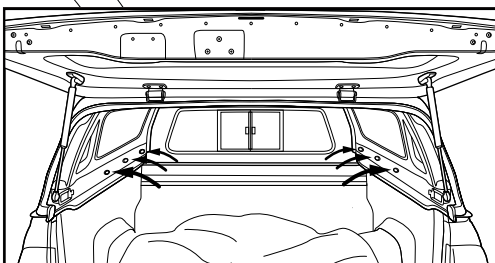

The process of C-Clamp installation onto the vehicle tub, all 6 positions (C-Cab).

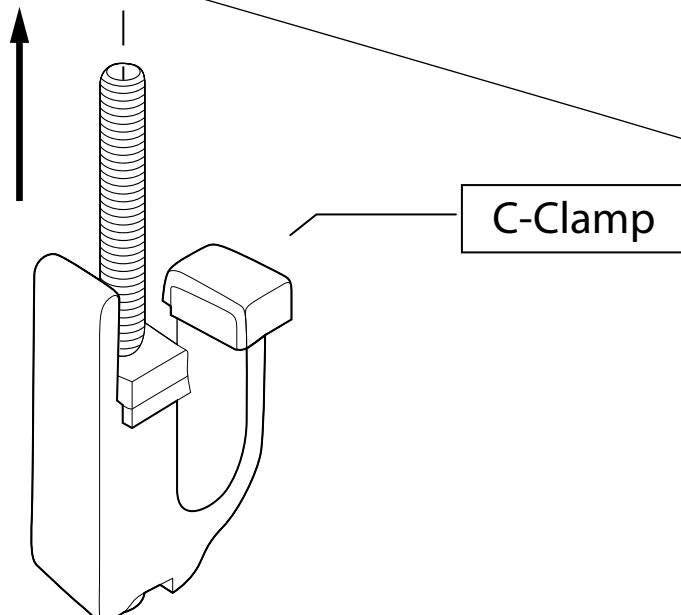



17

Tighten bolts of c-clamp by using pound wrench, with the pressure of 16 Nm.

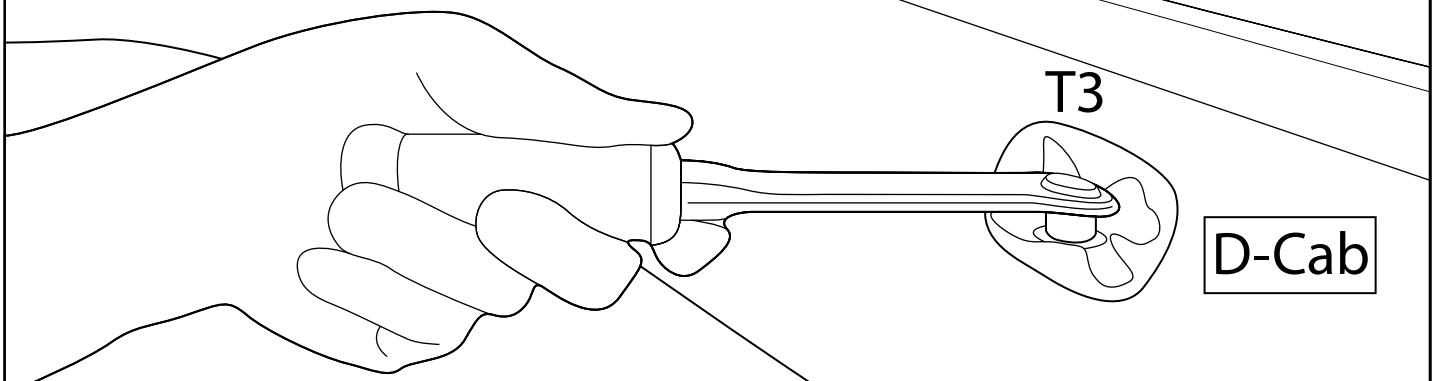
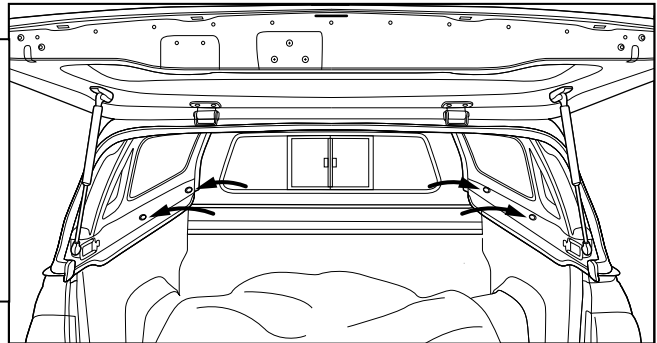

Tighten canopy C-Clamp bolts with vehicle all 4 positons.

18

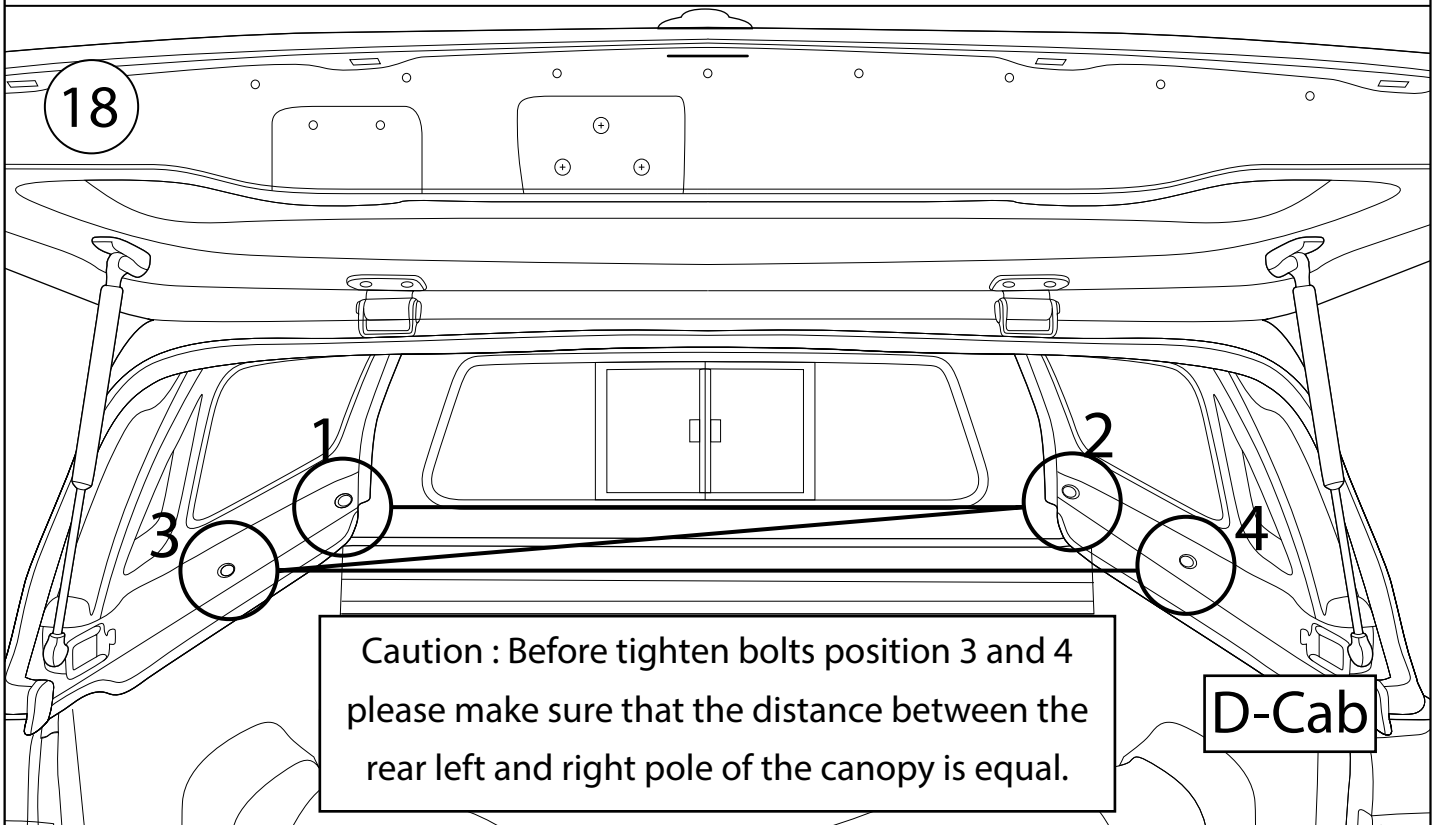

Steps of canopy C-Clamp bolts tightening onto vehicle.



19

Tighten bolts of c-clamp by using pound wrench, with the pressure of 16 Nm.

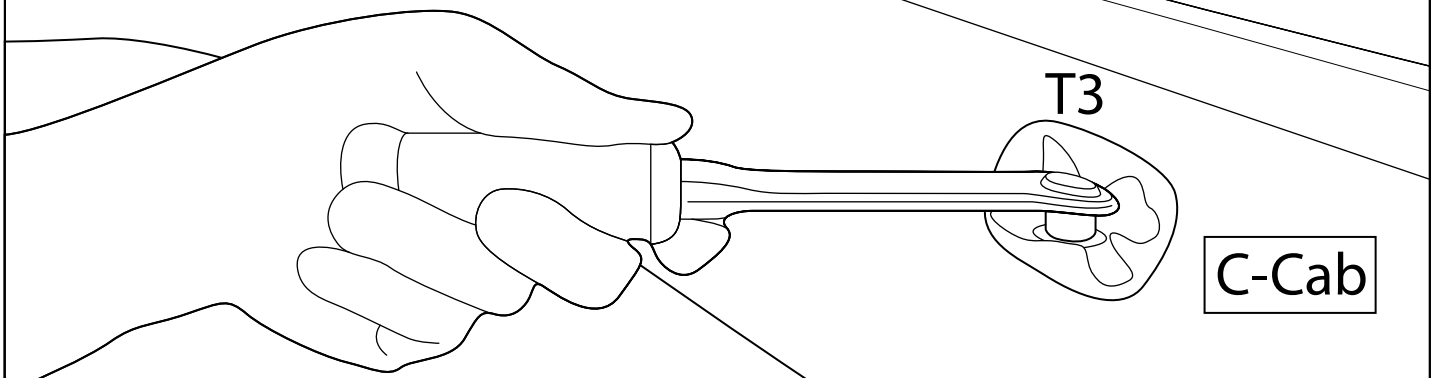
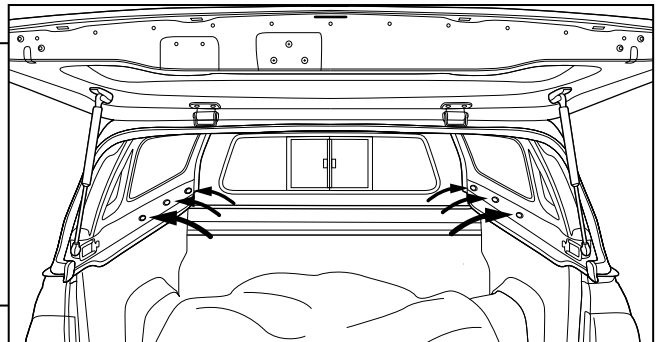

Tighten canopy C-Clamp bolts with vehicle all 6 positons.

20

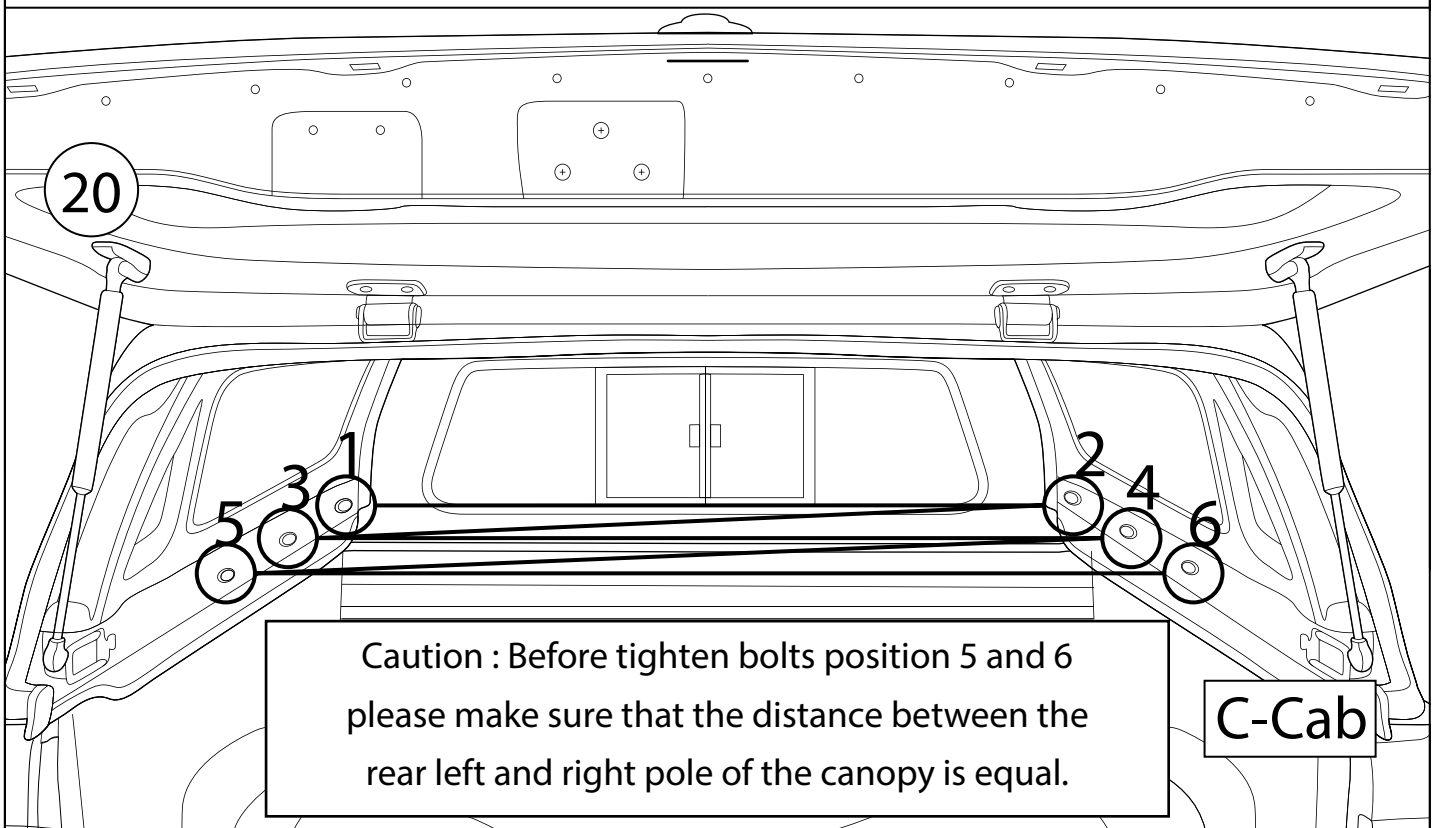

Caution : Before tighten bolts position 5 and 6 please make sure that the distance between the rear left and right pole of the canopy is equal.

Steps of canopy C-Clamp bolts tightening onto vehicle.

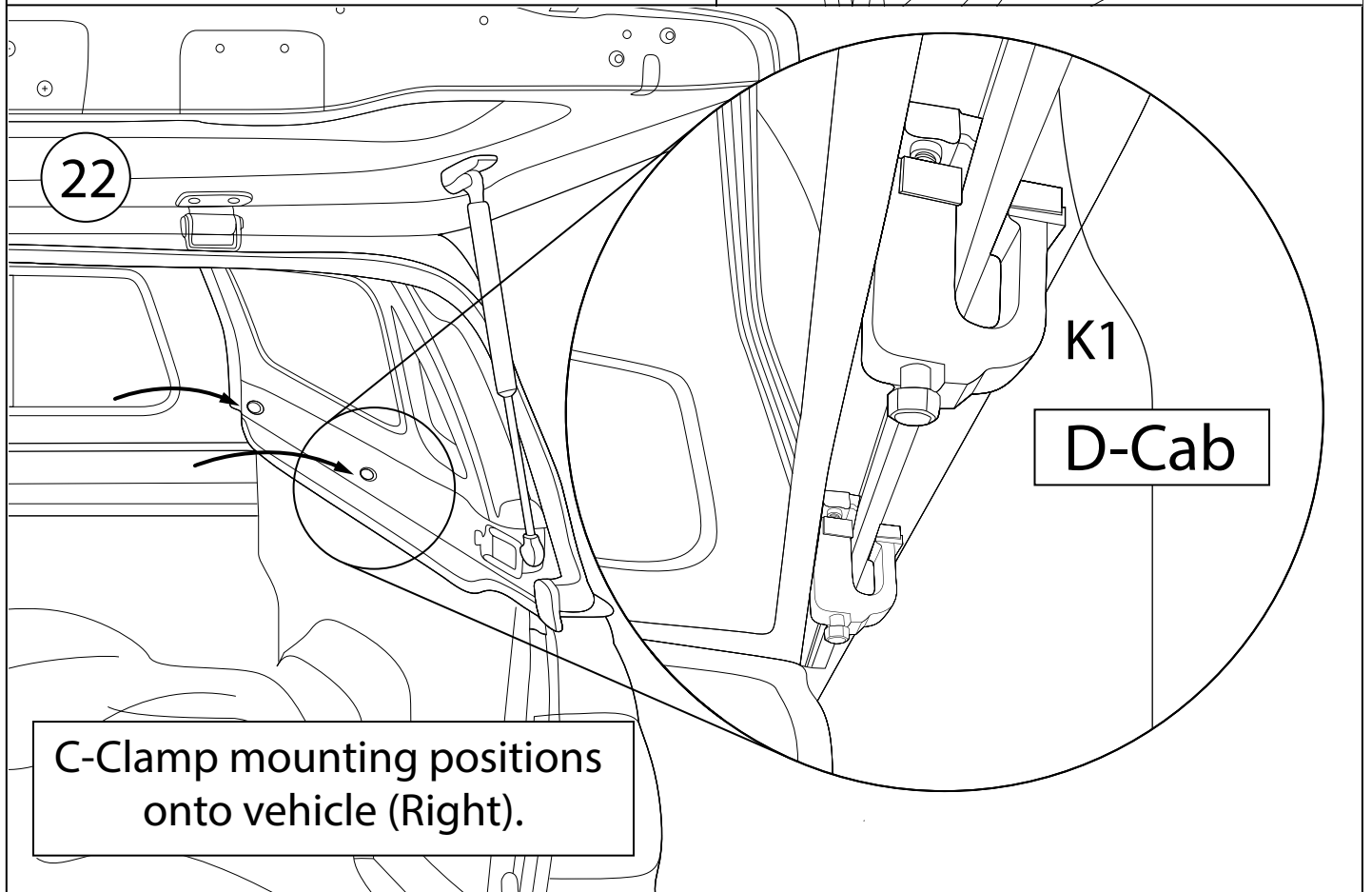
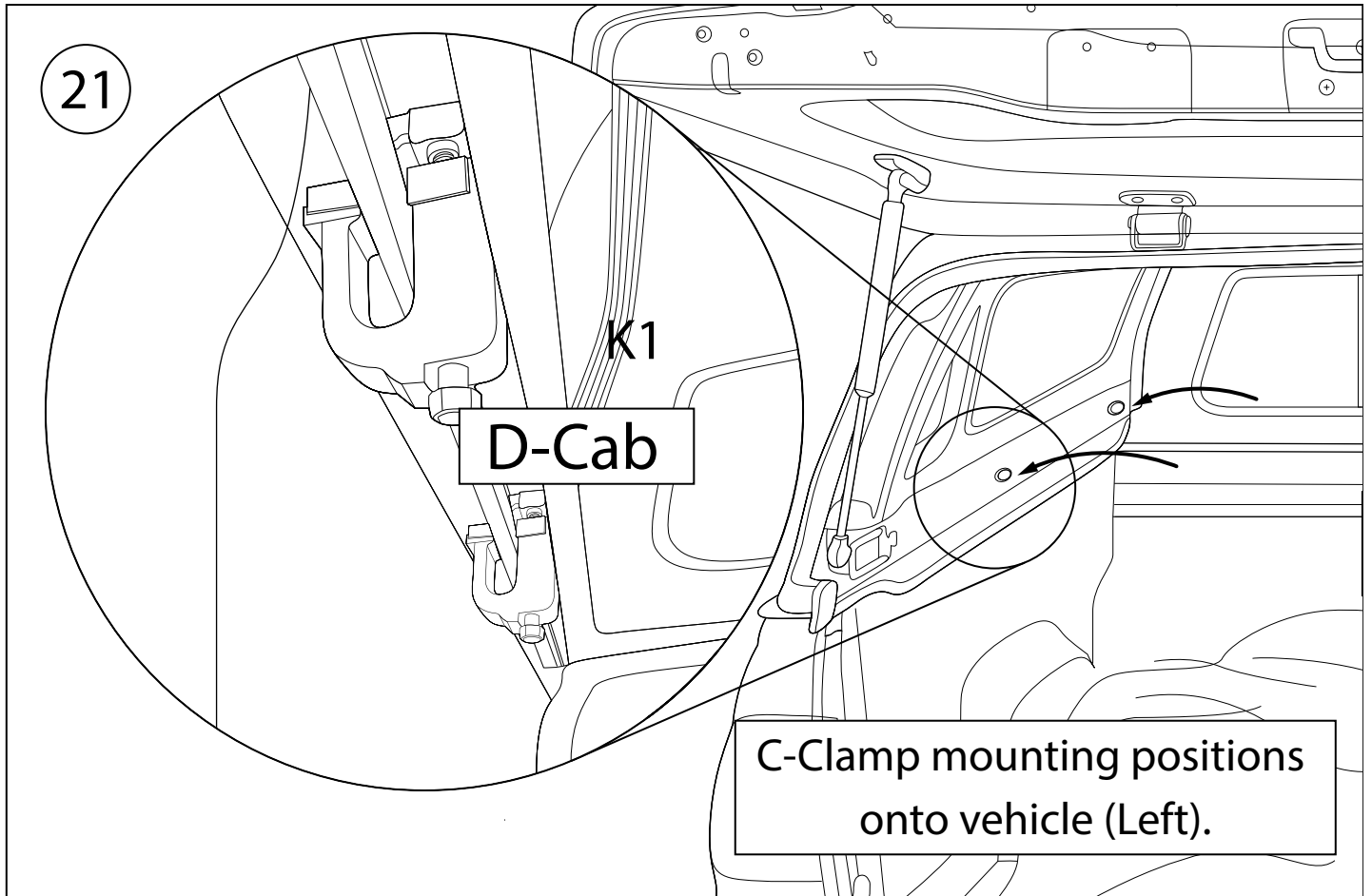

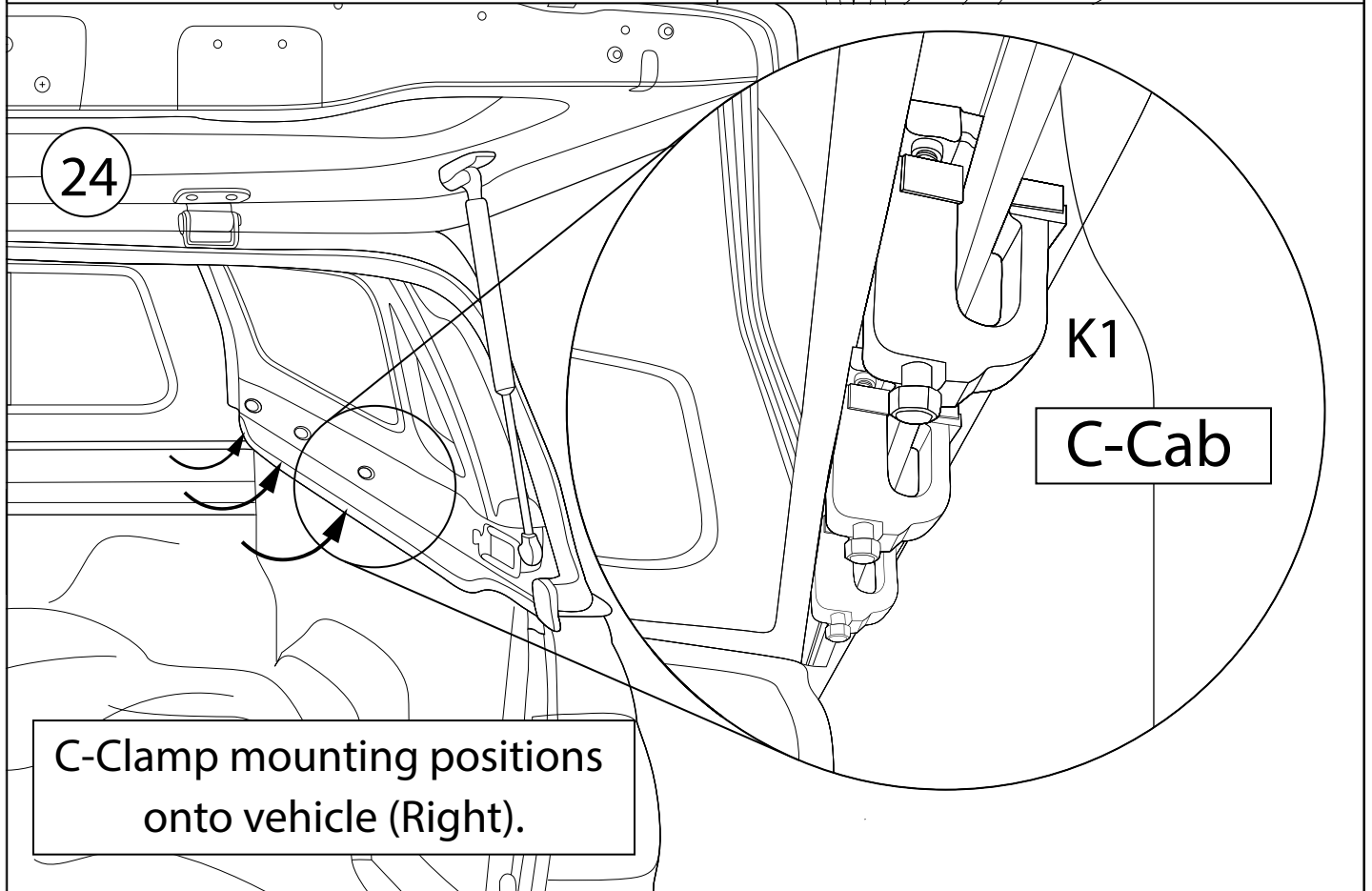
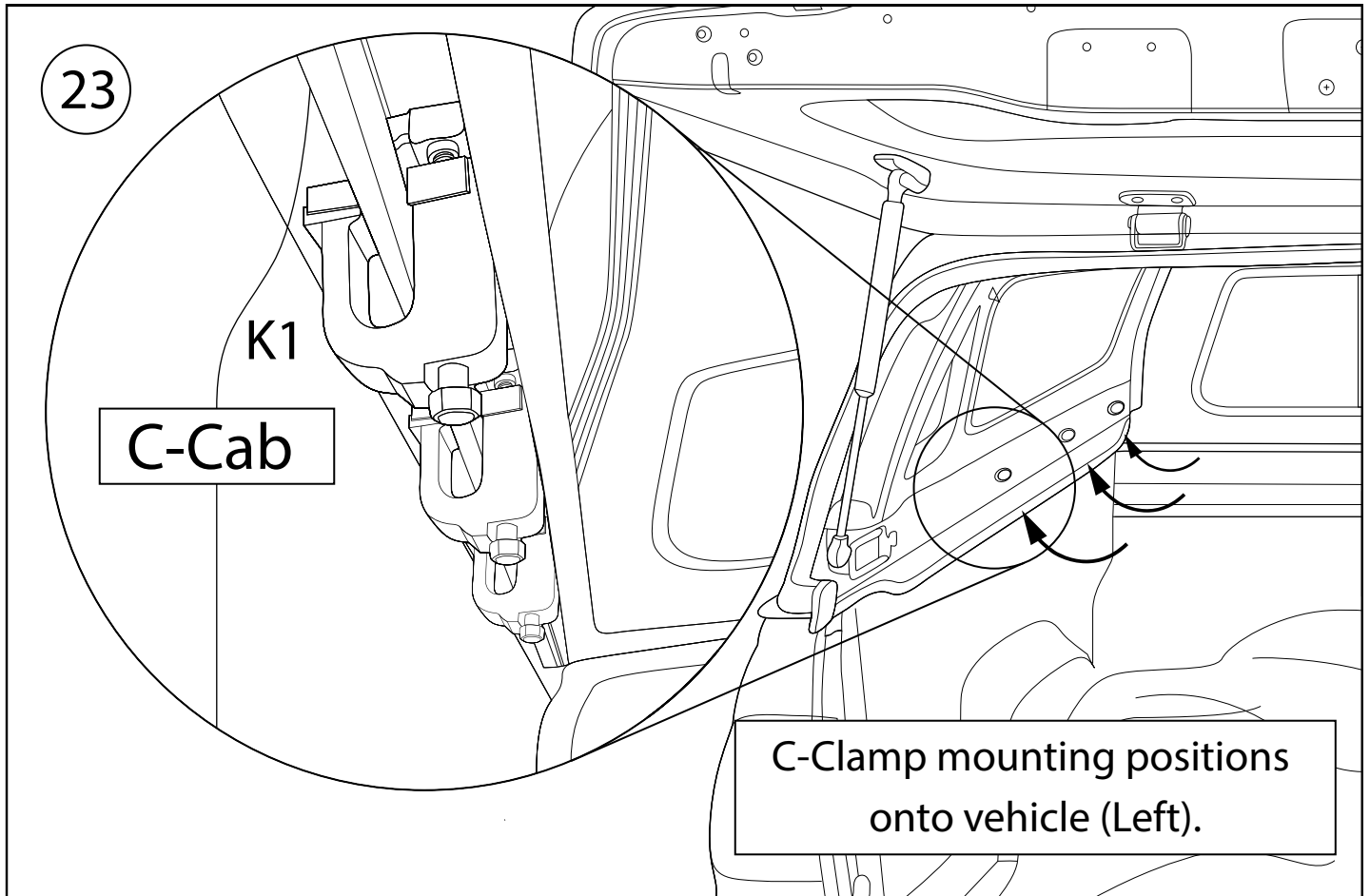



SAMMITR

29

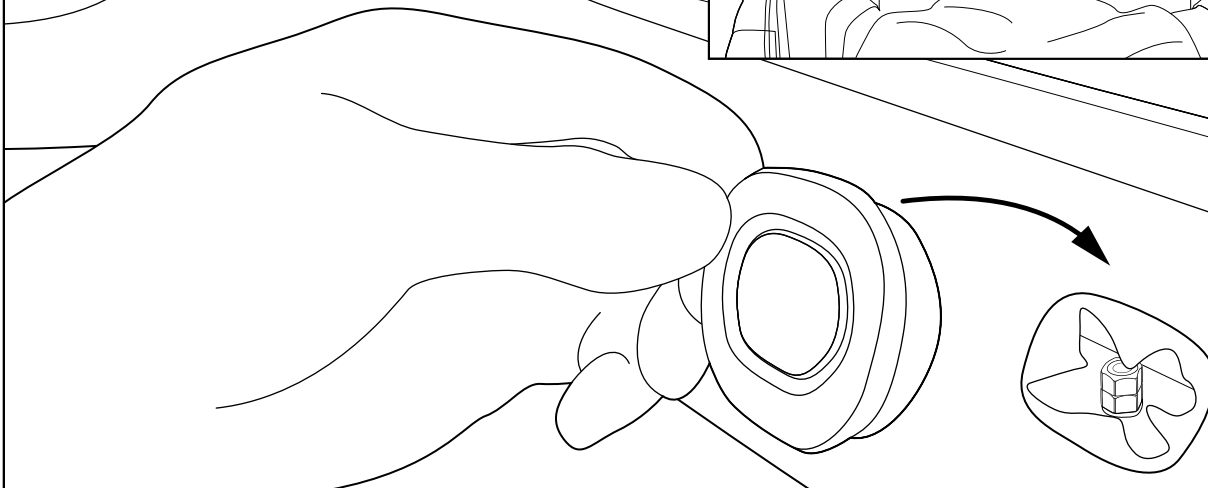
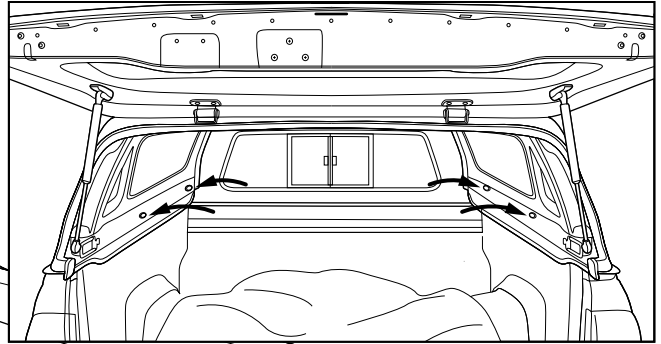

Close the rubber plug.

30

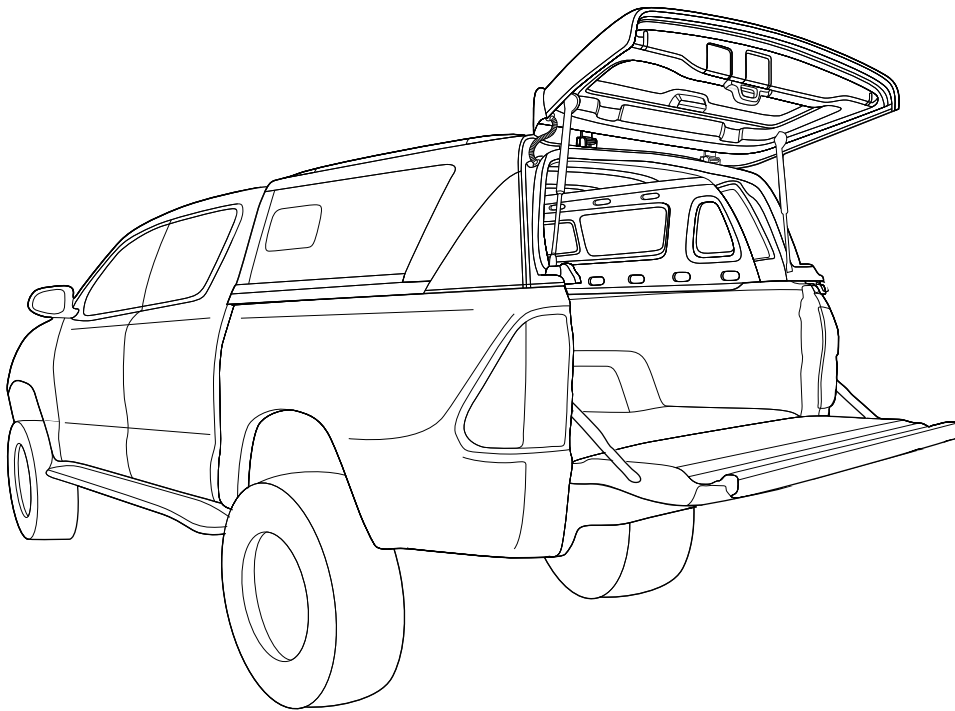

The process of canopy installation is completed.