

Take off the Wiring Cover at the driver side in order to check the wiring position.

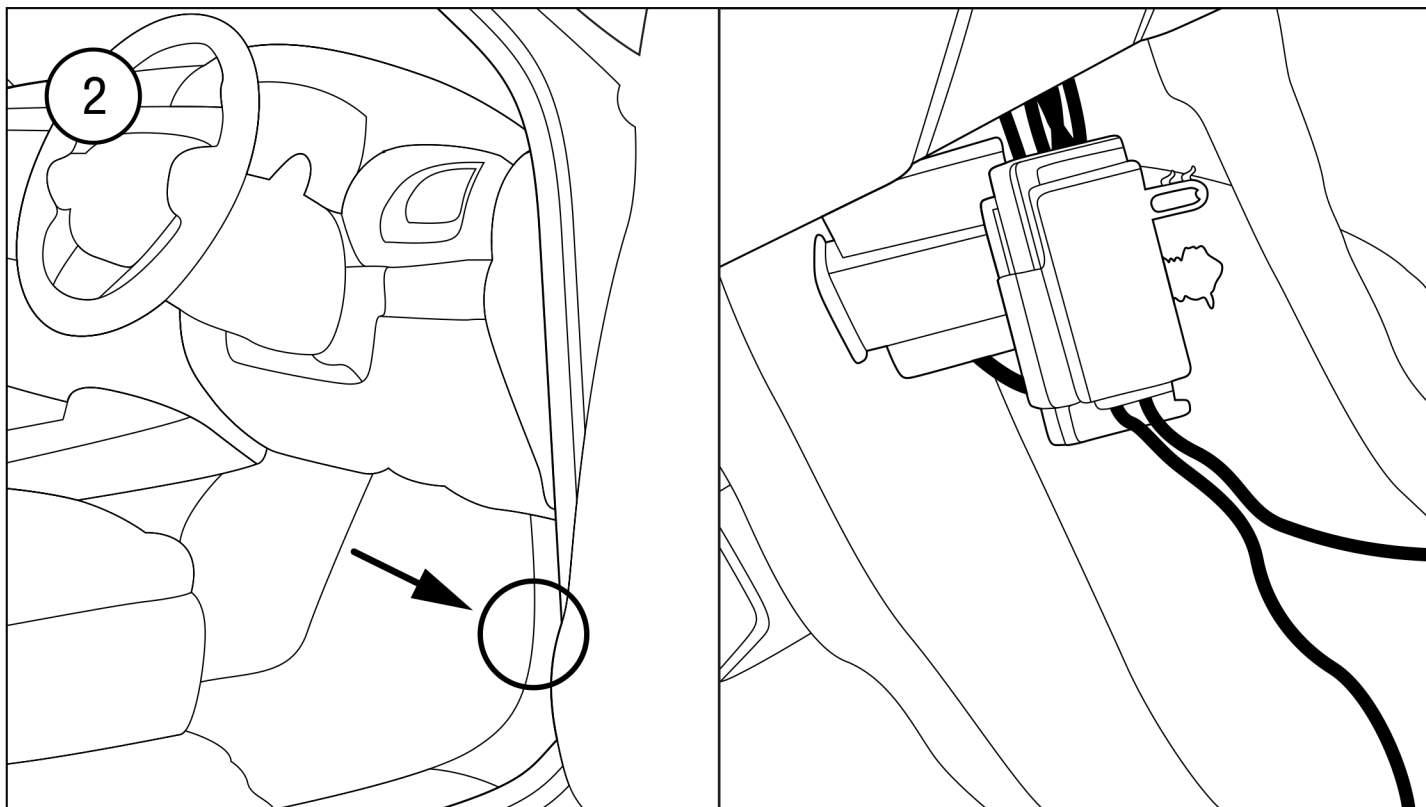

Control Box position that will connect with Harness Central Lock No.38

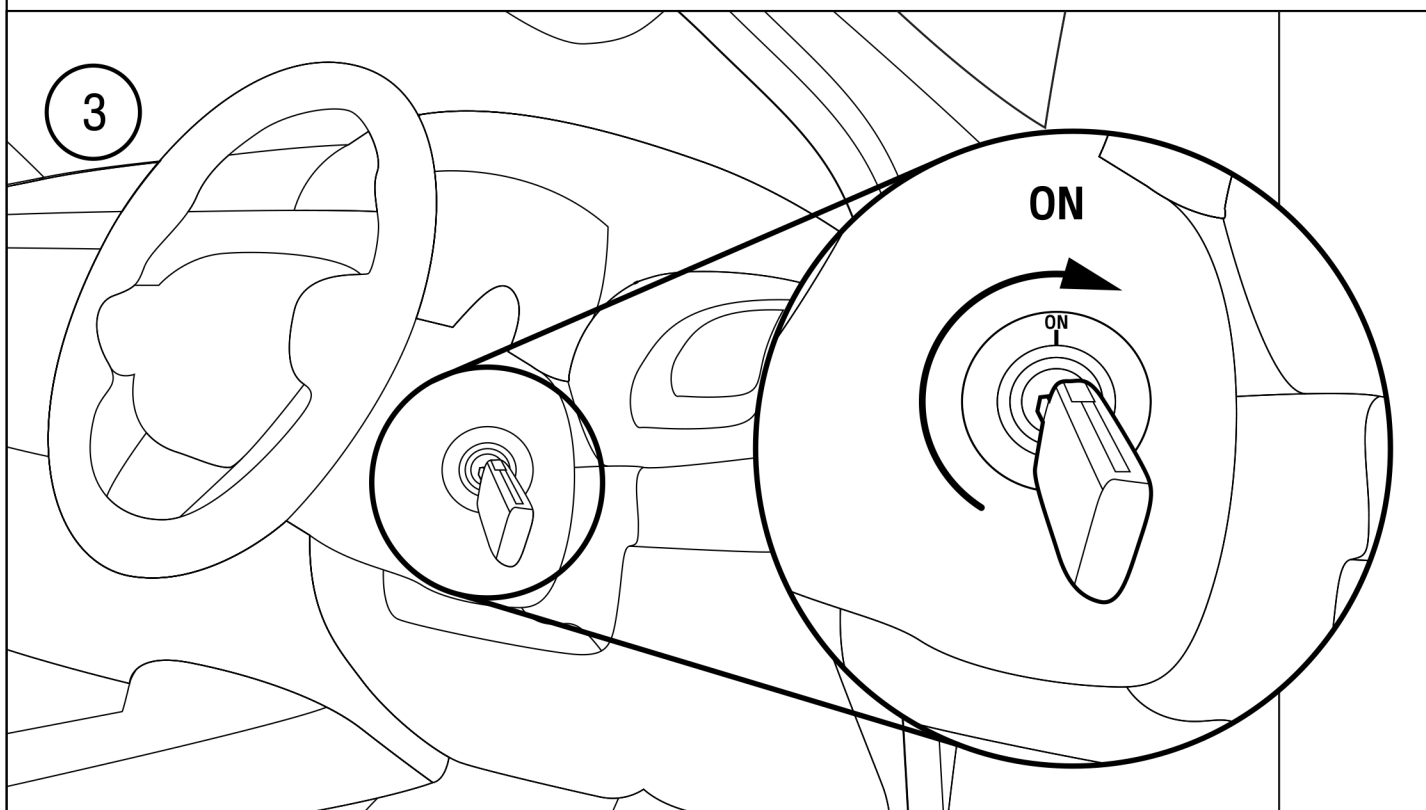

Step of checking Switch on position, begin with turning the key to ON position.



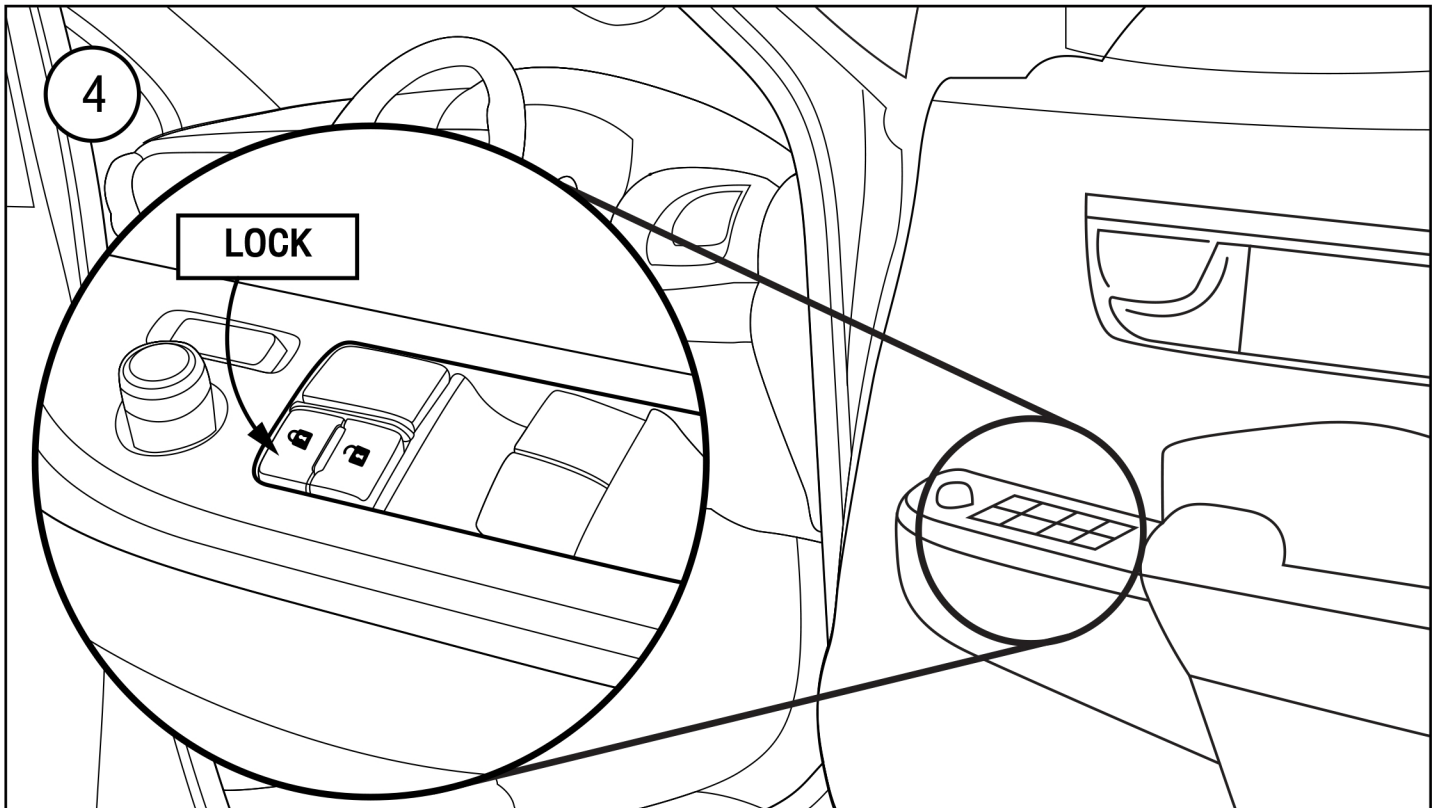

Step of Checking the light of the Central Lock (Lock), begin with push the Lock button at the door panel.

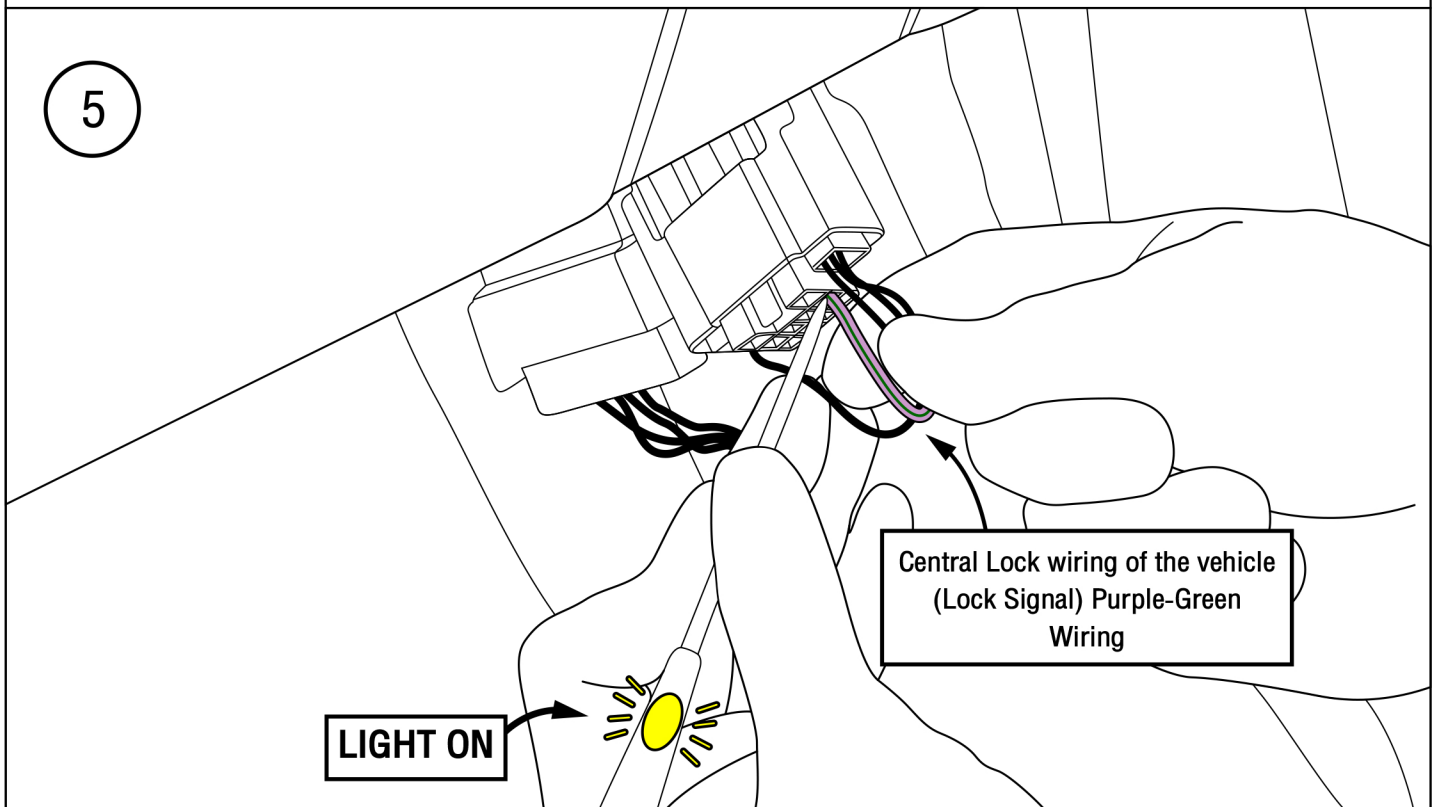

Checking the light of the Central Lock (Lock) of vehicle position by using the Test Lamp kit.

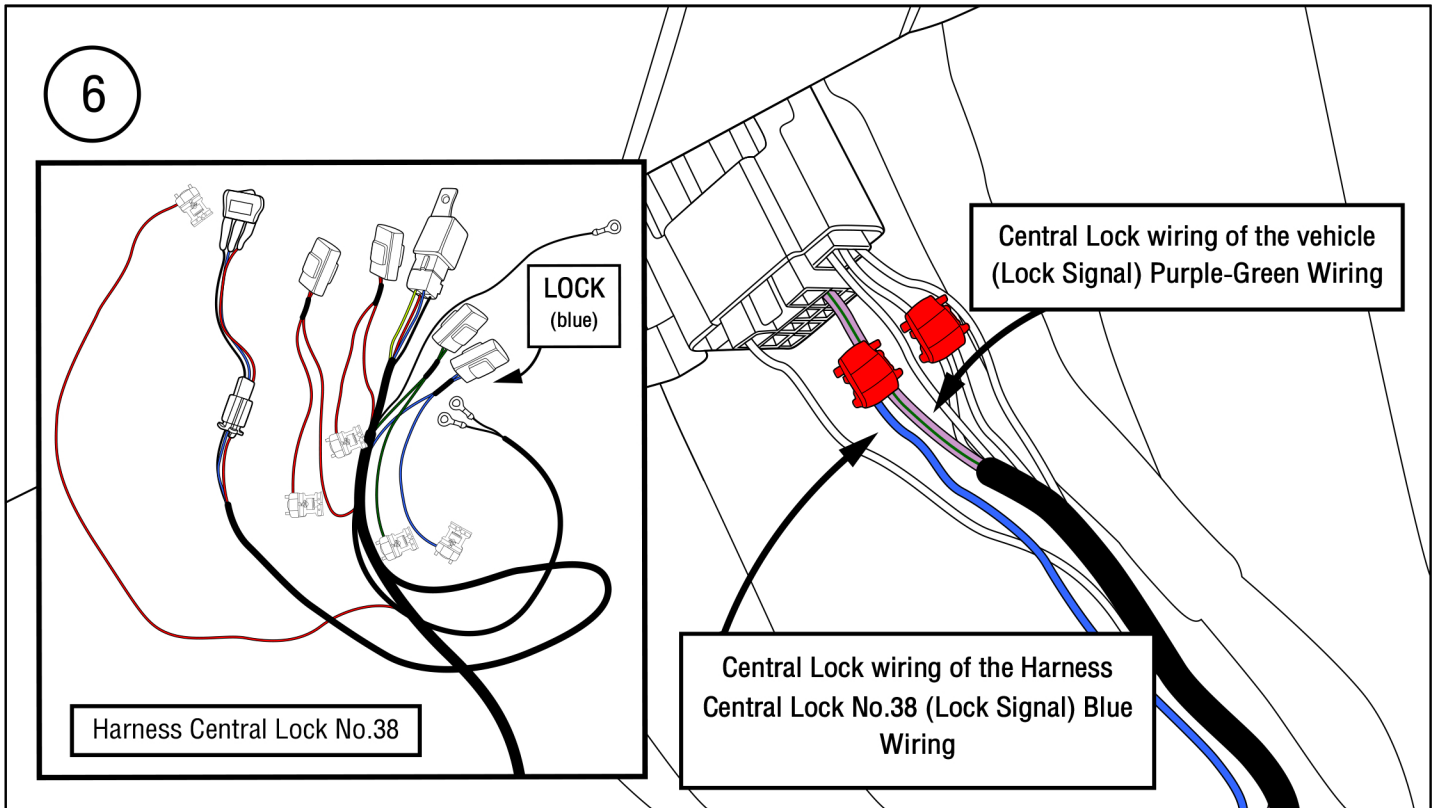

Connects the Blue Wiring (Central Lock/Lock Switch) of the Harness Central Lock No.38 with the Purple-Green wiring (PU/LG) of the vehicle (Lock Signal).

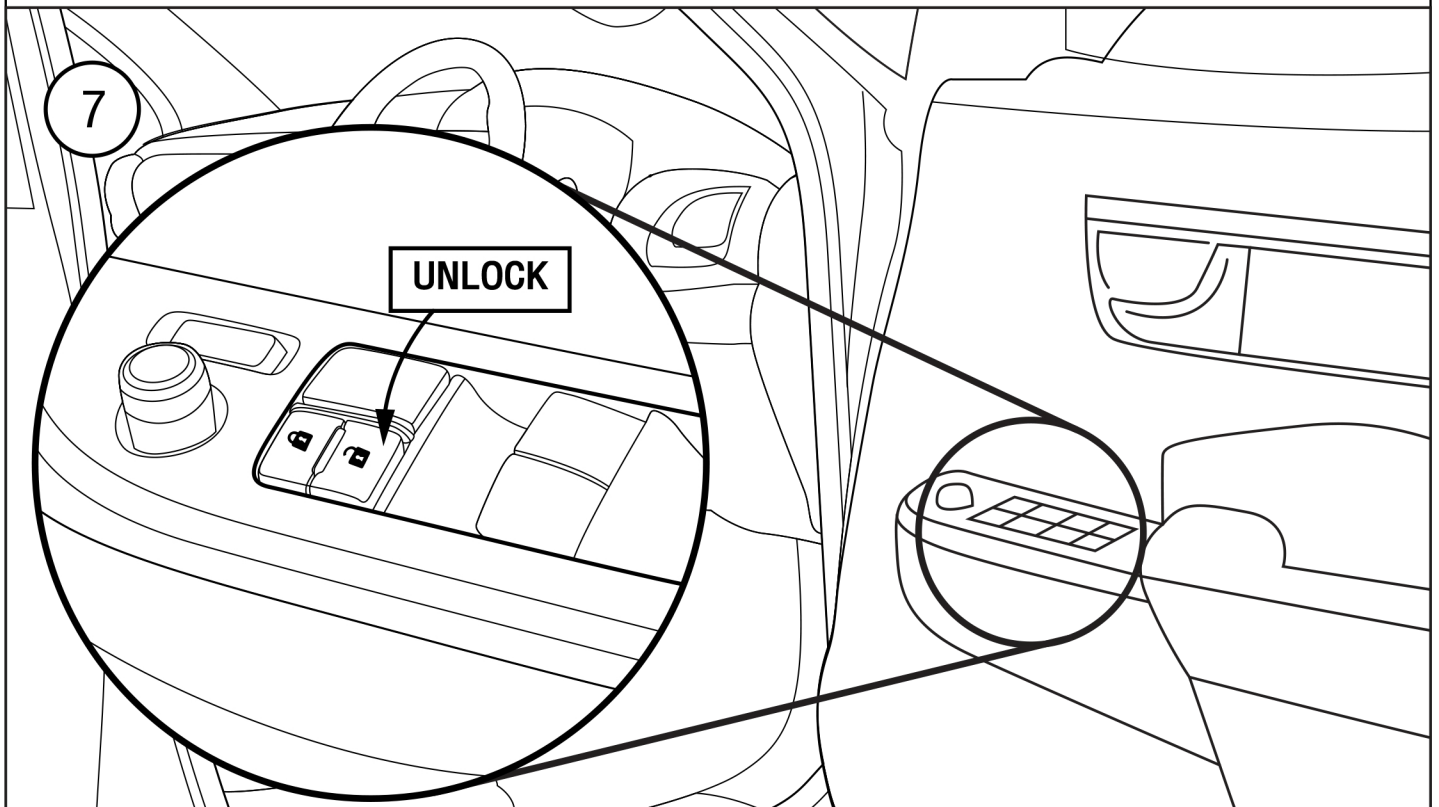

Step of Checking the light of the Central Lock (UnLock), begin with push the UnLock button at the door panel.

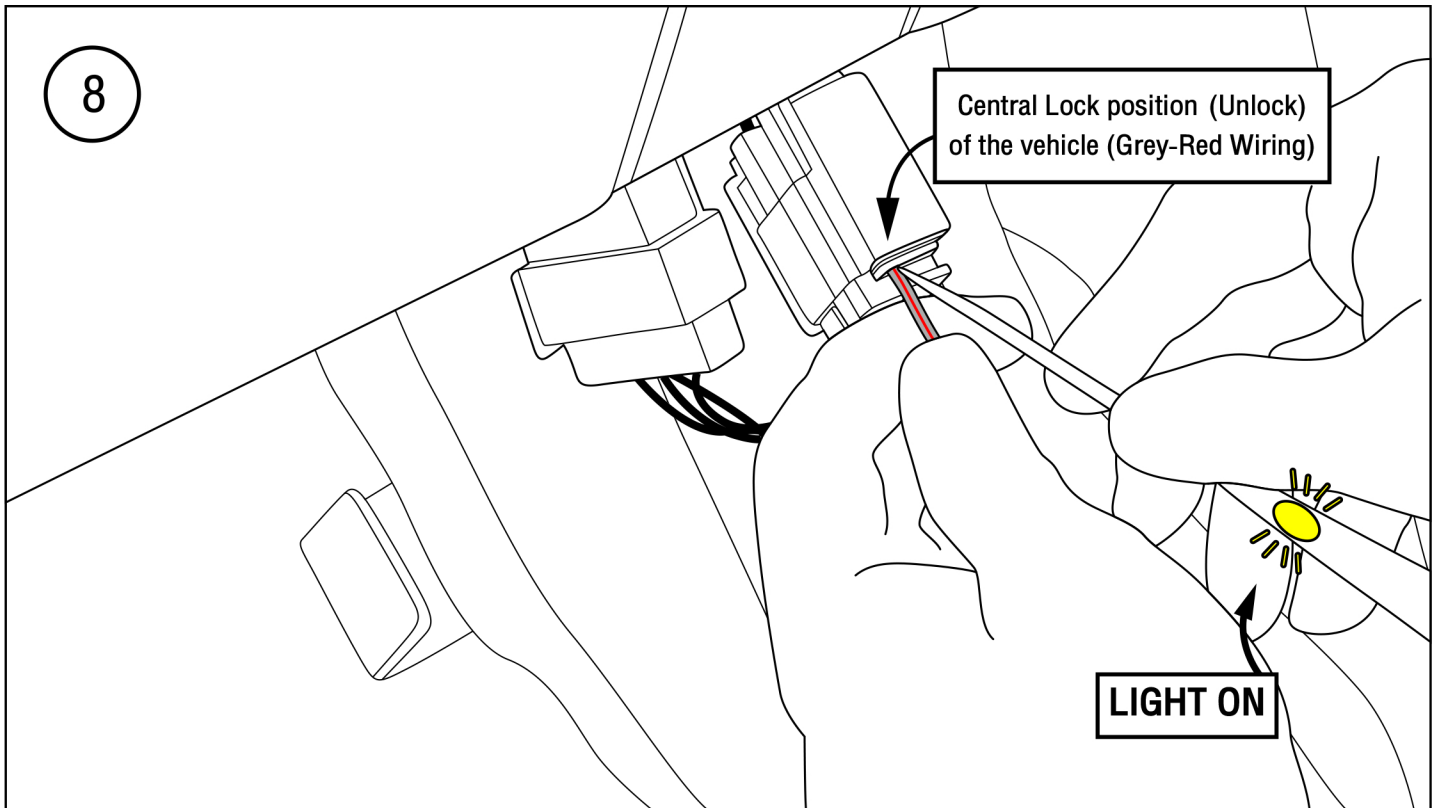

Checking the light of the Central Lock (Unlock) of vehicle position by using the Test Lamp kit.

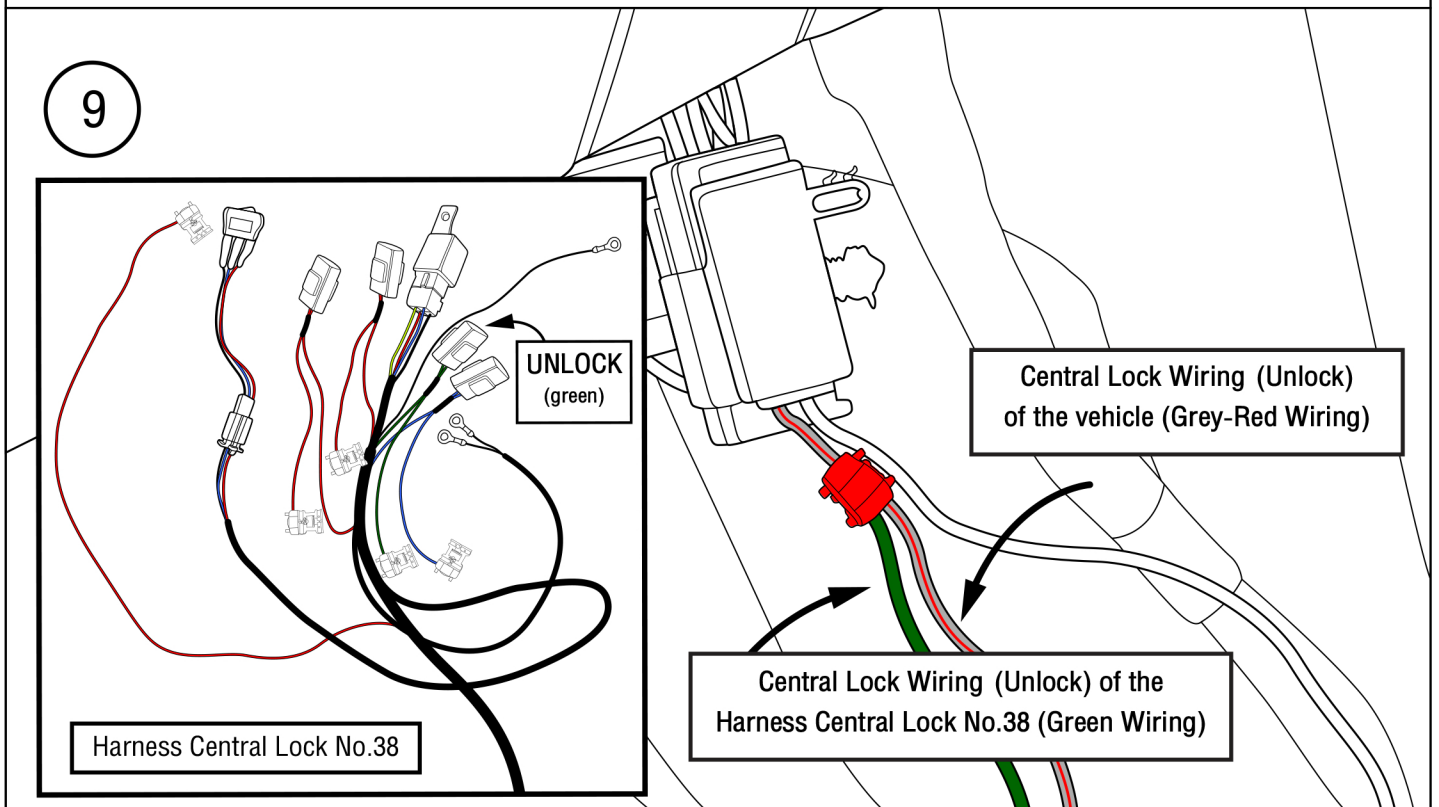

Connects the Green Wiring (Central Lock/Unlock Switch) of the Harness Central Lock No.38 with the Grey-Red Wiring (GR-RD) of the vehicle (Unlock Signal).

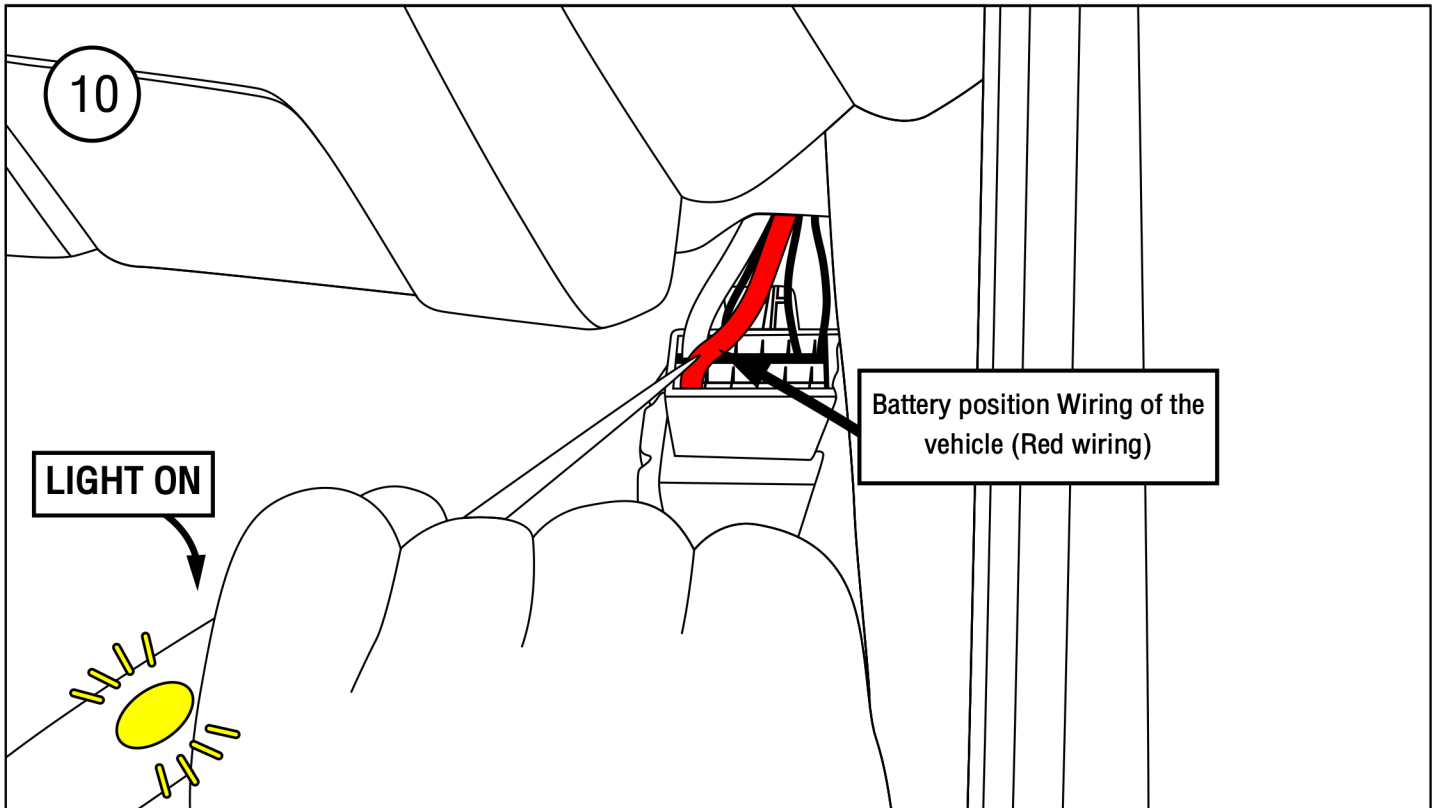

Checking the Battery (12V) light of the vehicle position by using the Test Lamp kit.

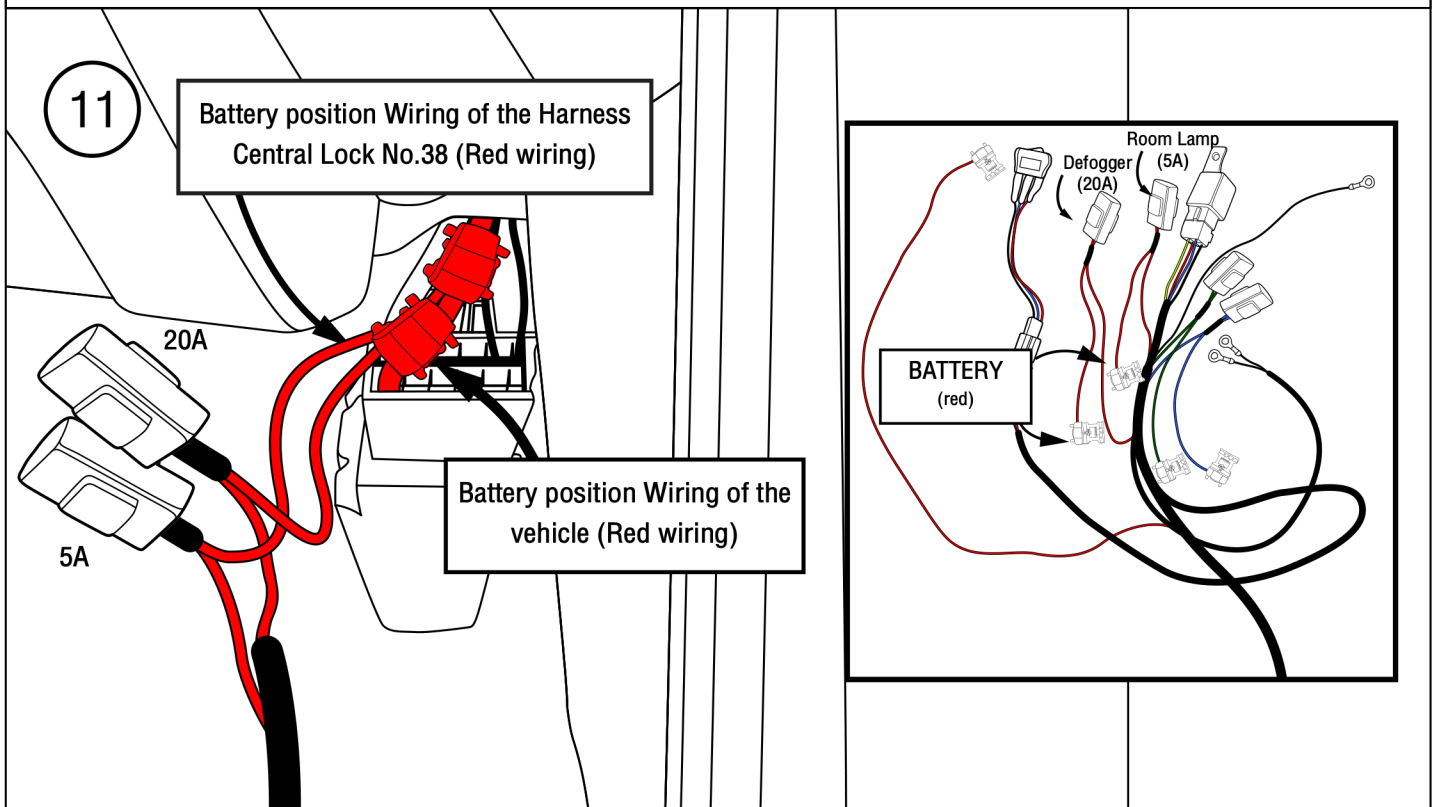

Connects the Red Wiring Defogger (20A) and Red Wiring Room Lamp (5A) of the Harness Central Lock No.38 with the Red Wiring Battery (12V) of the vehicle as shown in picture.



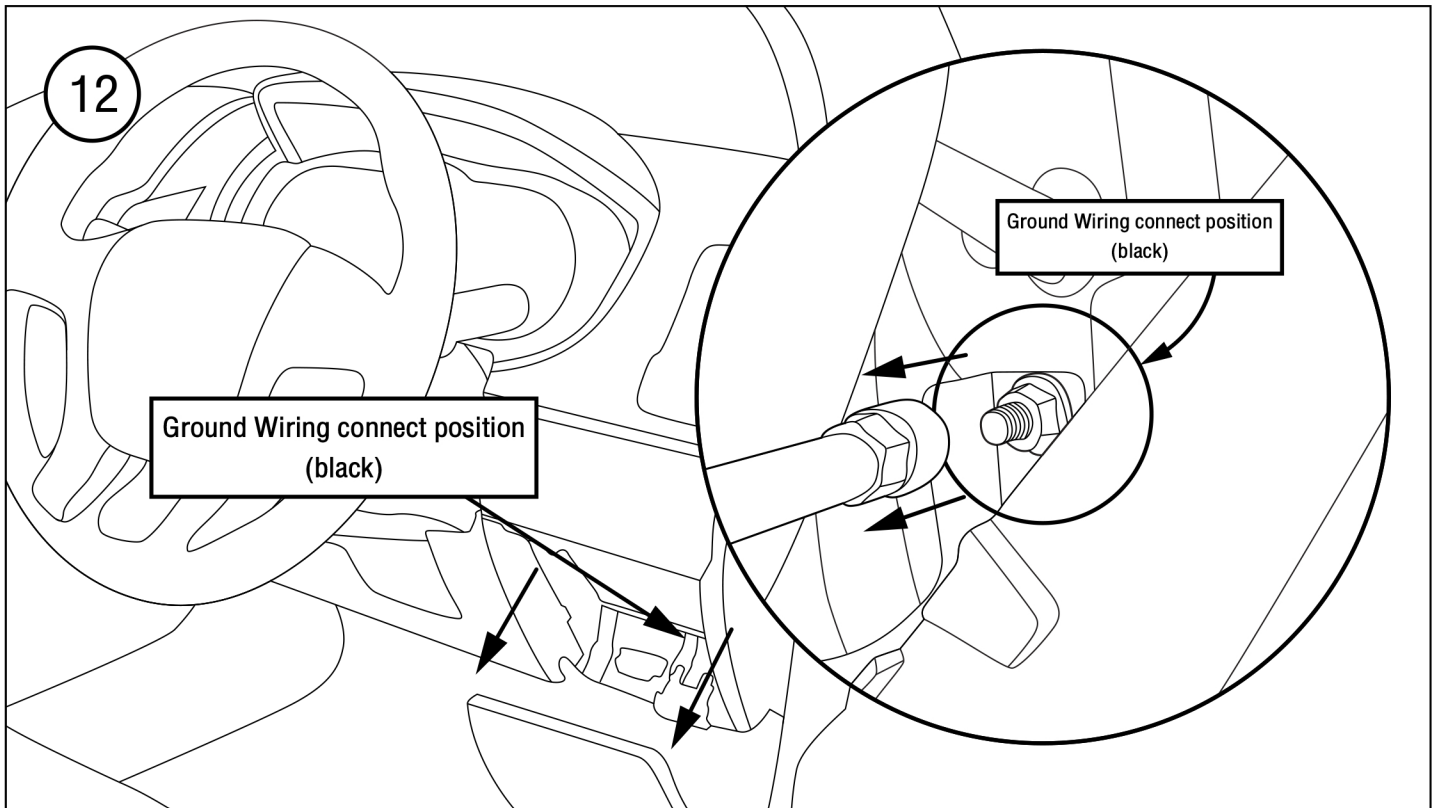

Take off the Cover at the Driver side in order to connect the Black Wiring of the Harness Central Lock No.38 with the Vehicle Structure. Take off the Bolt by using wrench No.10

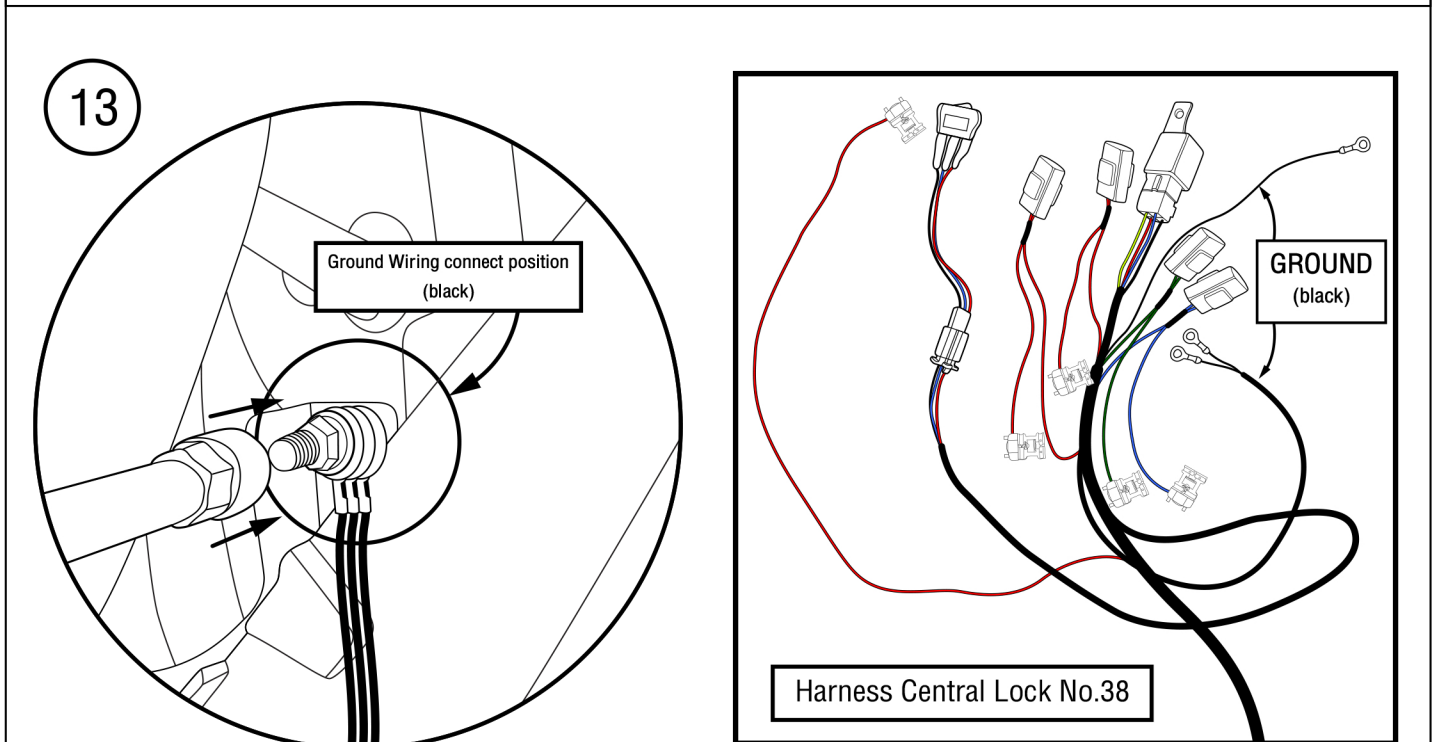

Connect the Black Wiring (Ground) of the Harness Central Lock No.38 with the Vehicle Structure and using wrench tighten.





14

Defogger circuit switch installation *in case not using defogger switch of the Harness Central Lock No.38.*

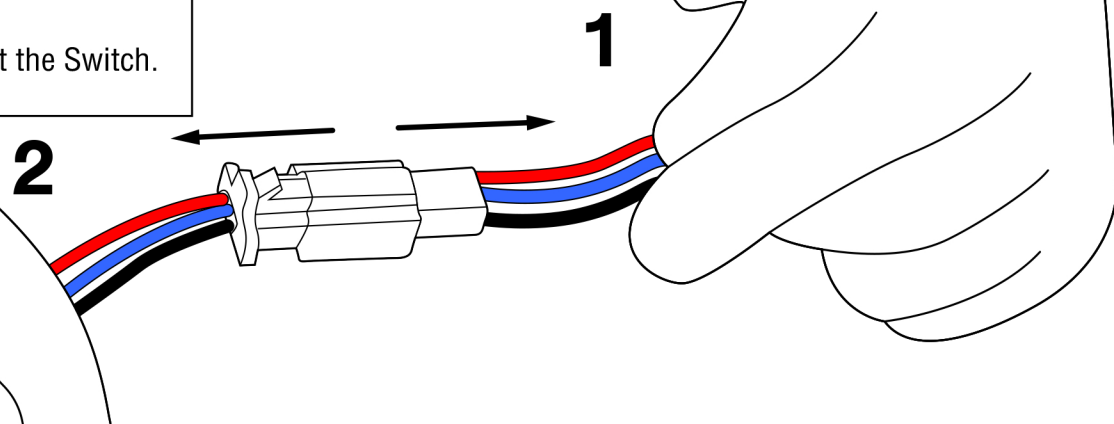
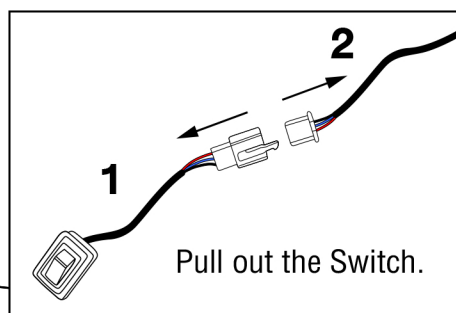

Defogger circuit switch installation of the Harness Central Lock No.38 of the Ford Ranger vehicle.

15

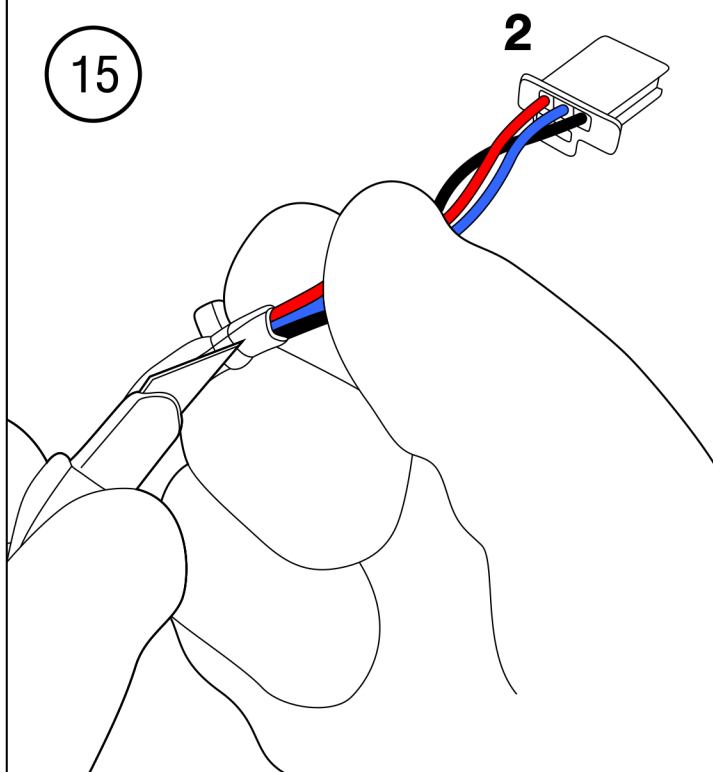

Cut-off the cable

16

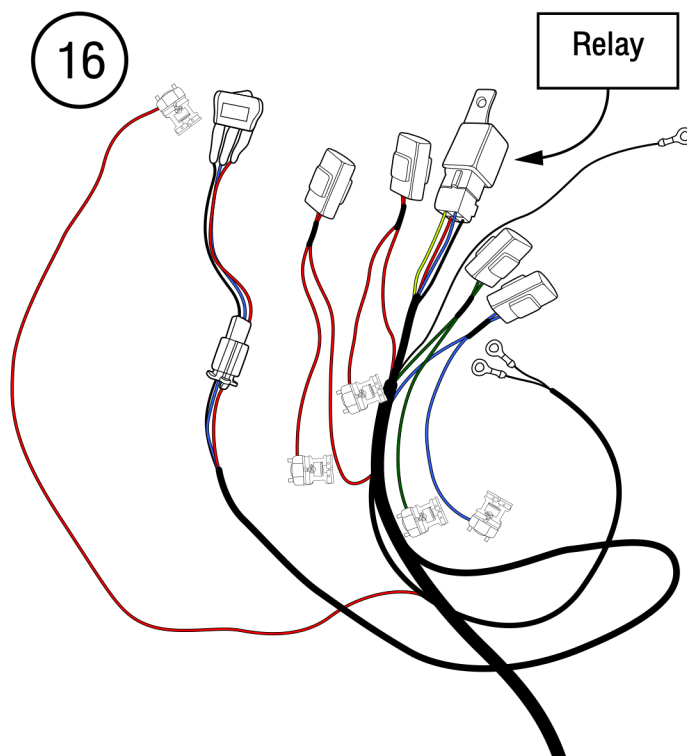

Relay Set of the Harness Central Lock No.38



17

Beware!  
Wiring damage.

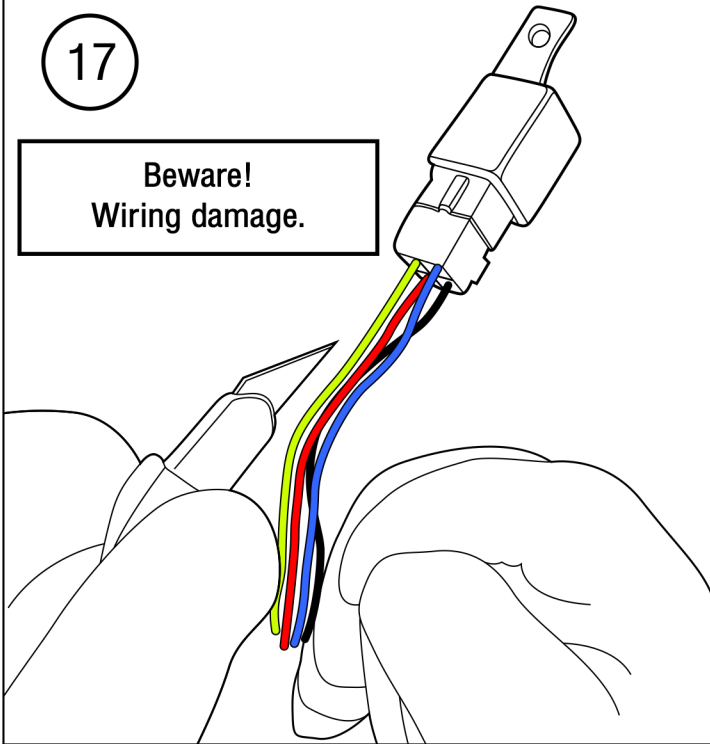

Cut-Off the tape of the Relay.

18

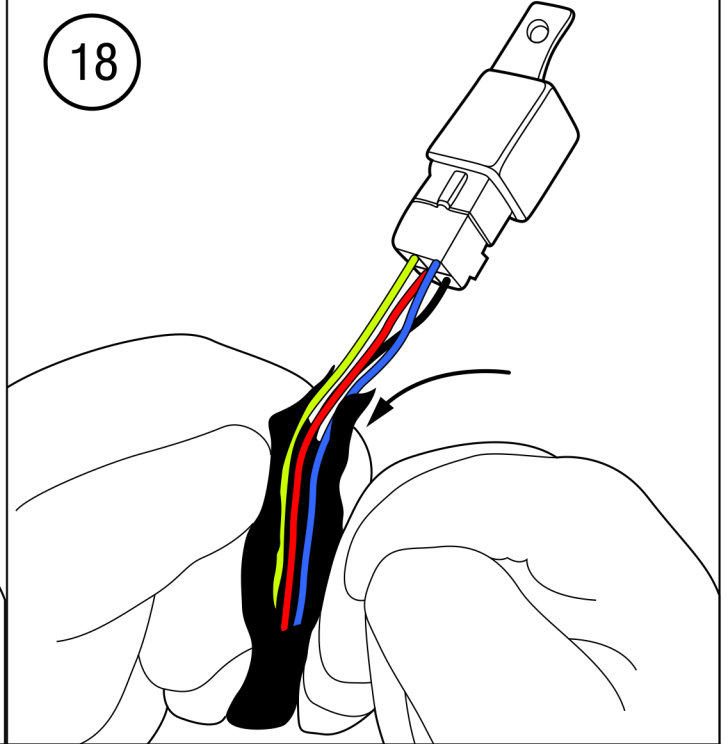

Pull out the tape

19

Beware!  
Wiring damage.

2

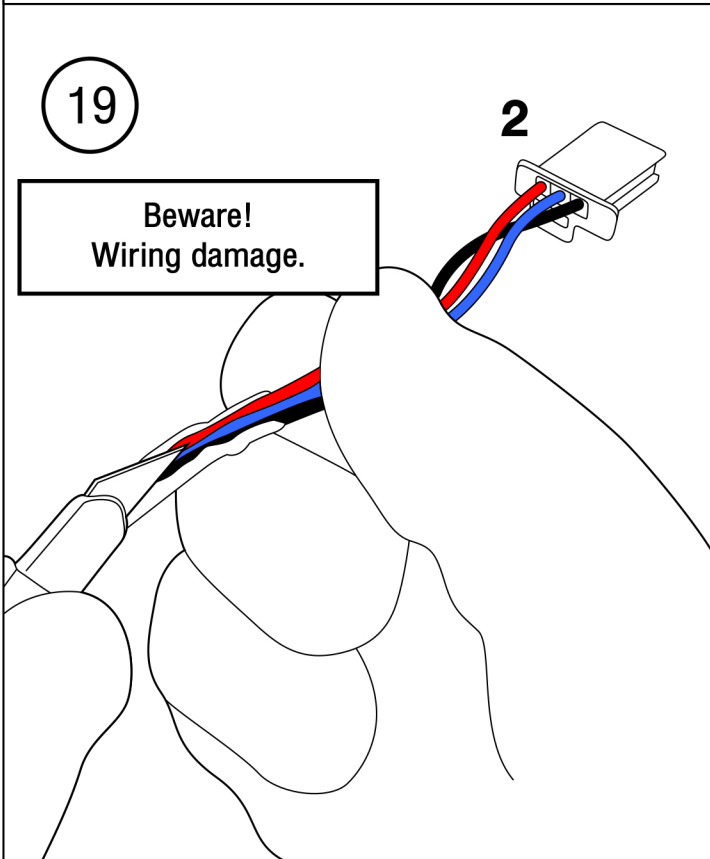

Cut the switch cable insulation pipe.

20

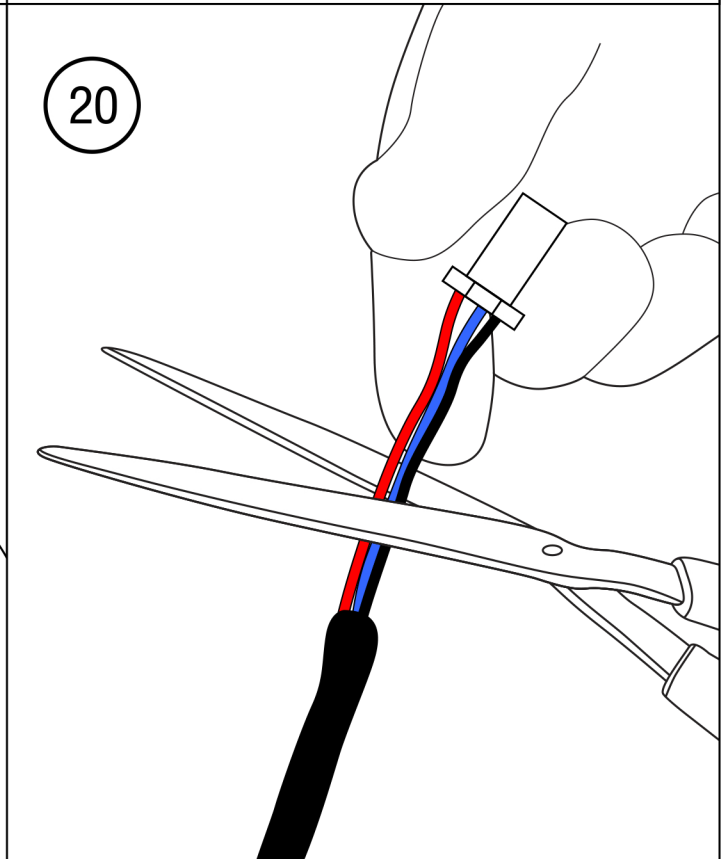

Cut the end of the defogger switch cable.



21

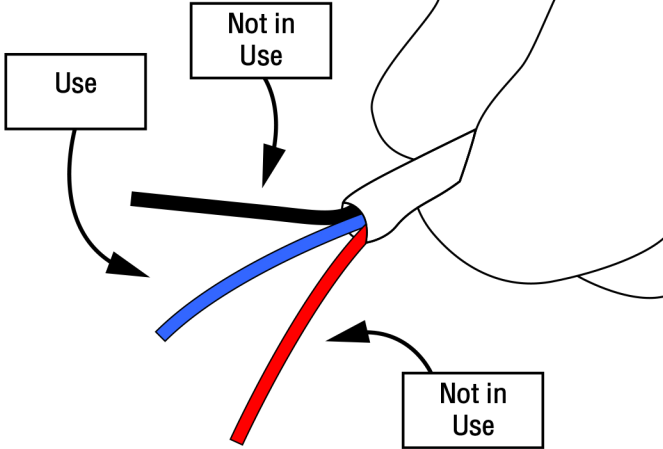

After Cut the end of the defogger switch cable, the wiring that will be using for connecting is the Blue colour.

22

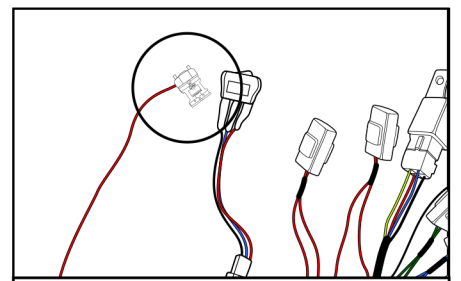
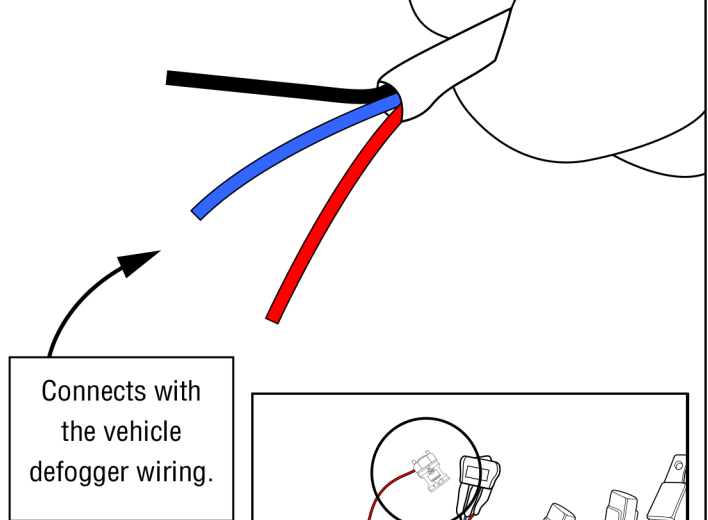

Take the Electro-tap from the Switch On of the Harness Central Lock No.38 connecting with the defogger wiring.

23

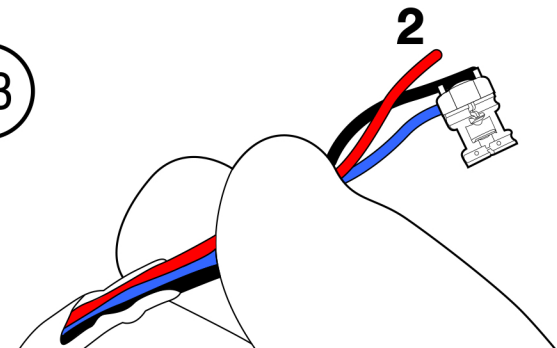

From item 24 : Electro-tap that connect with the blue wiring.

2

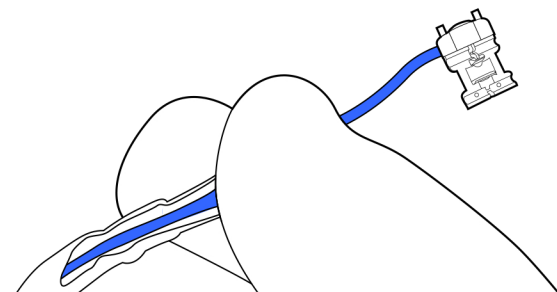

Take off the Red and Black wiring out of the defogger switch set, only leave the blue wiring in.

24

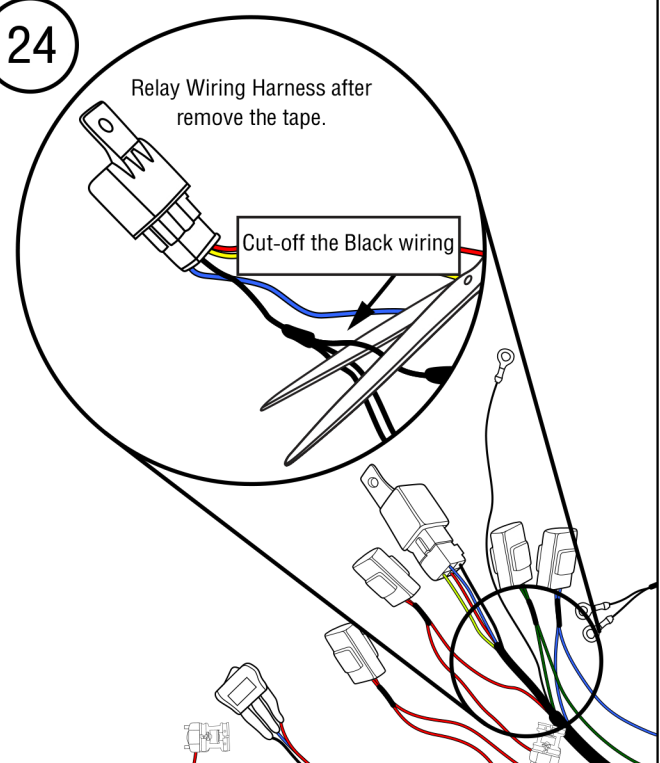

Cut the black wiring of the defogger wiring harness in order to remove the black wiring from the Relay wiring harness.

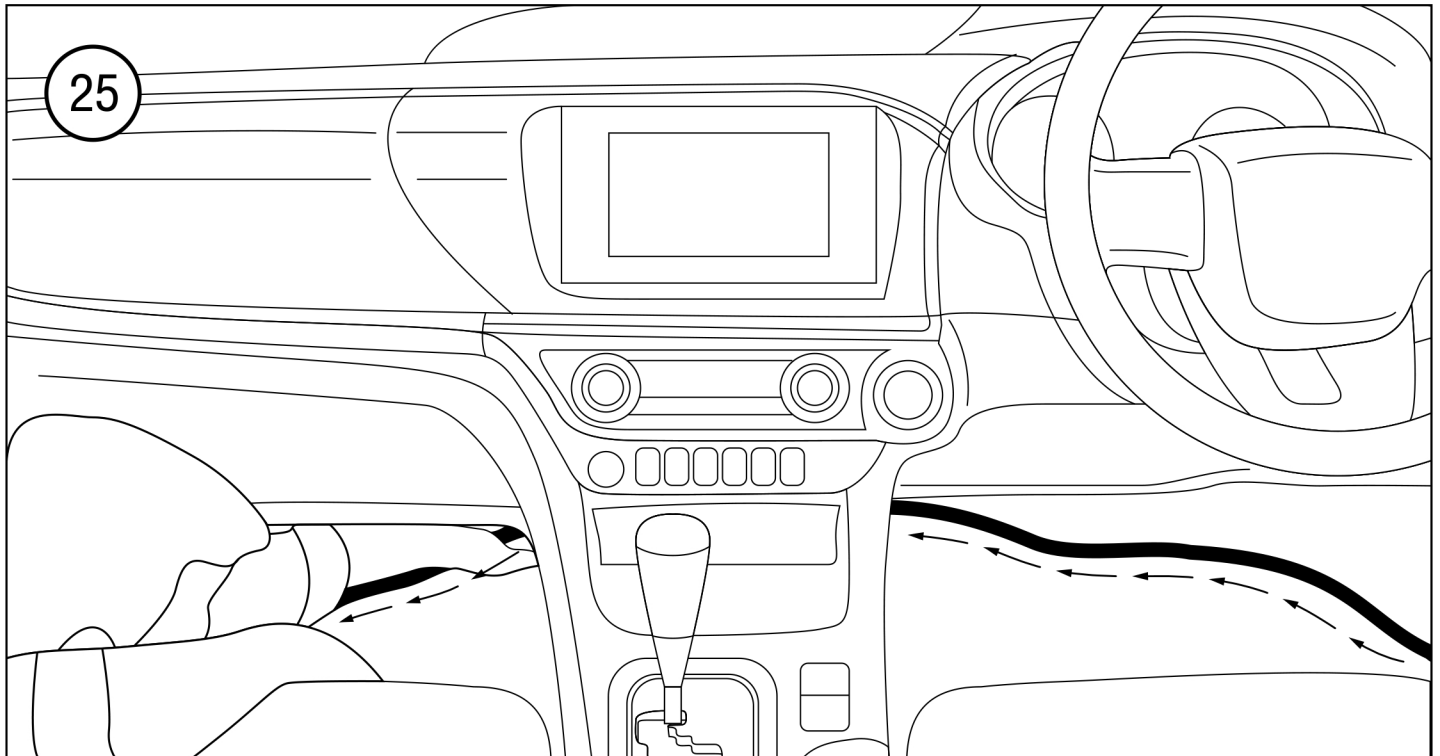

Running the wiring from the driver side through the passenger side as shown in picture.

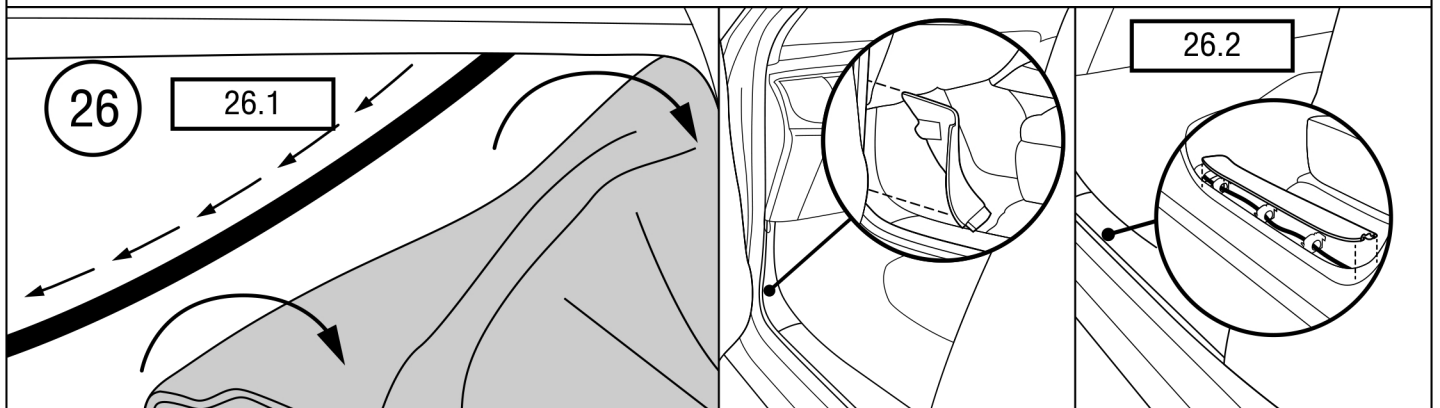

Take off the vehicle rubber pad in order to keep/hide the wiring.

Take off the cover at the passenger position side in order to check the Defogger wiring of the vehicle.

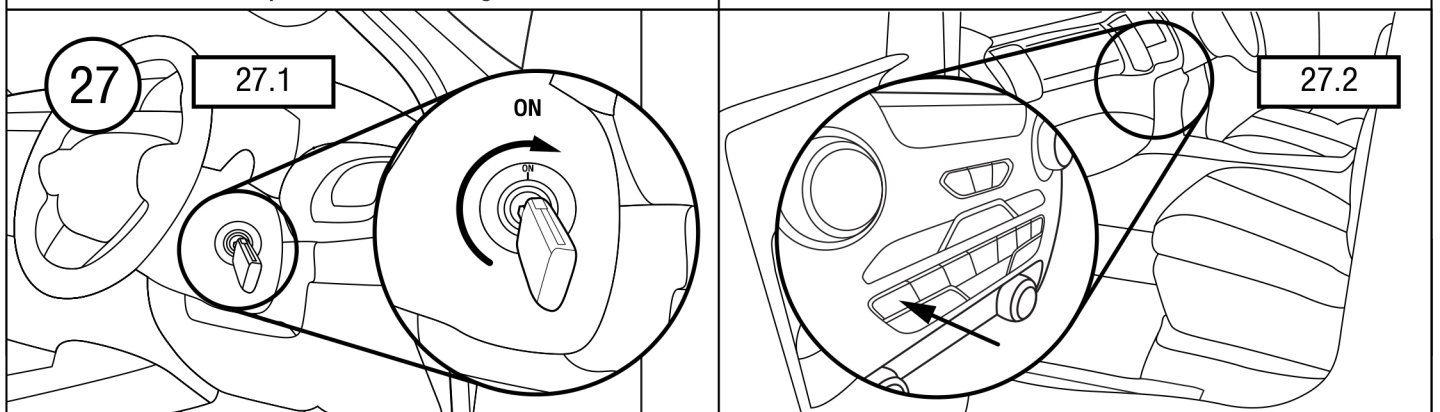

Checking the defogger system by turn ON and push the defogger button at the console pad.



<p>28</p> <p>28.1</p> <p>LIGHT ON</p>	<p>29</p> <p>29.1</p>
<p>From item 29 : Turn ON and push the defogger button at the console pad, After that check the defogger wiring at passenger position by using the Test Lamp kit, Light On means working.</p>	<p>Running the Harness Central Lock No.38 wiring along with the vehicle wiring by using the Cable Tie for tightening, then running the wiring into the vehicle structure hole.</p>
<p>28.2</p> <p>Defogger Wiring of Harness central Lock No.38</p> <p>Defogger Wiring of Car</p>	<p>29.2</p> <p>29.3</p>
<p>Connects the Blue Wiring (Defogger) of the Harness for Installation No.38 with the Black Wiring (Defogger) of the vehicle by using the Electro-tap.</p>	<p>Run the wiring into the rubber plug</p> <p>Seal around the rubber plug wiring hole in order to protect water leaking. Wait for 15 minutes until it's dry.</p>

## 30 The Step of wiring running diagram

**Point 1** Wiring running from driver side through passenger side.

**Point 2** Running canopy wiring via vehicle wiring hole/pipe along under the chassis.

**Point 3** Wiring that run under vehicle along the chassis.

**Point 4** Wiring that run via chassis at the fender area.

**Point 5** Wiring that running up the rear light in order to connect with the other wiring set.

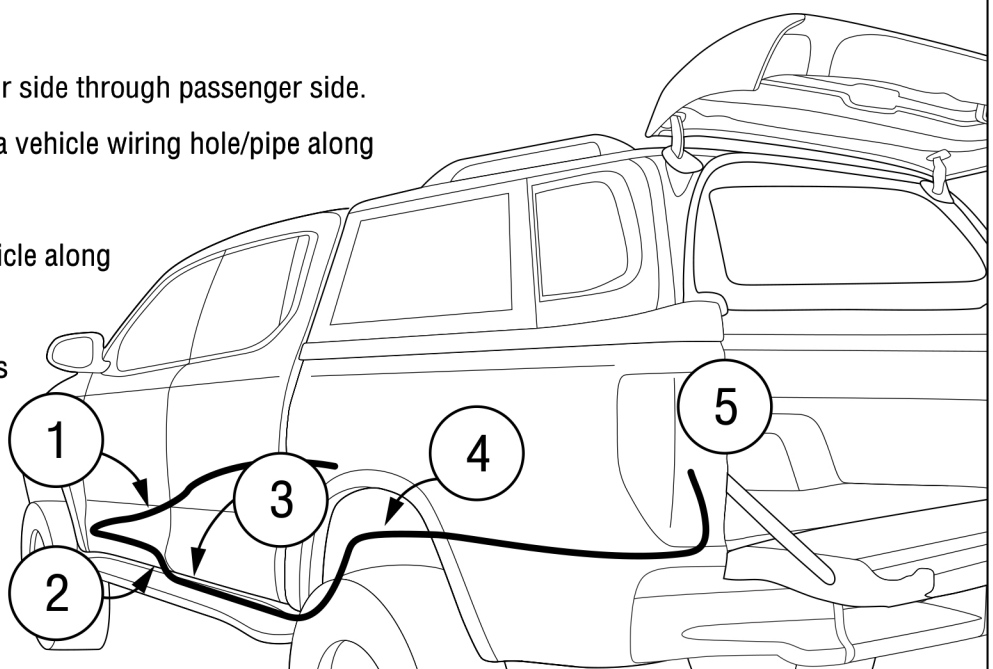

The Step of wiring running diagram for the Harness Central Lock No.38



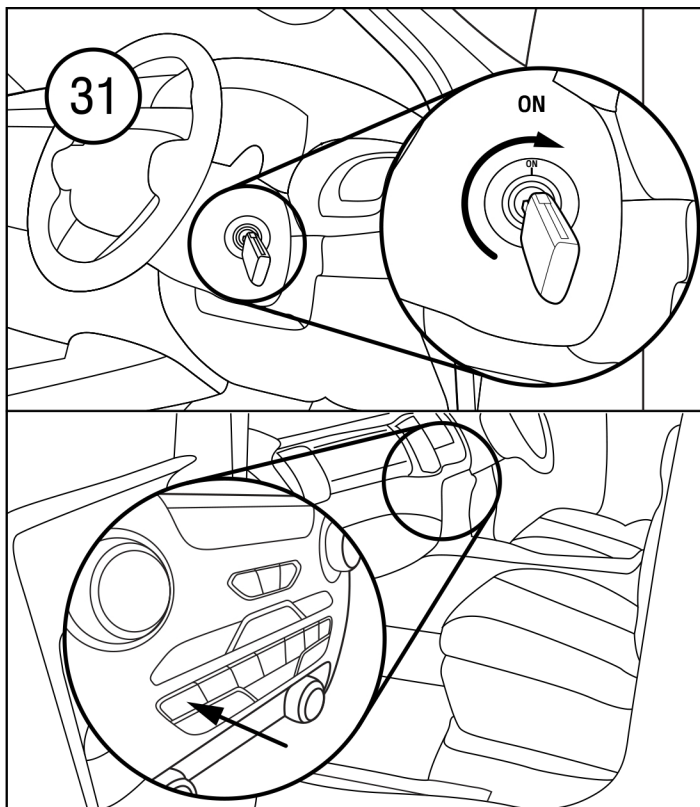

Checking the defogger system by turn ON and push the defogger button at the console pad.

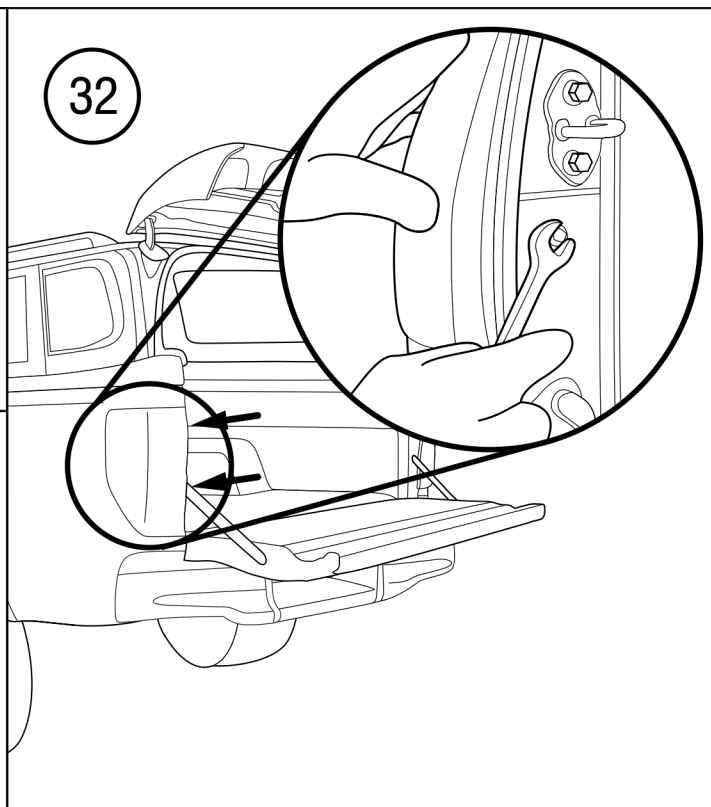

Take off the Rear Light by using wrench No.10

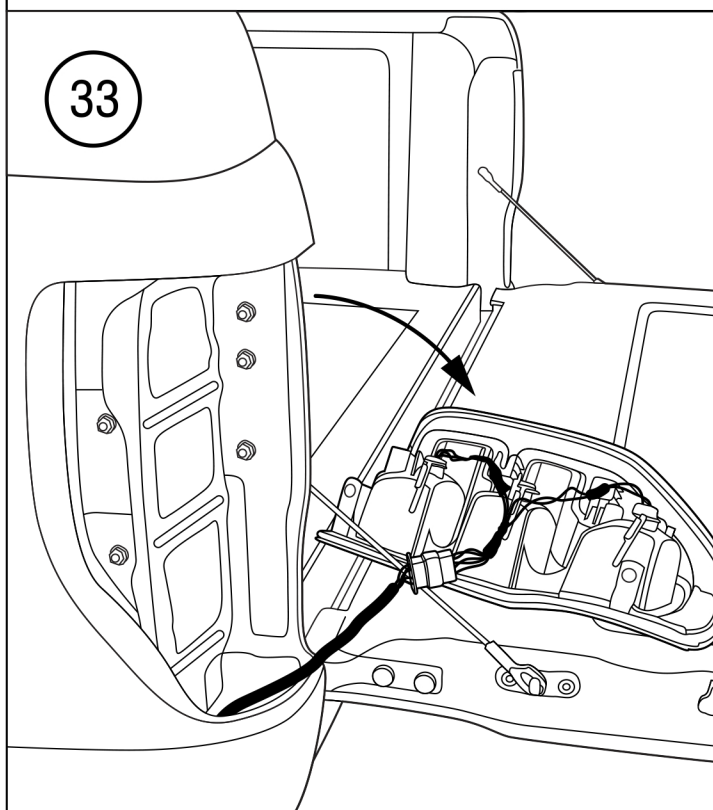

Take off the Rear Light vehicle.

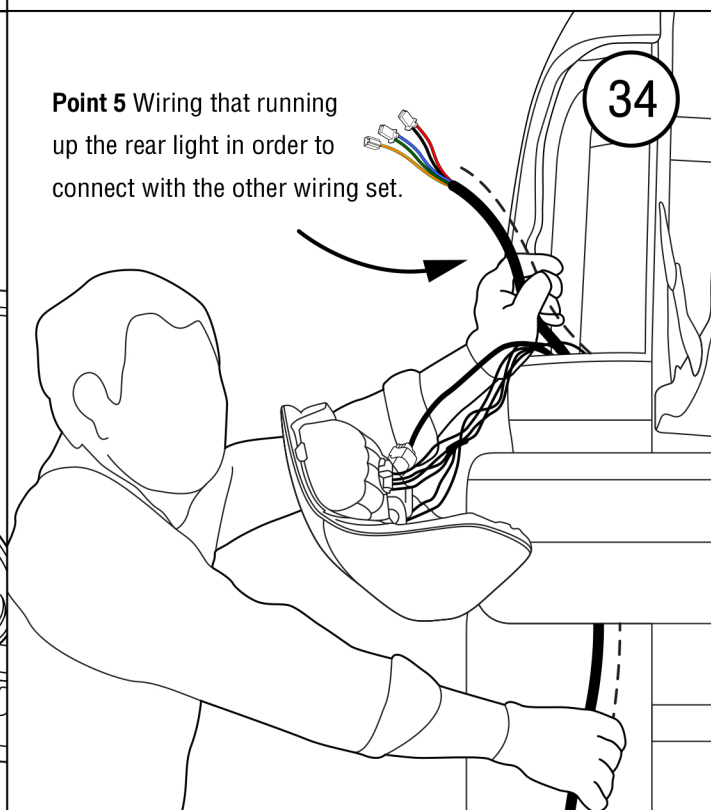

**Point 5** Wiring that running up the rear light in order to connect with the other wiring set.

Running the Harness Central Lock No.38 up to the vehicle rear light in order to connects with the Harness Central Lock No.33.

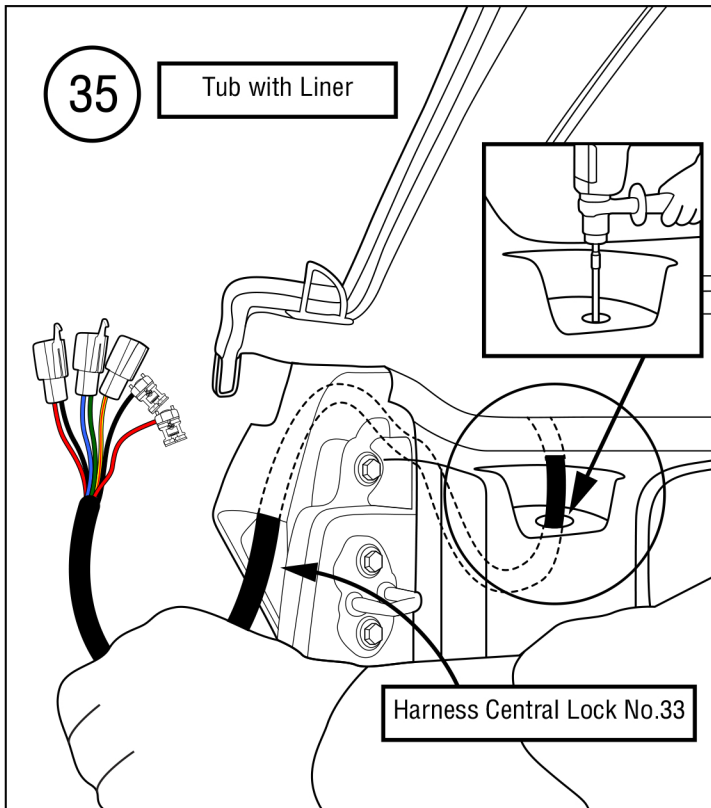

Punch the hole at the liner around 16 mm. in order to run the Harness Central Lock No.33 through the vehicle tub channel out of the Rear Light socket .

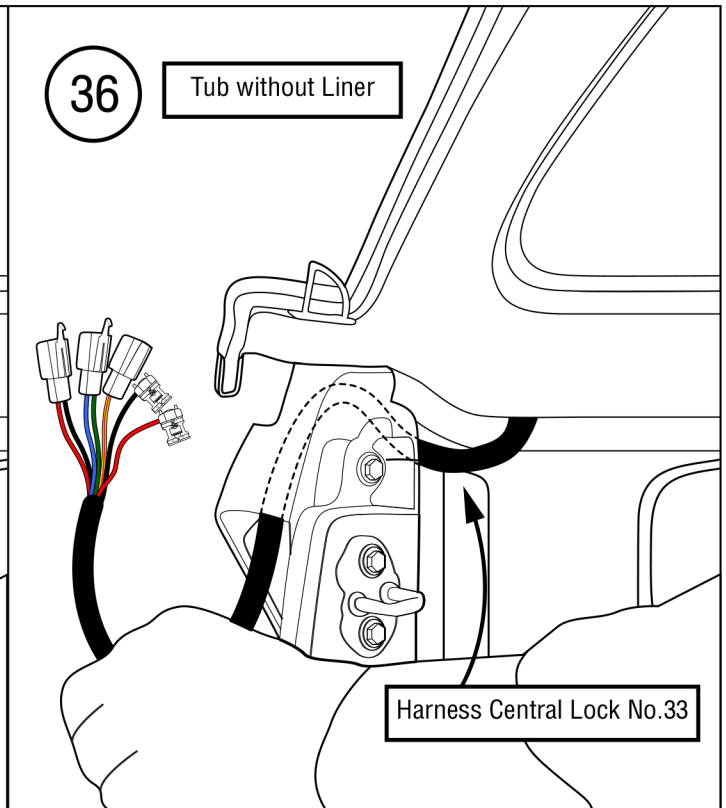

Run the Harness Central Lock No.33 along the vehicle tub channel out of the Rear Light Socket.

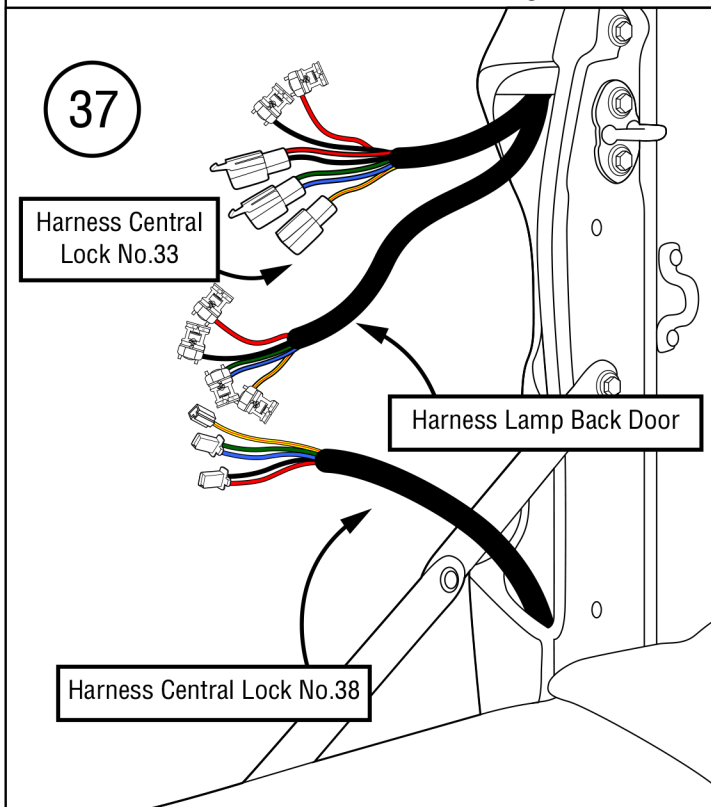

The Harness Central Lock No.33 , Harness Lamp Back Door wiring vehicle position and the Harness Central Lock No.38 wiring set.

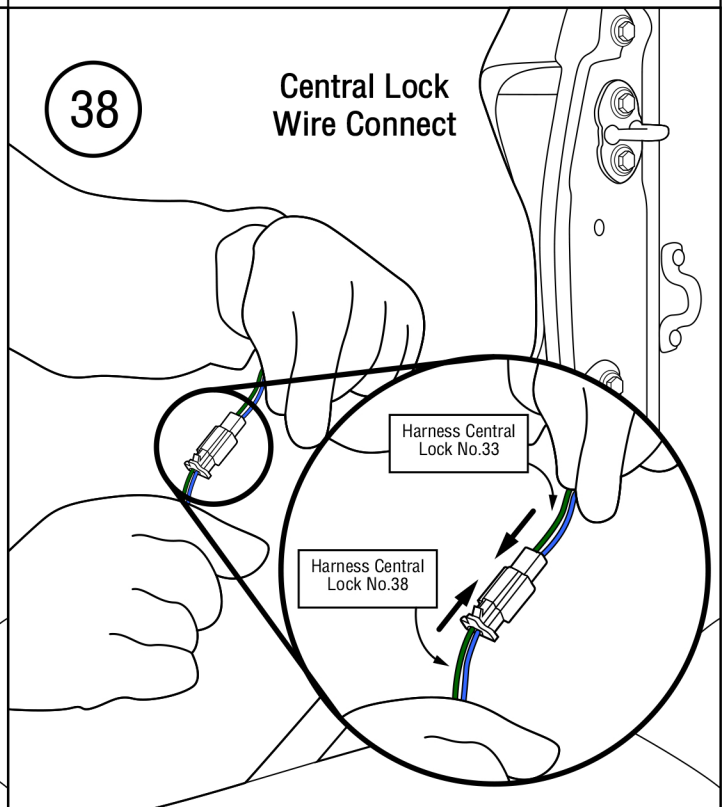

The process of connecting the Central Lock (BL,DG) wiring of the Harness Central Lock No.33 with the Central Lock (BL,DG) wiring of the Harness Central Lock No.38.

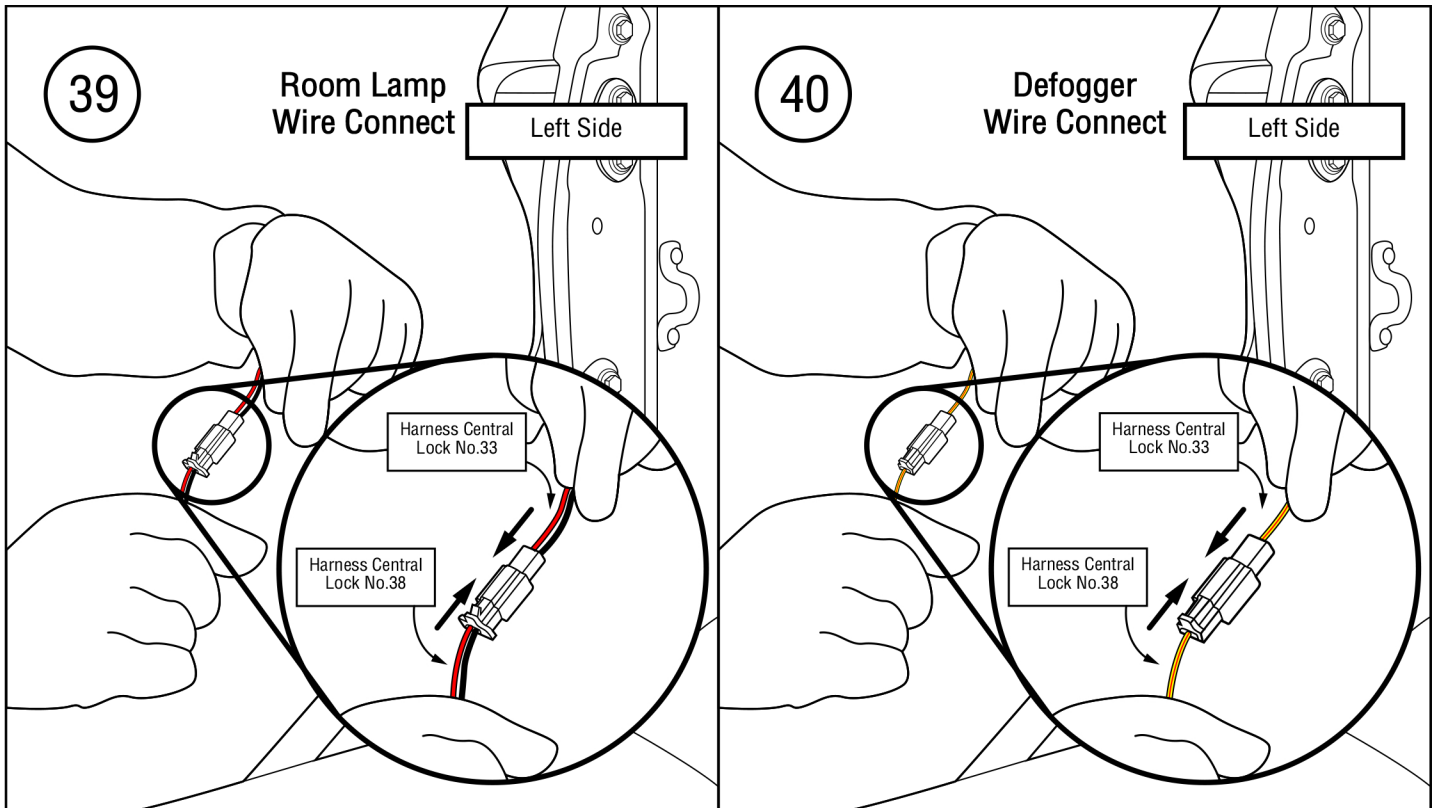

The process of connecting the Room Lamp (RD,BK) wiring of the Harness Central Lock No.33 with the Room Lam (RD,BK) wiring of the Harness Central Lock No.38.

The step of connecting the Defogger (YL/RD) wiring of the Harness Central Lock No.33 with the Defogger (YL/RD) wiring of the Harness Central Lock No.38.

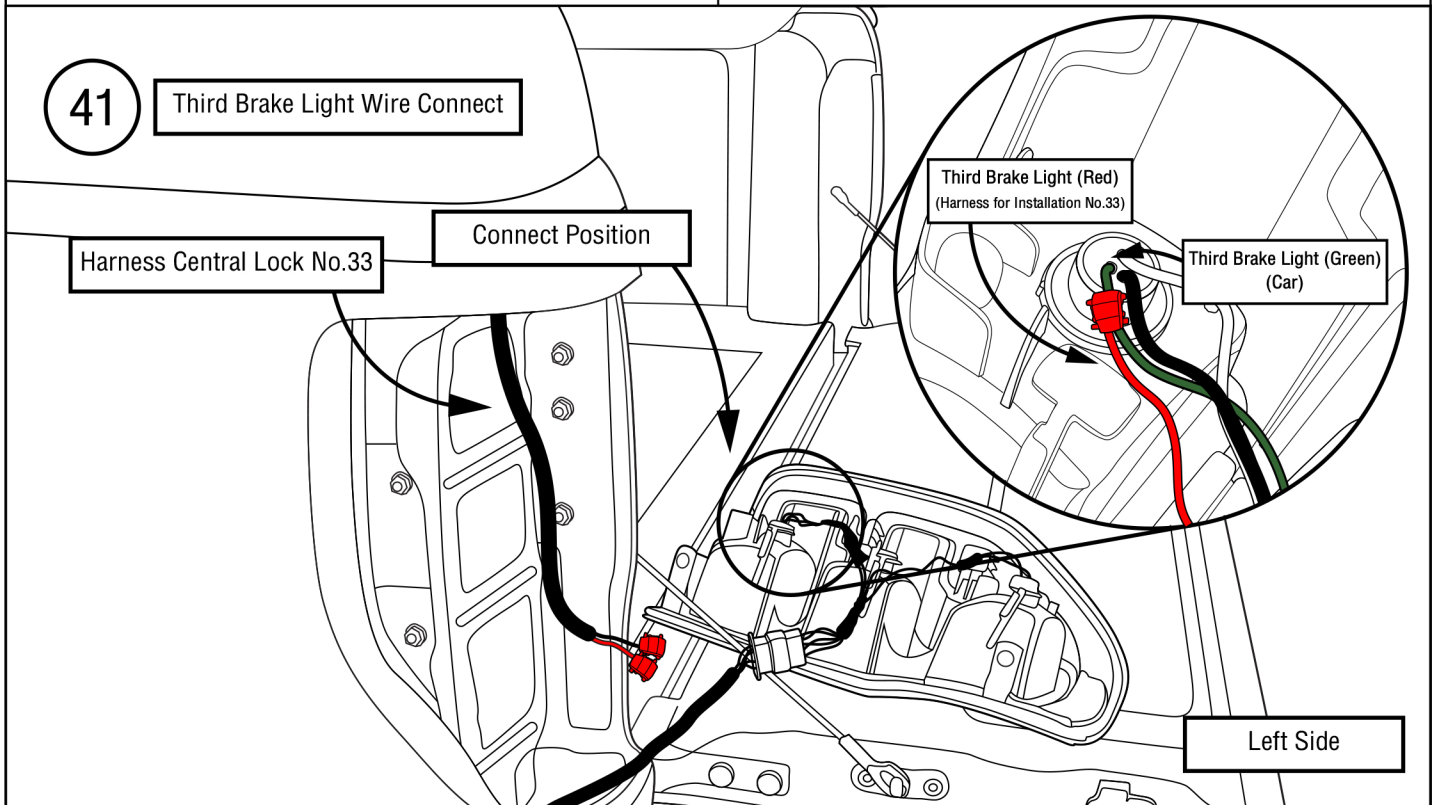

Bring the Red Wiring, Third Brake Light (RD) of the Harness Central Lock No.32 connecting with Light Green (LG) Brake wiring of the vehicle rear light.



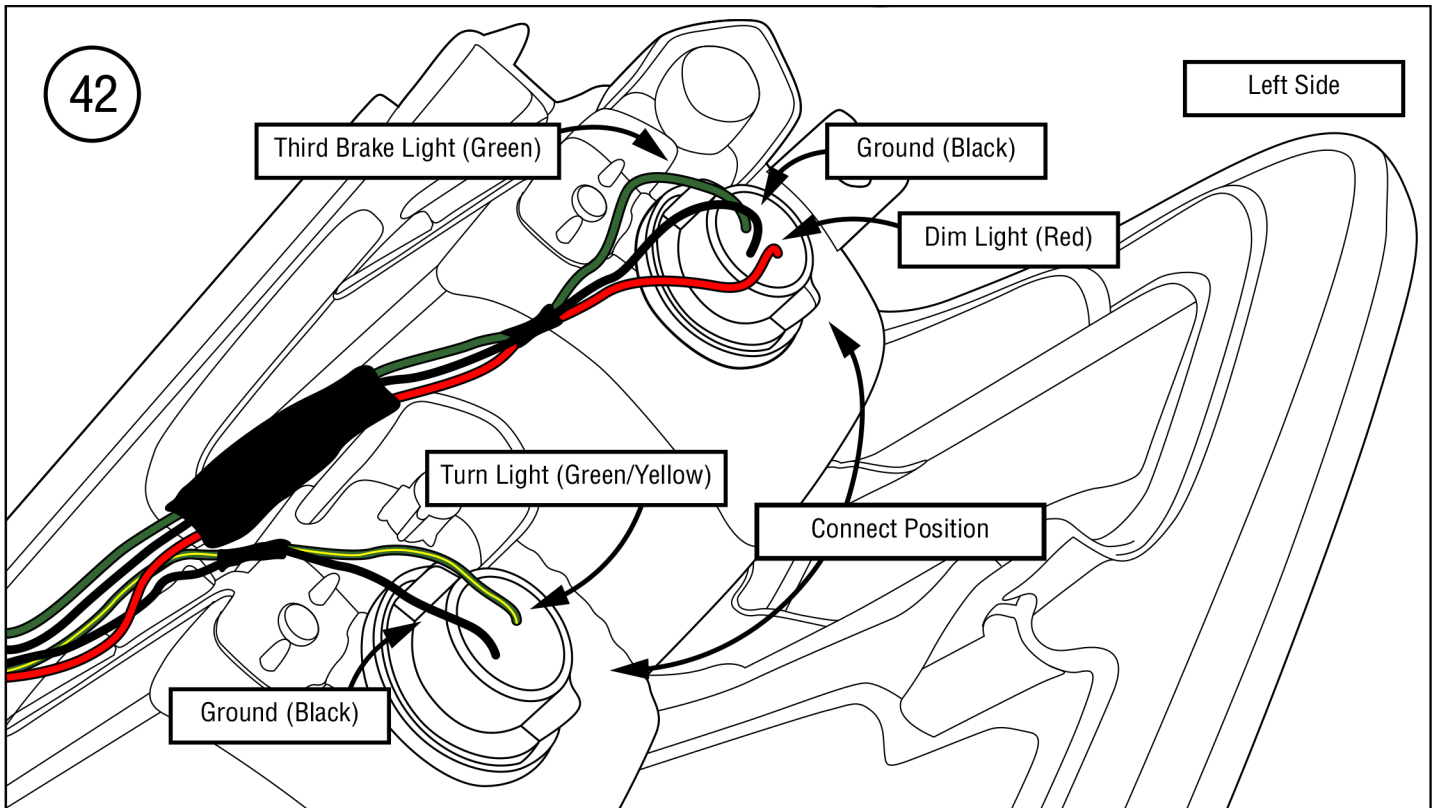

Third Brake Light , Brake Light , Dim Light , Turn Light and Ground of the vehicle wire connect position.

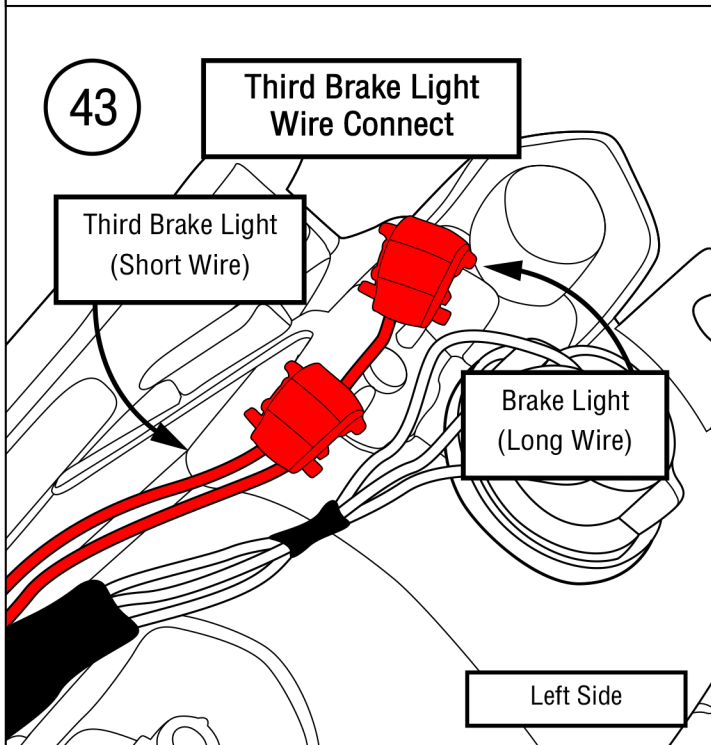

Bring the red wiring, Third Brake Light (Short wire) of the Harness Central Lock No.33 connecting with Brake Light (Long wire) of the Harness Central Lock No.33

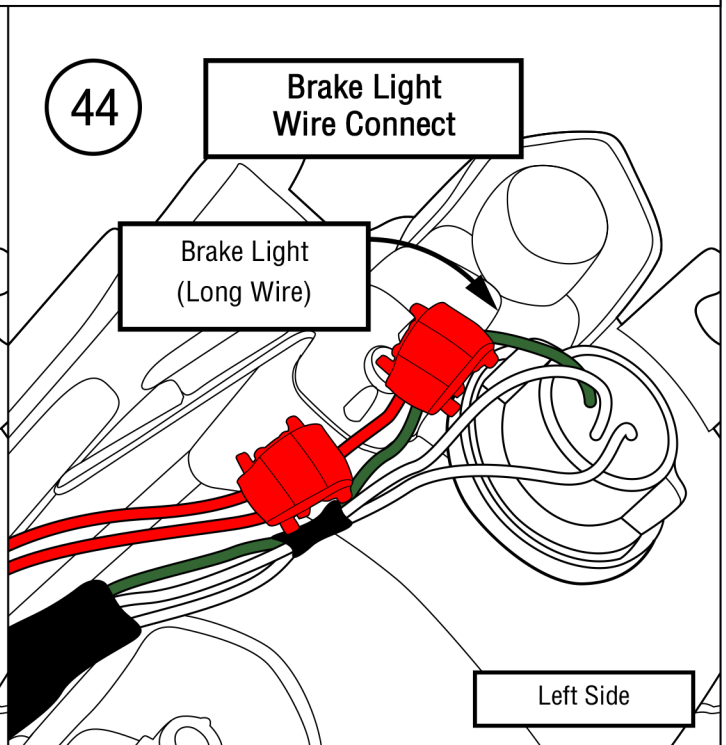

After finish the installation step no.43 Bring the Red Wiring, Brake wiring (Long wire) of the Harness Central Lock No.40 connecting with the wiring (Green wire) of the vehicle.

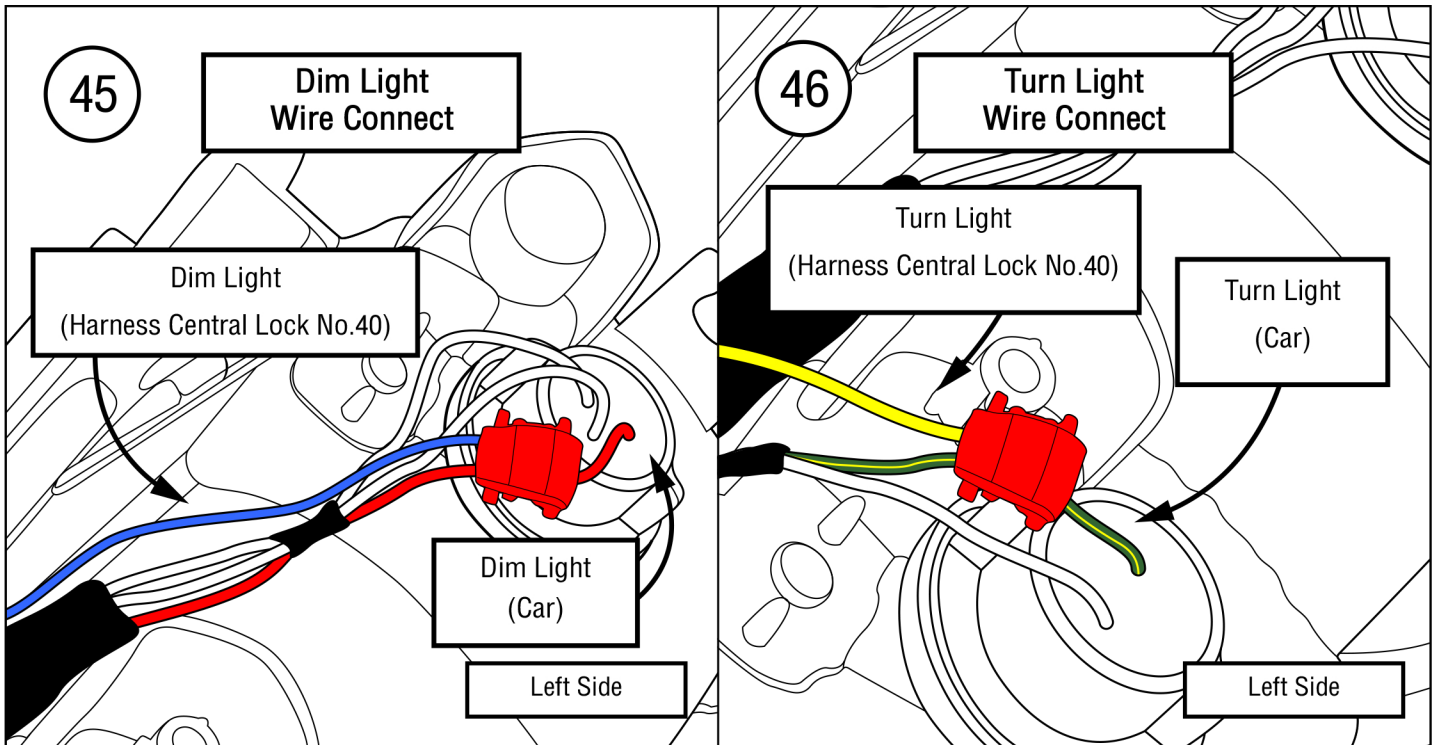

Bring the blue wiring, Dimlight of the Harness Central Lock No.40 connecting with Dimlight of the vehicle (red wiring).

Bring the yellow Wiring, Turn light wiring (YL) of the Harness Central Lock No.40 connecting with Turn Light wiring of the vehicle green/yellow wire (GN/YL).

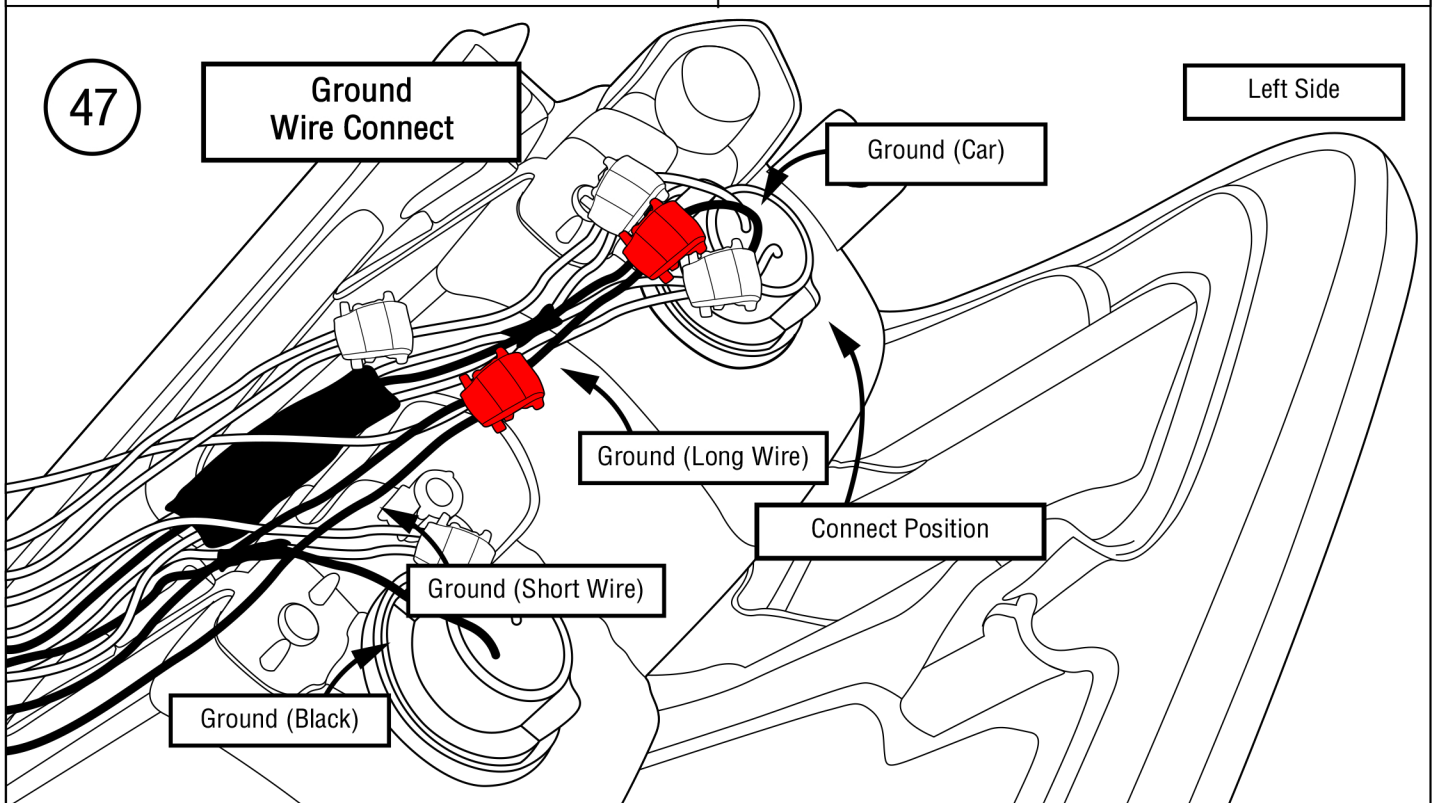

Bring the Black Wiring, GROUND (Short wire) and GROUND (Long wire) of the Harness Central Lock No.40 connecting with the Black (BK) Ground wiring of the vehicle rear light.



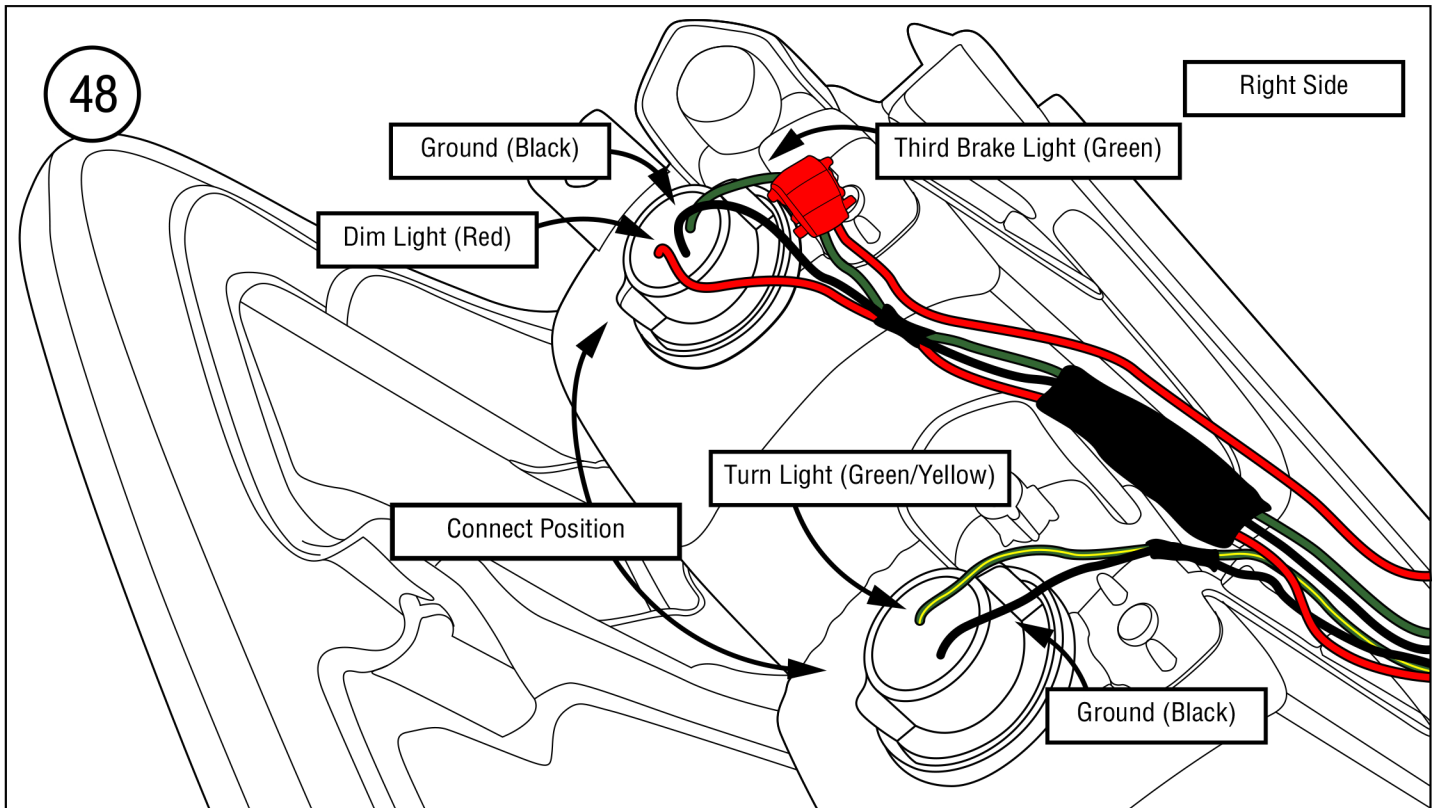

Third Brake Light , Brake Light , Dim Light , Turn Light and Ground of the vehicle wire connect position.

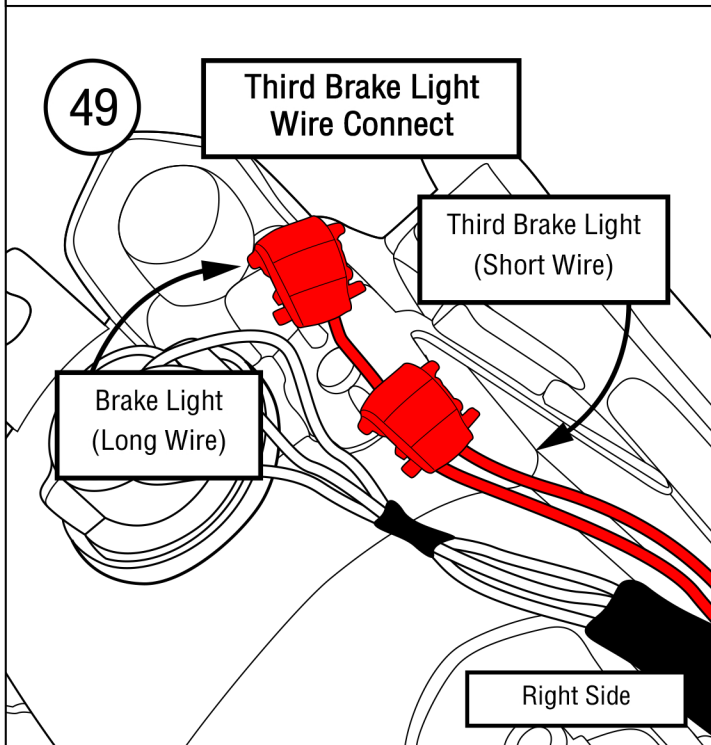

Bring the red wiring, Third Brake Light (Short wire) of the Harness Central Lock No.40 connecting with Brake Light (Long wire) of the Harness Central Lock No.40.

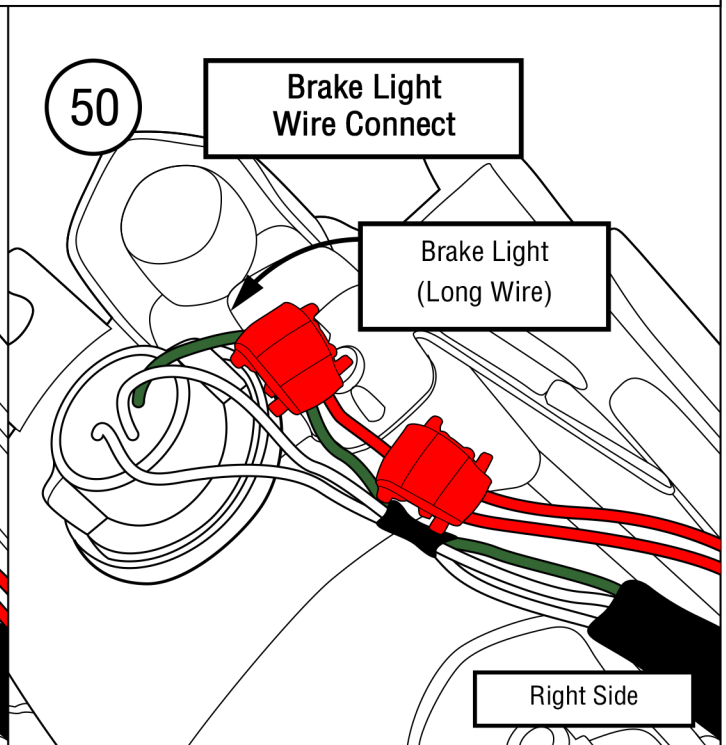

After finish the installation step no.49 Bring the Red Wiring, Brake wiring (Long wire) of the Harness Central Lock No.40 connecting with the wiring (Green wire) of the vehicle.

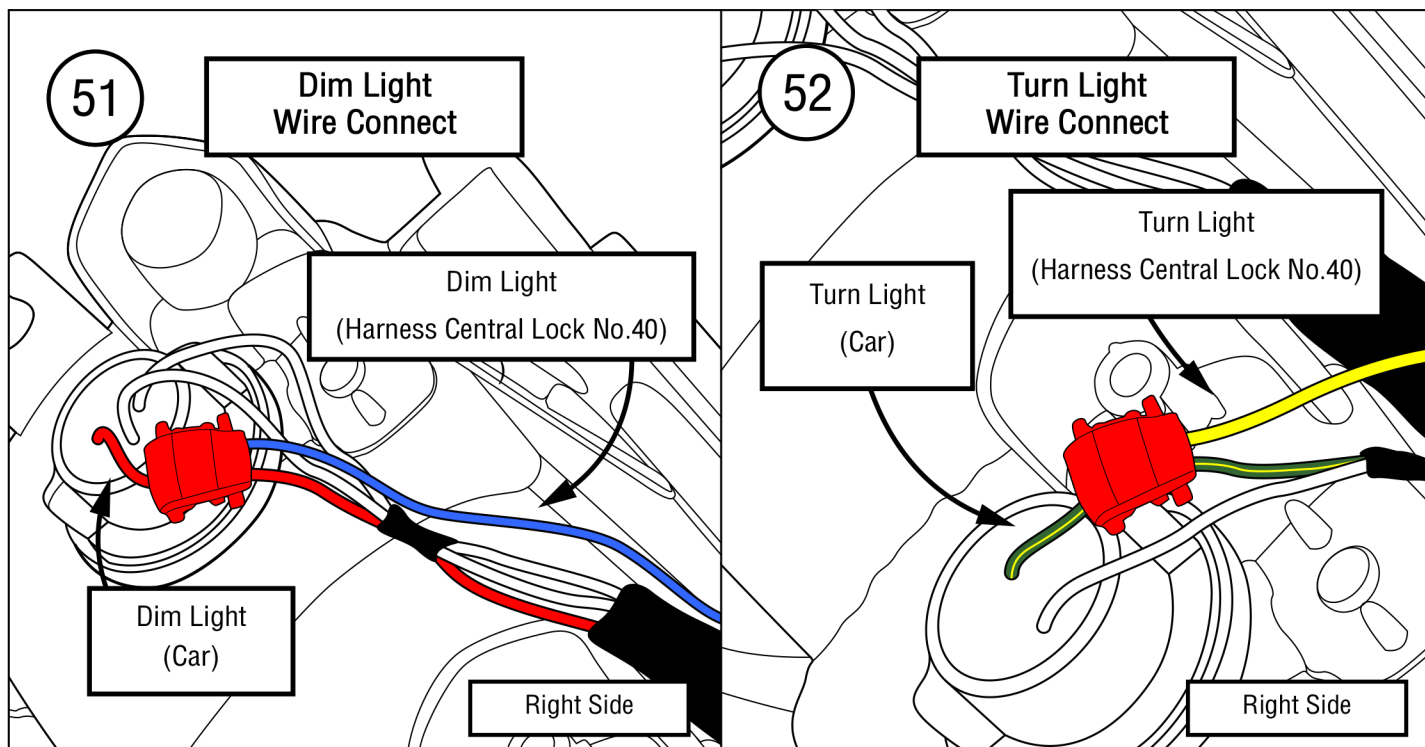

Bring the blue wiring, Dimlight of the Harness Central Lock No.40 connecting with Dimlight of the vehicle (red wiring).

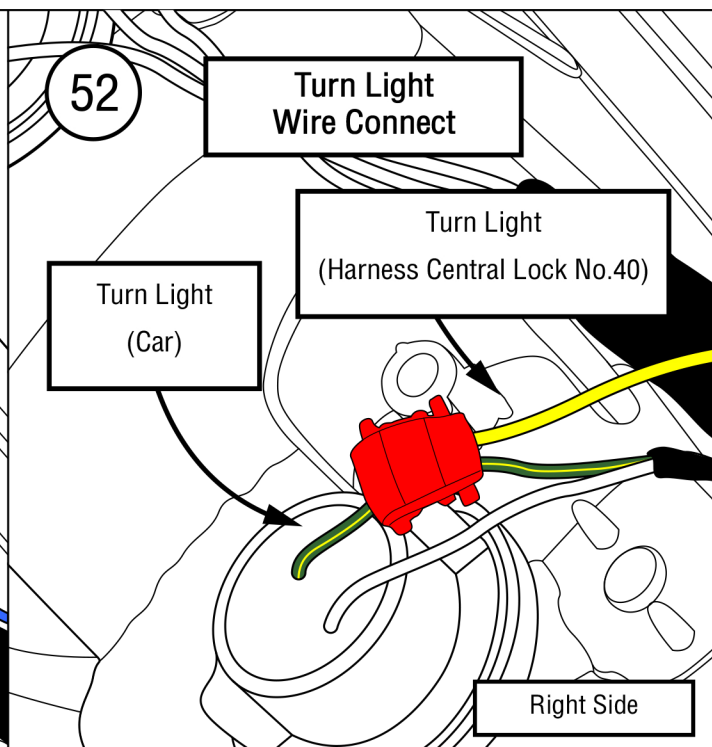

Bring the yellow Wiring, Turn light wiring (YL) of the Harness Central Lock No.40 connecting with Turn Light wiring of the vehicle green/yellow wire (GN/YL).

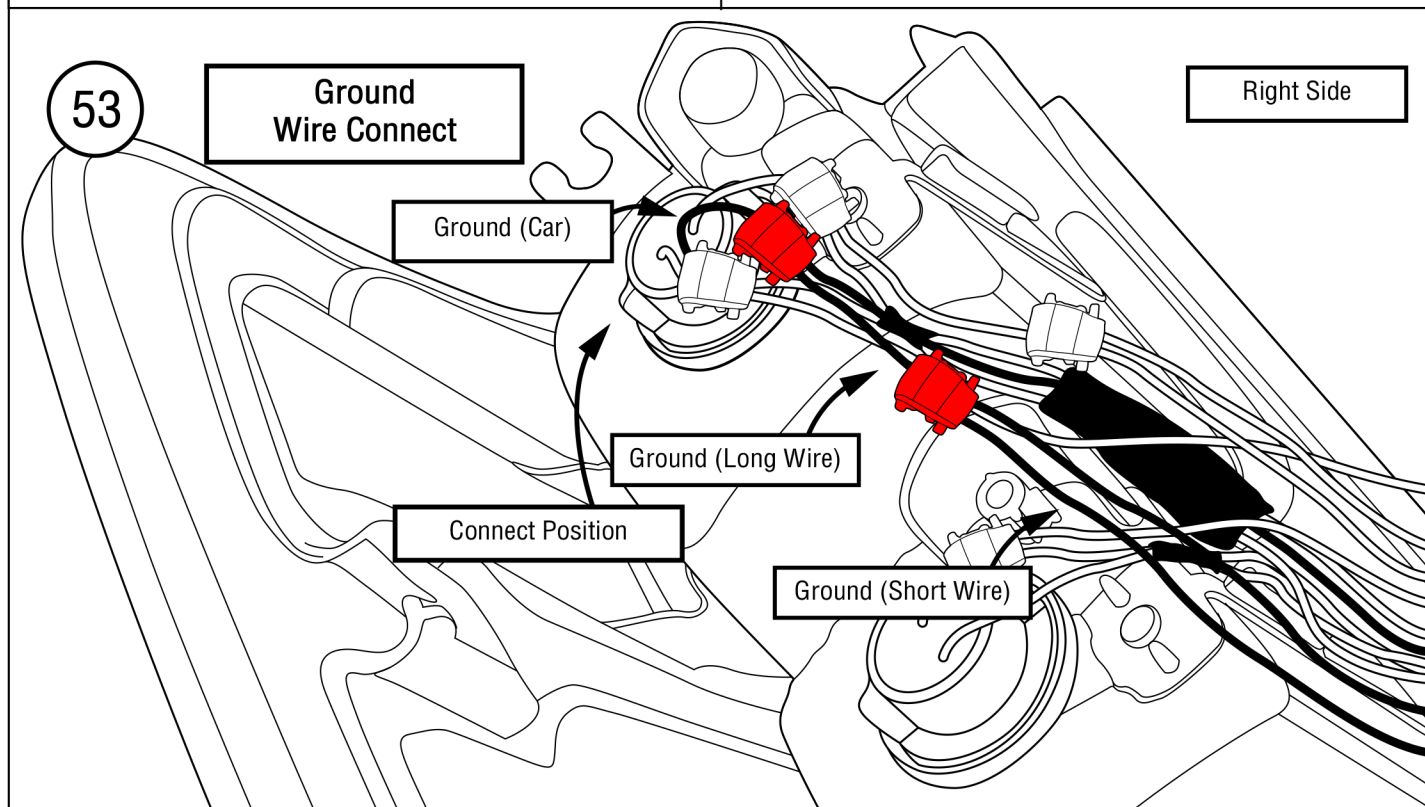

Bring the Black Wiring, GROUND (Short wire) and GROUND (Long wire) of the Harness Central Lock No.40 connecting with the Black (BK) Ground wiring of the vehicle rear light.



54

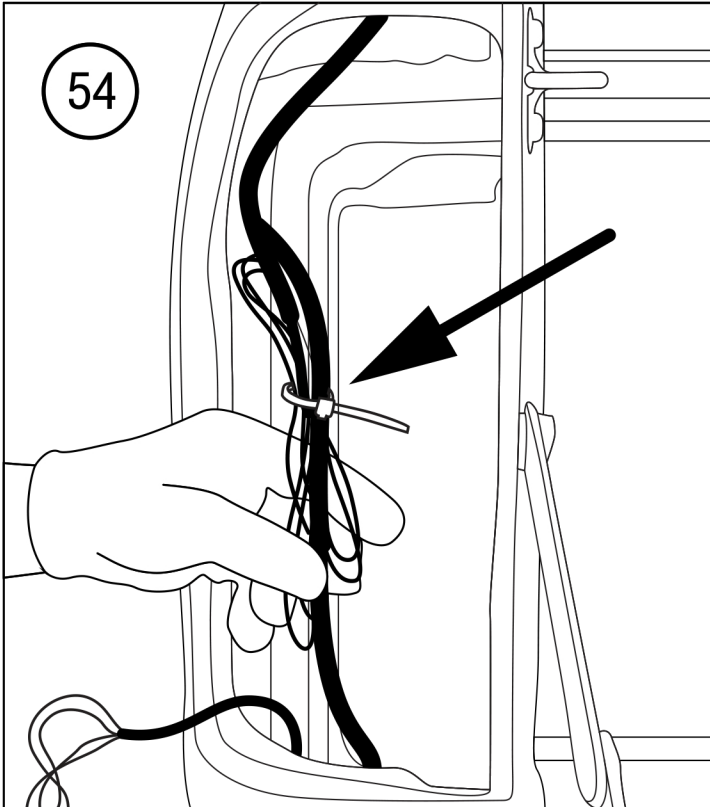

Tight up all the wiring by using the Cable Tie

55

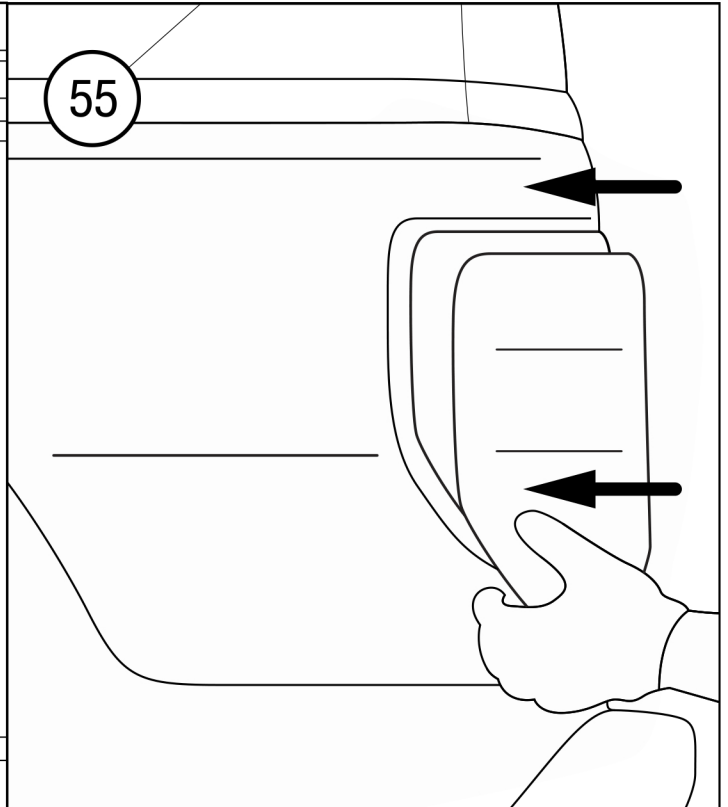

Reassemble the vehicle rear light.

56

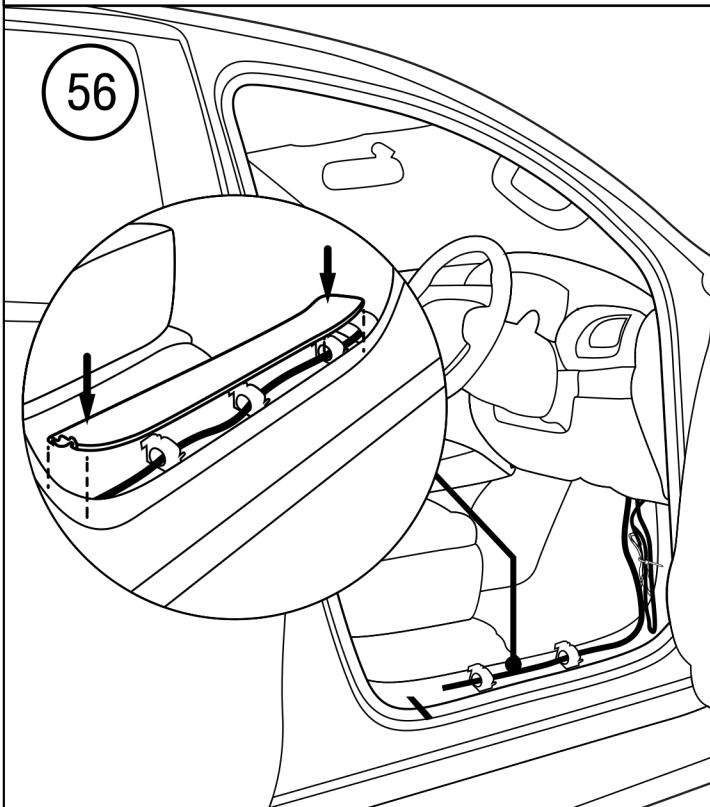

Tight up the wiring at the driver side by using the Cable Tie, then close the vehicle cover.



48

Check the Central Lock / Room Lamp working.

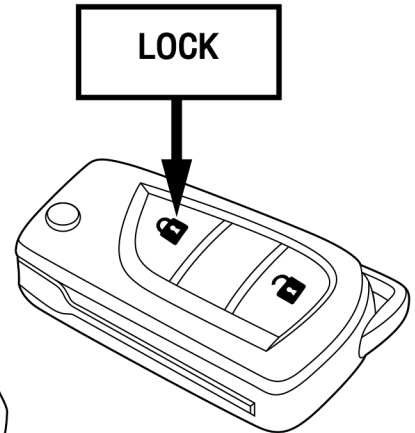
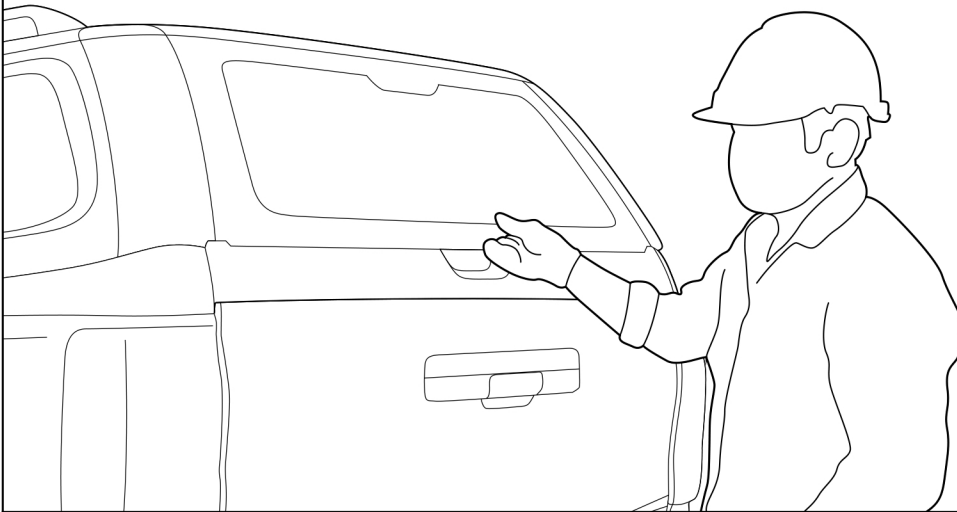

Central Lock checking by pressing the vehicle remote key at the Lock position, Canopy will be lock and cannot open.

49

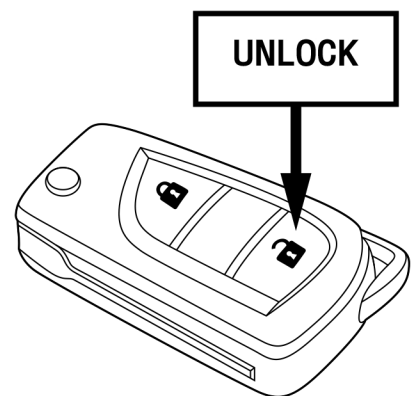
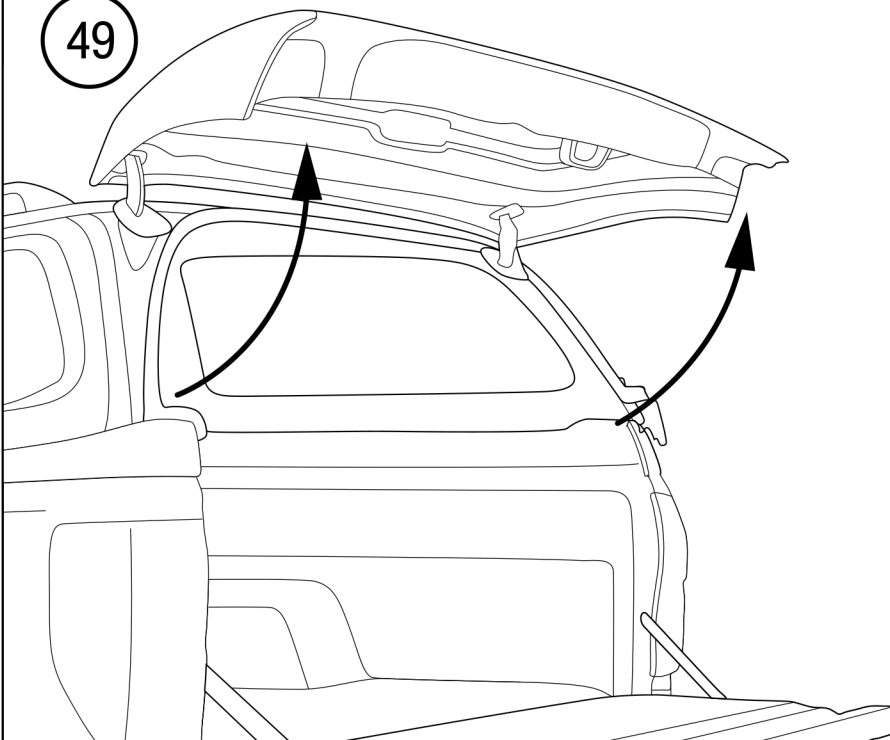

Central Lock checking by pressing the vehicle remote key at the Unlock position, Canopy will be open.





50

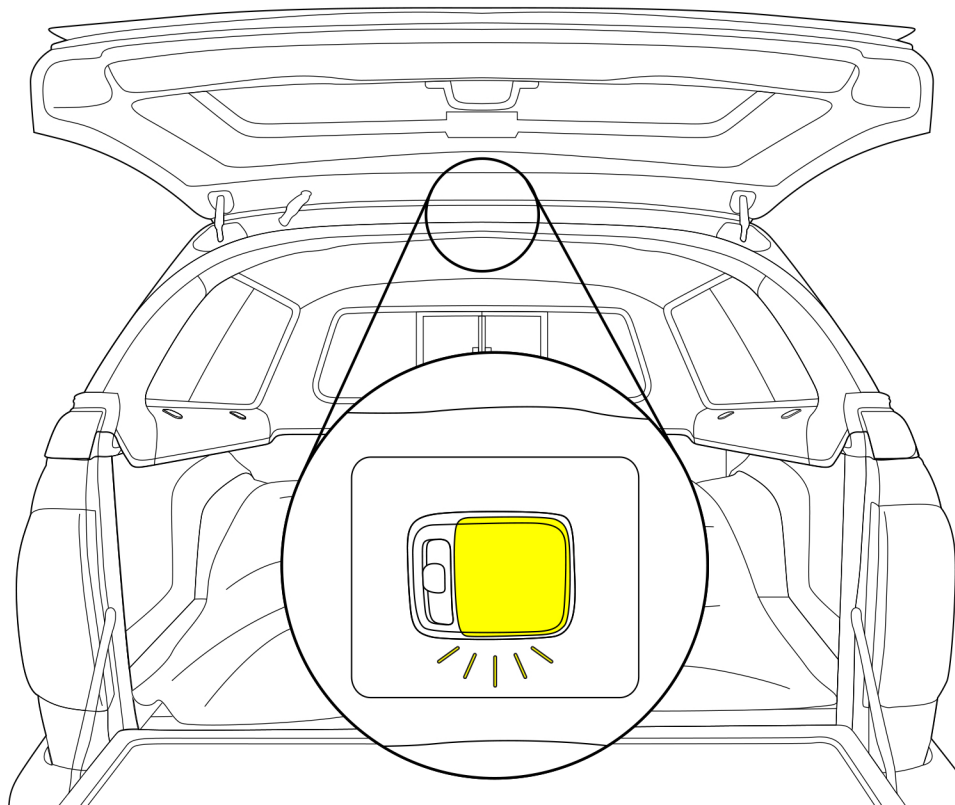

Room Lamp checking by opening the rear door then the Room Lamp will be on.

51

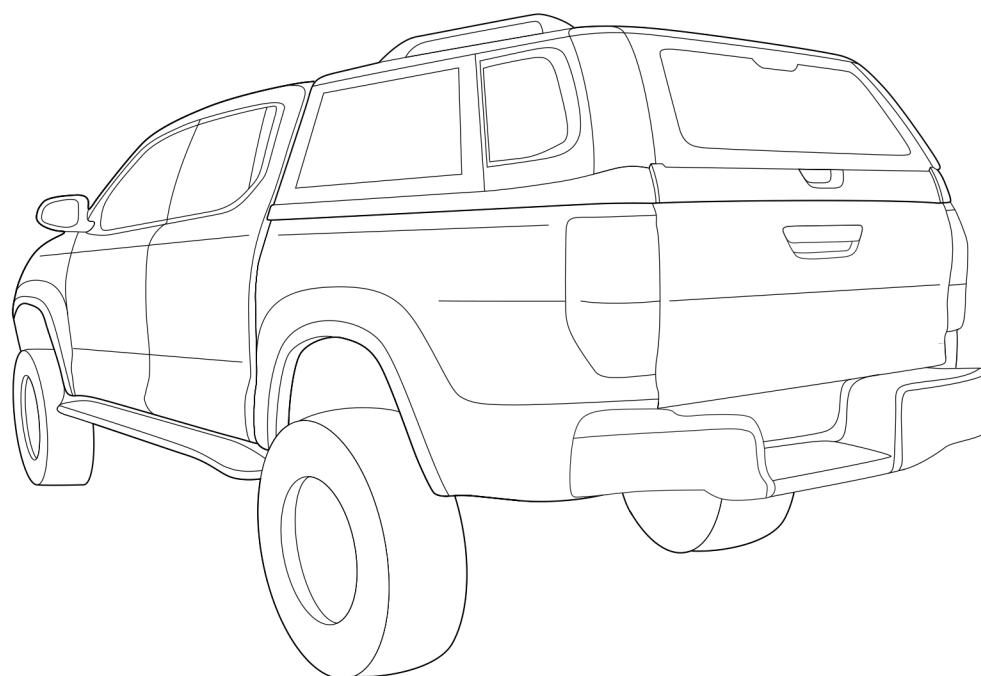

The process of canopy Electrical Installation is completed.